

EXISTING BLOCK PLAN

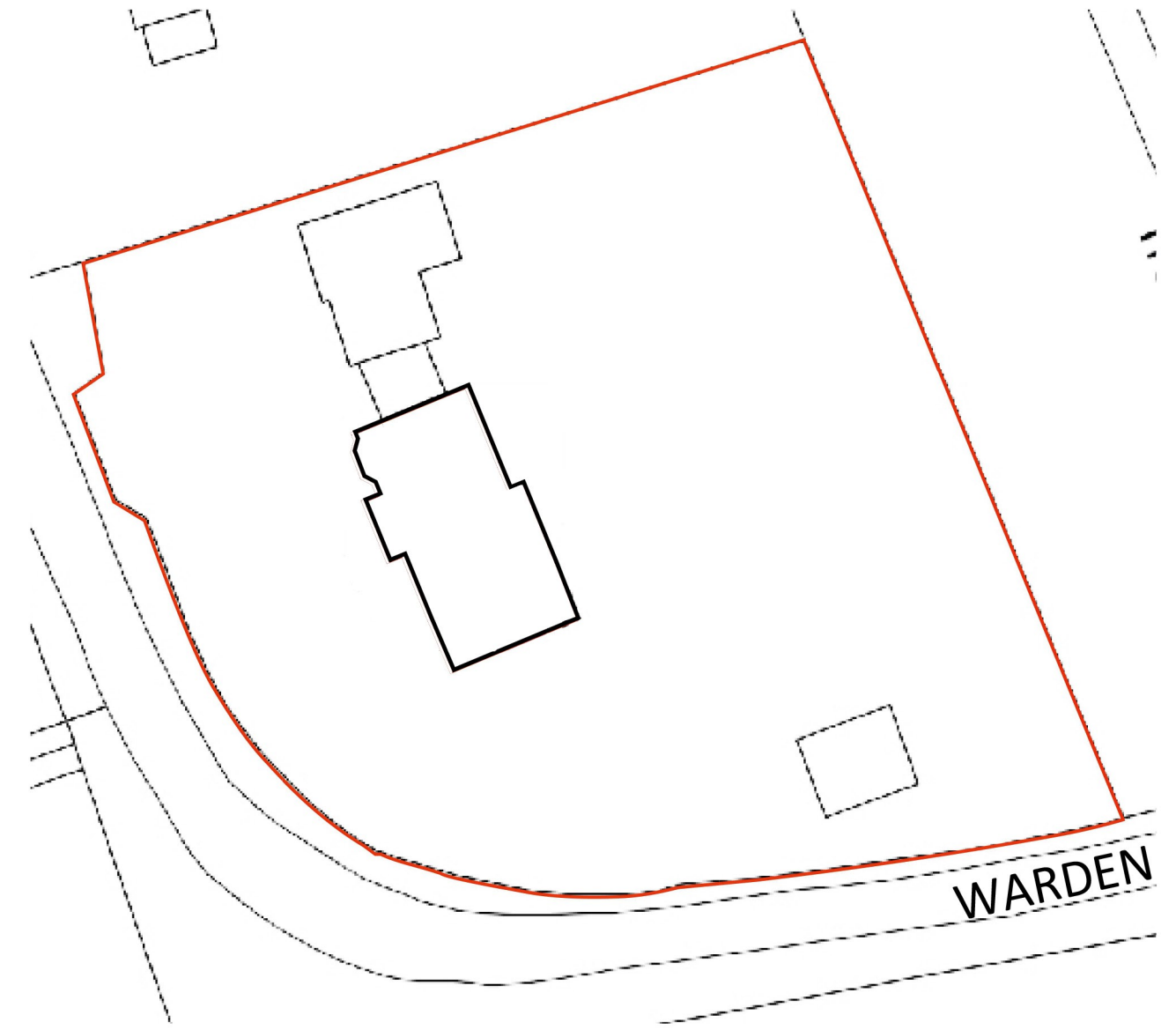

PROPOSED BLOCK PLAN

**PLANNING**

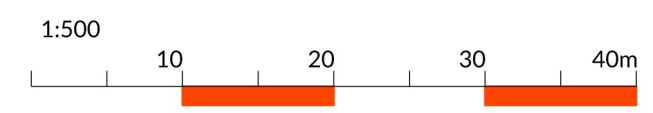

**23.89.PL03**

**SINGLE STOREY SIDE  
EXTENSION AND NEW DORMER**  
MIRAMAR, WARDEN ROAD,  
EASTCHURCH, ISLE OF SHEPPEY

**MR L MARSHALL**

**REFINE**  
ARCHITECTURE

Address : Unit 6, Grove Dairy Farm,  
Bobbing Hill, Sittingbourne, Kent, ME9 8NY

Telephone : 01795 844162

E-mail : mail@refinearchitecture.co.uk

Drawn By	Checked By	Date	Scale	Size	Revision
KS	JB	22/01/2024	1:500	A3	-

Do not scale from this drawing unless for Planning Purposes.  
ALL RELEVANT DIMENSIONS AND LEVELS TO BE ASCERTAINED OR CHECKED AND VERIFIED ON SITE BEFORE SPECIFIC AREAS OF WORK ARE COMMENCED.  
All errors or discrepancies must be reported to the designer or contract administrator immediately on discovery. This drawing remains the sole copyright of REFINE ARCHITECTURE until such time as an assignable licence is granted.

**EXISTING AND PROPOSED BLOCK PLANS**