



NOTES:  
1. This drawing is based on a topographical survey produced by Hook Survey Partnership referenced S20/7602/01 and dated May 2020.

**KEY**  
 Existing double yellow lines parking restriction.  
 Body outline of the vehicle.  
 Wheel outline of the vehicle.

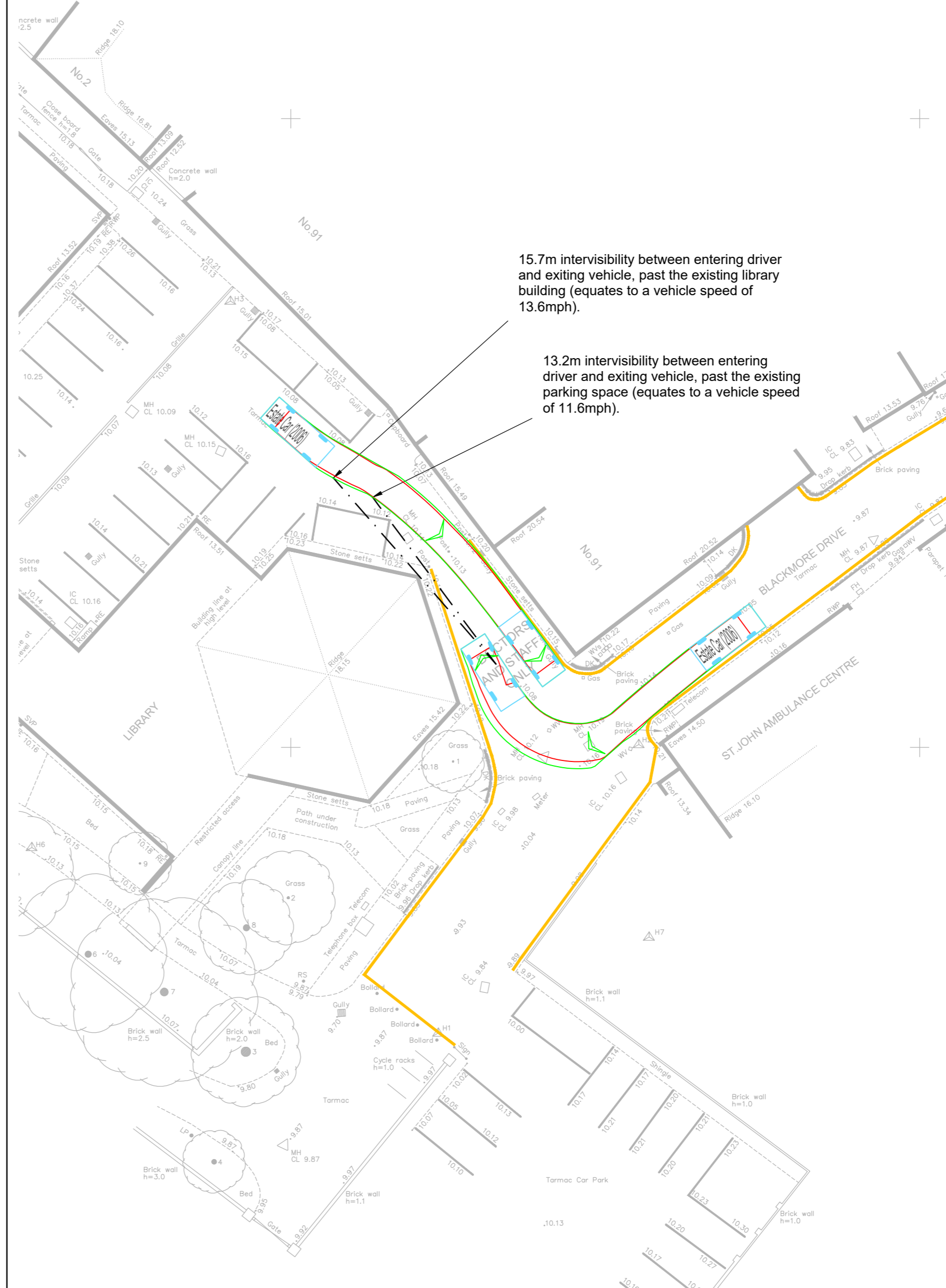
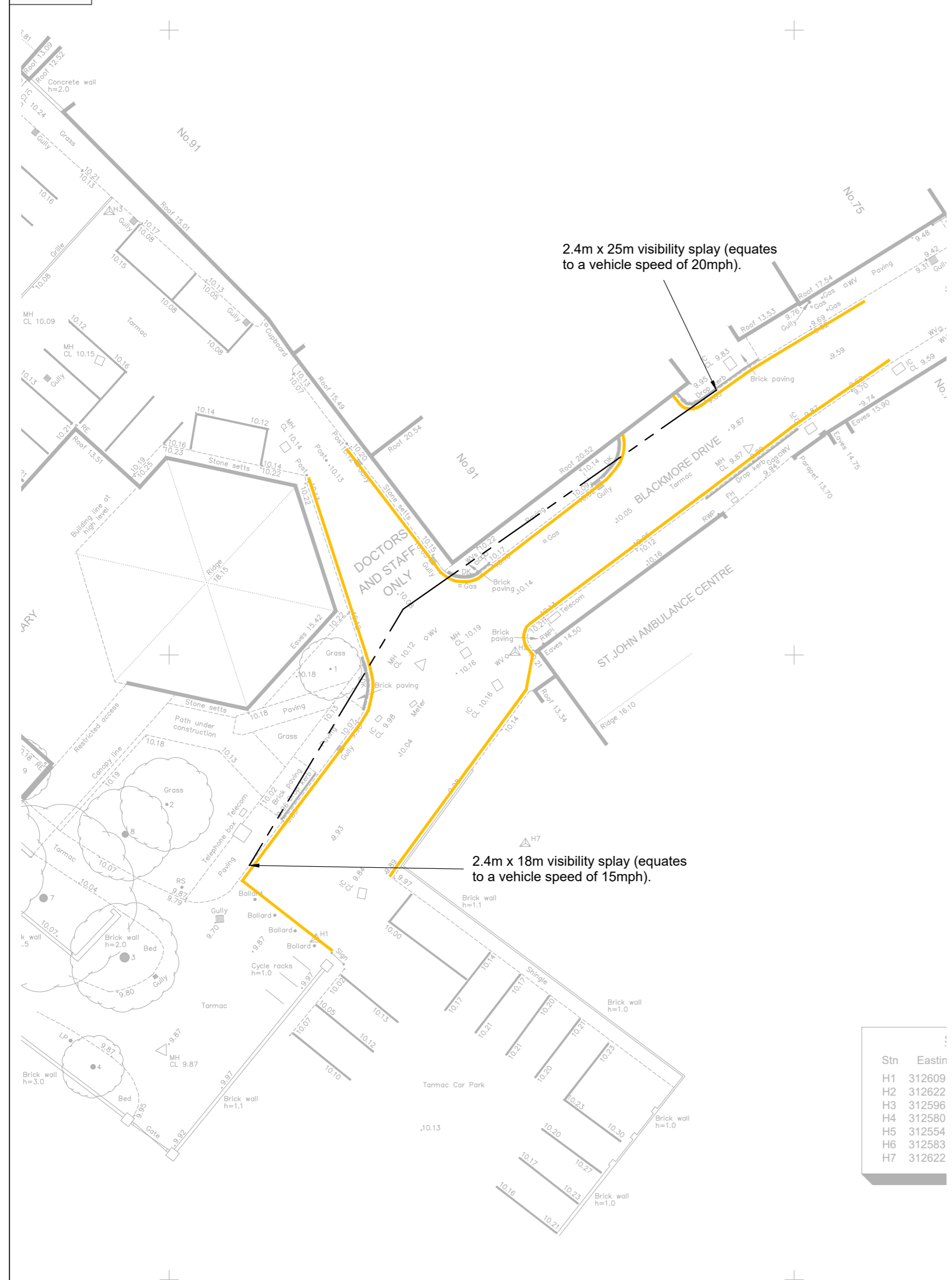

Stn	Eastin
H1	312609
H2	312622
H3	312596
H4	312580
H5	312554
H6	312583
H7	312622

Rev	Date	Details	Drawn by	Checked by	Approved by

**Bristol**  
 Cambridge  
 London  
 Oxford  
 Welwyn Garden City



25 King Street  
 Bristol  
 BS1 4PB  
 0117 925 9400  
[www.tpa.uk.com](http://www.tpa.uk.com)

CLIENT:  
**NHS PROPERTY SERVICES LIMITED**

PROJECT:  
**SIDMOUTH HEALTH CENTRE, BLACKMOOR DRIVE, SIDMOUTH**

TITLE:  
**Existing Access Arrangement and Swept Paths Of An Estate car**

STATUS:  
**FOR INFORMATION**

SCALE:	DATE:	DRAWN:	CHECKED:	APPROVED:
1:250	27.09.23	PSW	STM	JD
JOB NO:	DRAWING NO:		REVISION:	
2309-002	SK01			

**Existing Junction Arrangement and Visibility Splays**

**Intervisibility Between Two Cars Passing At Existing Site Access**

