

Tree Constraints Plan

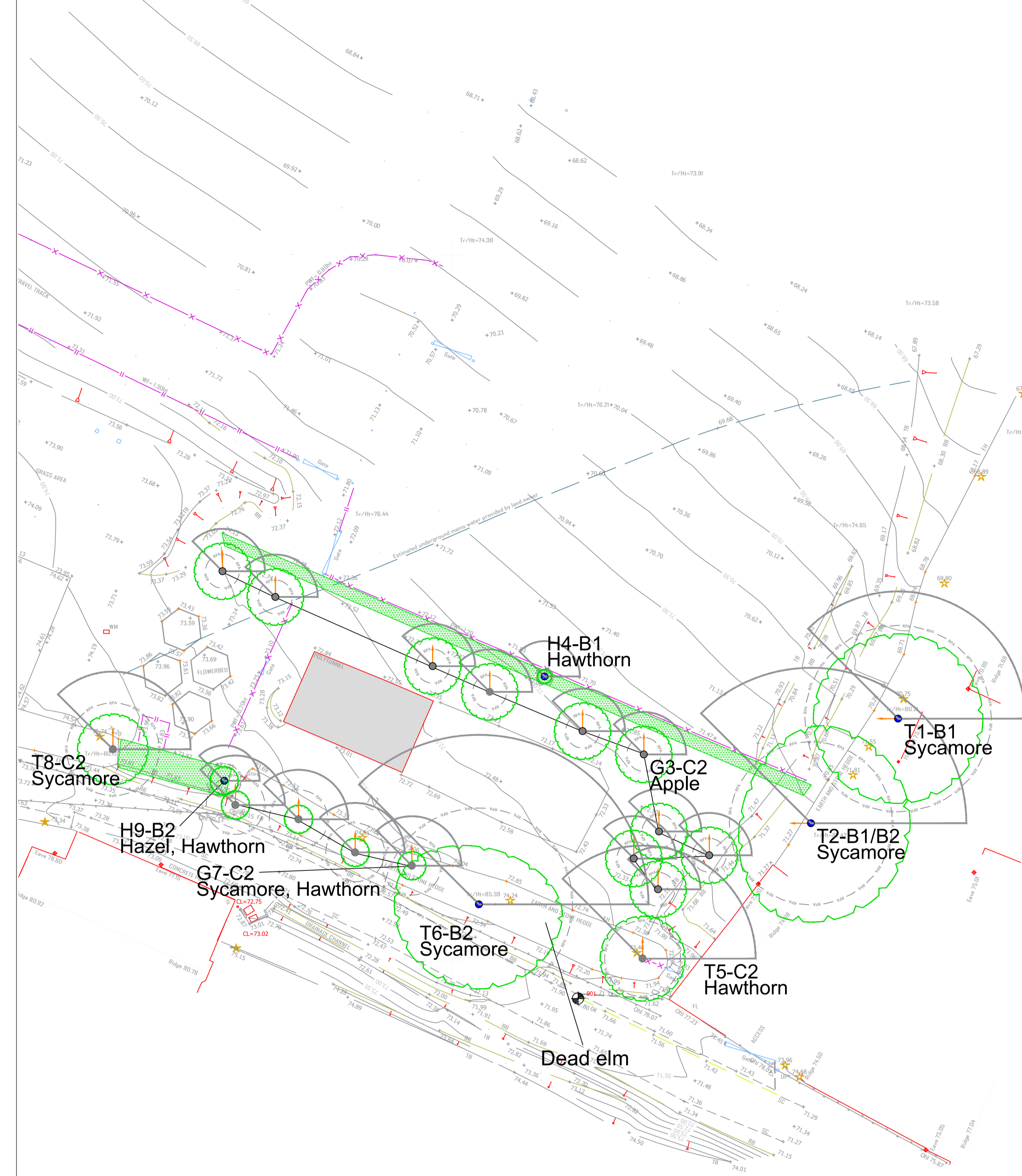

Tree Protection Plan

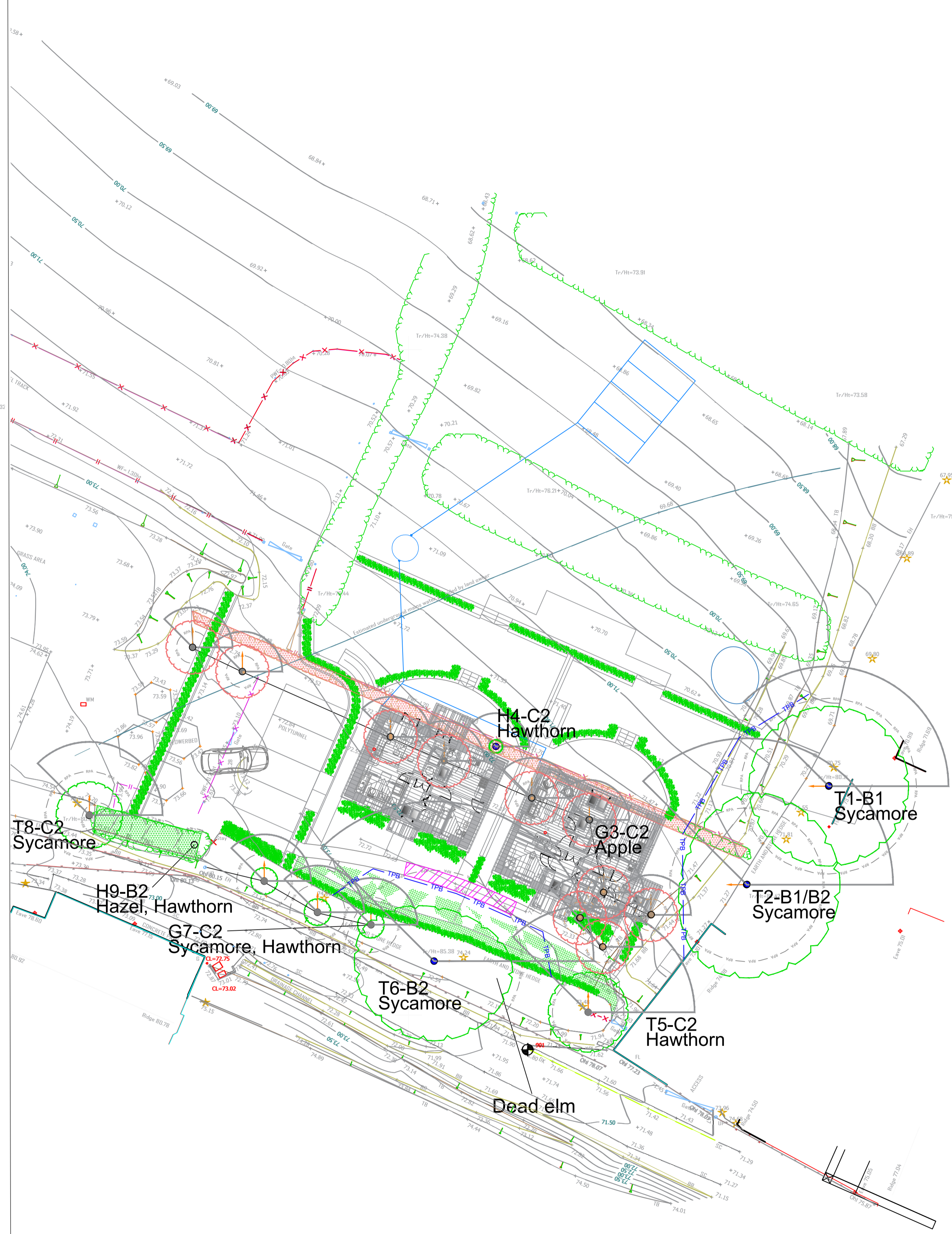

Important: Please note that this plan is to be viewed in colour and at the scale and size presented. It is likely to be difficult to read if presented in a smaller format. Important features of the plan are colour coded and the data processed, and conclusions drawn, may be difficult to assess if presented in black and white.

We have undertaken the survey in accordance with the recommendations in British Standard 5837:2012 Trees in relation to design, demolition & construction - Recommendations (BS 5837).

The dimensions, spreads and root protection areas of groups are based on the largest trees within any group surveyed.

Trees have been surveyed as groups where they form cohesive features either aerodynamically (i.e. they form a discrete group feature providing companionship), culturally (i.e. they are composed of trees of a similar size, age and species subject to the same management) or visually (i.e. where the value of the trees within the group is as a whole rather than individually). The dimensions, spreads and root protection areas of groups are based on the largest trees within any group surveyed.

Only trees over 75 millimetres diameter at breast height (at 1.5 metres above ground level) have been included in the survey unless I have assessed them as being of particularly high value in terms of amenity. Other shrub vegetation on the site that has not been specifically included in this report is not relevant in terms of planning assessment.

Any incursion into the RPA will be unfavourably viewed by the LPA and will need to be supported by a strong argument. The closer to the stem the greater the risk to the trees and the greater the likelihood of the proposals being deemed unacceptable.

Sufficient room must be left for working and access space. This must be outside the RPA.

Individual trees	Groups of trees
<ul style="list-style-type: none"> Shade arc Orientation of first significant branch (FSB) Root protection area (RPA) (amended from circle as required) 	<ul style="list-style-type: none"> Tree Protection Barrier Trees to be removed Construction Exclusion Zone Trees to be pruned AMS1 area - ground protection
<ul style="list-style-type: none"> U Grade trees A Grade trees B Grade trees C Grade trees 	

evolve
TREE CONSULTANCY
P.L.C. (a subsidiary of)

3 Duke Street, Turro TR1 2DE
T 01872 276099
E office@evolvetrees.co.uk
W www.evolvetrees.co.uk

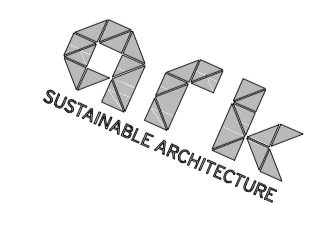

Revision	Description	Date

Client: Andrea and Marcus Bawden

Project: Ryeland, Trevenna Cross

Drawing Title: Arboricultural Impact Assessment Plan

Date: Oct 2023 Job Ref: 4510

Drawn by: SP Scale 1:500 at A2

Based on topographic survey

Drawing number: EV-4510-AIA (Plan)