

NOTES

1. This drawing is to be read in conjunction with all relevant architects, engineers and specialist sub-contractors drawings and specifications.
2. All setting out to be in accordance with the Architects drawings. Dimensions must not be scaled from the drawing.

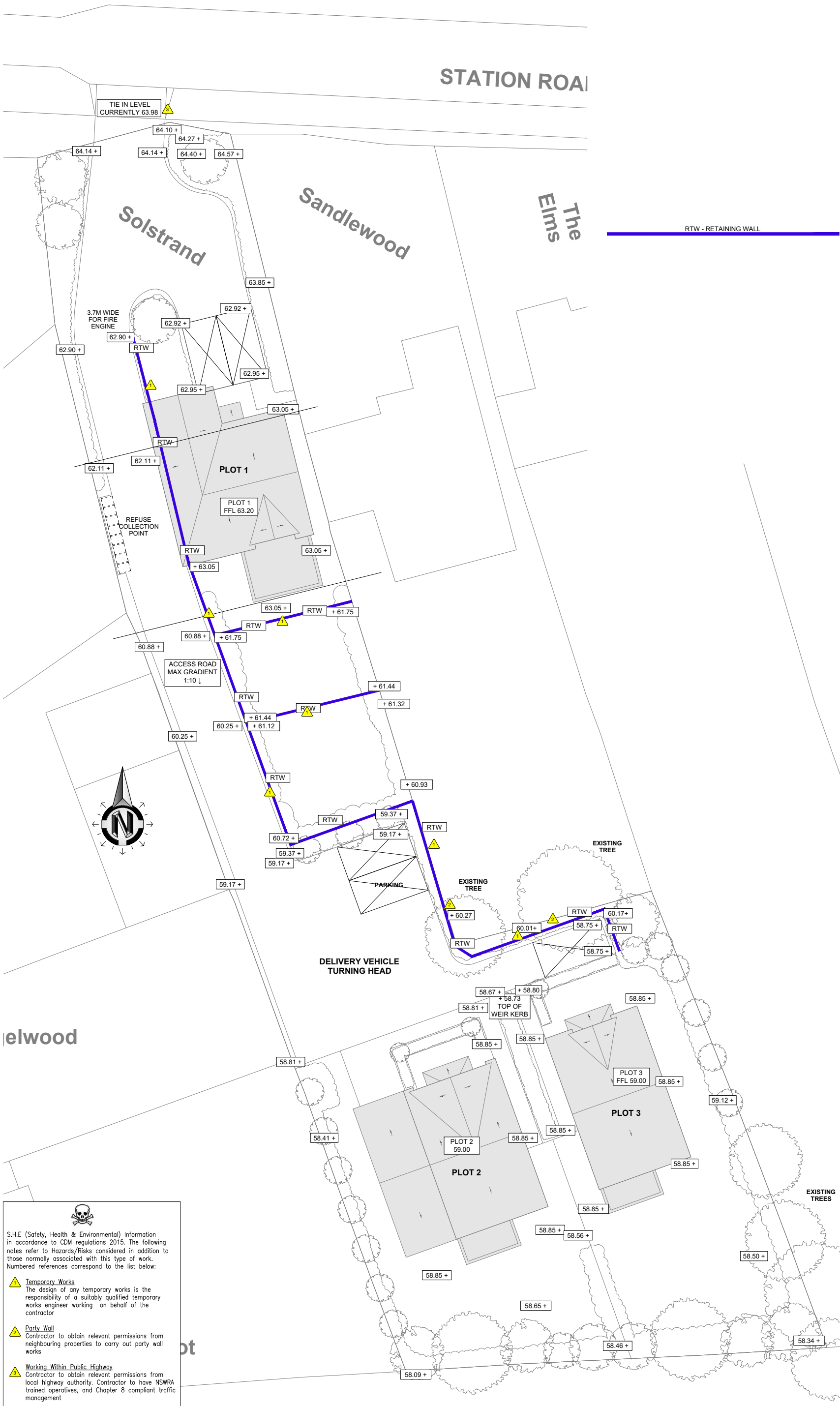

NOT FOR CONSTRUCTION

S.H.E (Safety, Health & Environmental) Information
 in accordance to CDM regulations 2015. The following notes refer to Hazards/Risks considered in addition to those normally associated with this type of work. Numbered references correspond to the list below:

- Temporary Works**
 The design of any temporary works is the responsibility of a suitably qualified temporary works engineer working on behalf of the contractor
- Party Wall**
 Contractor to obtain relevant permissions from neighbouring properties to carry out party wall works
- Working Within Public Highway**
 Contractor to obtain relevant permissions from local highway authority. Contractor to have NSWRA trained operatives, and Chapter 8 compliant traffic management

PO2	11.01.24	Lower turning head layout amended	JLB
PO1	24.05.23	Preliminary Issue	JLB
Rev	Date	Revision Description	Issued by

Drawing Status: **S0 - Work in Progress**

GAP LTD
 Consulting Civil and Structural Engineers
 7 Arrowsmith Court, Station Approach
 Broadstone, Dorset, BH18 8AX
 Telephone: 01202 600900
 Website: www.gapltd.net

Client: **Brooklands Homes**
 Project: **Solstrand, Station Rd, Bagshot**

Drawing Title: **External Works Levels**