

Langton Green Community Sports Association

Creation of an Artificial Grass Pitch

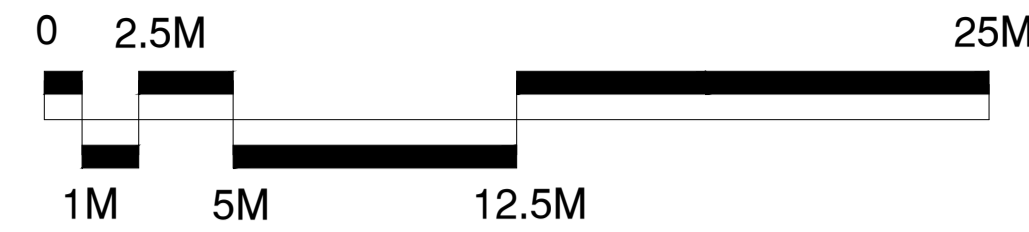

SSU
SURFACING STANDARDS LIMITED
Sports Pitch Consultants

CONSULTANTS
Office 2, 1700-1702, The Hub,
Langton Green, Leicestershire, LE12 9JY
01530 400 012

Lano **CLS**
SPORTS

1. DO NOT SCALE FROM DRAWING UNLESS FOR PLANNING PURPOSES ONLY. ALL DIMENSIONS TO BE CHECKED ON SITE PRIOR TO COMMENCEMENT OF WORKS.
2. THIS DRAWING IS COPYRIGHT TO SURFACING STANDARDS LTD.
3. ALL PERSONNEL SHOULD BE AWARE OF THE HEALTH AND SAFETY PLAN WHICH IS RETAINED AT THE SITE MANAGERS OFFICE.

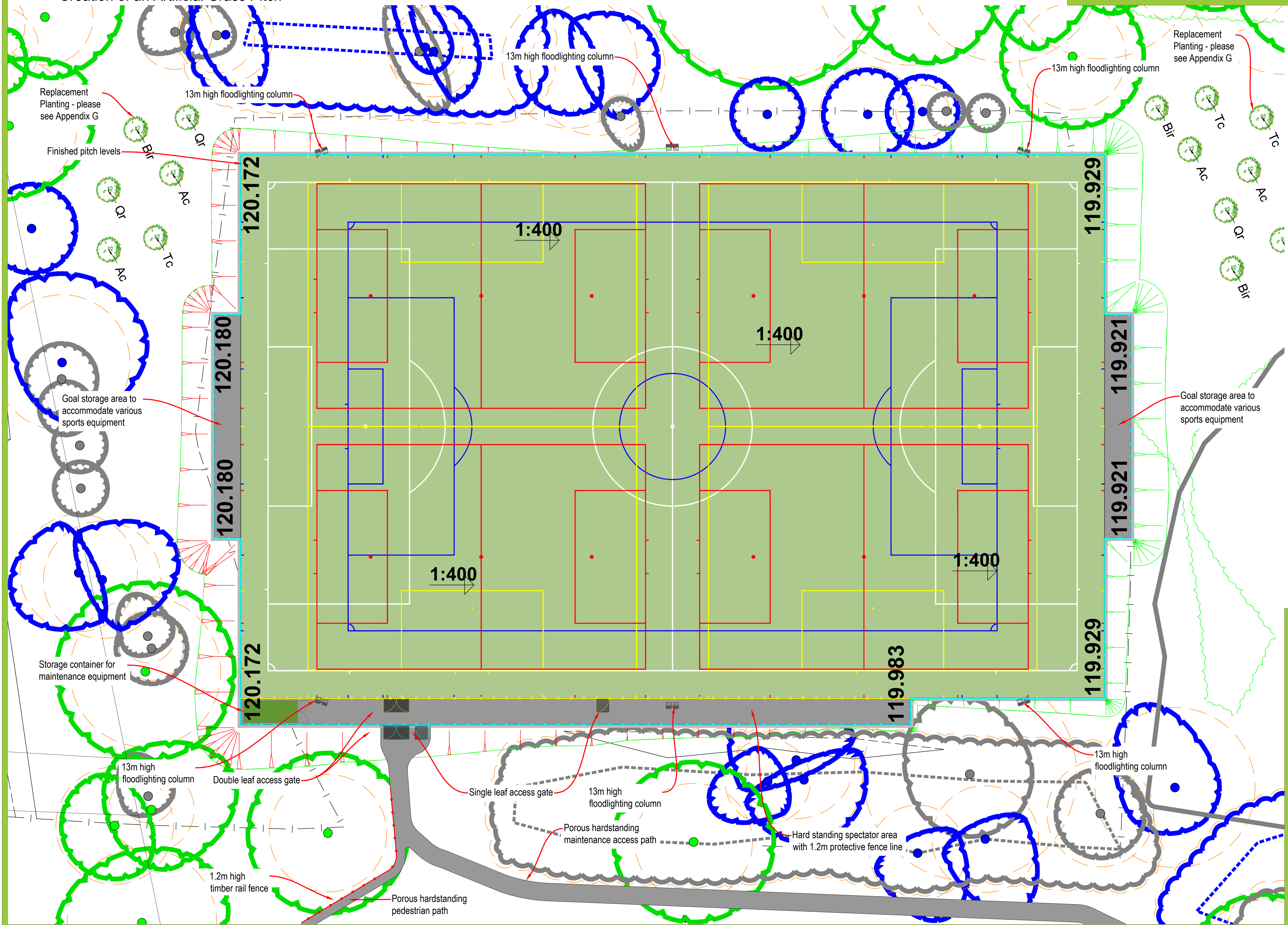

- Artificial Turf Playing Area
 - Footpaths & Hard Standing Areas
 - 4.5m High Fence Line
 - 1.2m High Fence Line
- Notes:
Line markings to accommodate:
1Nr. 11v11 91x55m (white)
1Nr. 9v9 73x46m (blue)
2Nr. 7v7 54.8x37m* (yellow)
4Nr. 5v5 37x25.32m* (red)
- *Smaller than recommended size but acceptable for FA match play

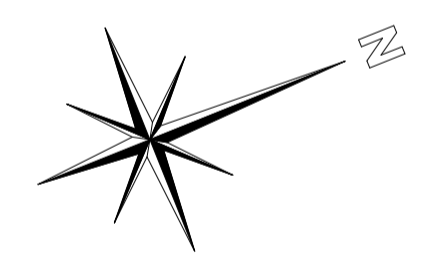

00	PLANNING ISSUE	ME	WB	15.11.23
REV	DESCRIPTION	REV	CK	DATE

SSU
Surfacing Standards Limited
SPORTS PITCH CONSULTANTS

SPELDHURST CP

AUTHOR
ME

TITLE
Langton Green Community Sports Association
Creation of an Artificial Grass Pitch
Proposed AGP Plan

PROJECT	SCALE	SIZE
LANO-CLS030	1:200	A1
DRAWING No	REVISION	
04	00	