

Notes

- This drawing is to be read in conjunction with all relevant Engineers, Architects and Designers drawings.
- This drawing must not be scaled, except for planning purposes. For all dimensions, levels and setting out information see Architects drawings.
- All workmanship and method of construction should comply with all relevant Codes of Practice, British Standards, the current edition of the Building Regulations and good building practice.

Steel Notes
Steel to be designed, detailed, fabricated and erected in accordance with BS5950 Part 1.

All steel to be grade S355

Corrosion Protection
Internal Steelwork:
All steelwork is to be shop blasted to Swedish Standard Sa 2.5 and to receive one coat of HB zinc phosphate (80µm) paint (shop applied) or as noted otherwise

Internal Steelwork with-in Cavity:
All steelwork is to be shop blast to Swedish Standard Sa 2.5 and to receive a 2 pack zinc rich epoxy (80µm), epoxy M10 (125µm), (SL3)

Fire protection to Architect's specification.

Timber Notes
All timber is to be in accordance with BS5268.

All structural softwood is to be marked 'DRY' or 'KD'.

Timber floor joists to have either herringbone strutting or full depth blocking positioned as follows:
at midpoint for spans over 2.5m
at third points for spans over 4.2m

Joists to be doubled up below partitions and bath locations. At chimney stack locations, joists to be at least 40mm from the stack and 200mm from the flue.

Timbers running parallel to external walls are to be strapped to wall using 30x5 galvanised mild steel straps extending over at least three timbers at 1200 mm centres. Timbers are to have solid blocking together with packing to the masonry at strap positions.

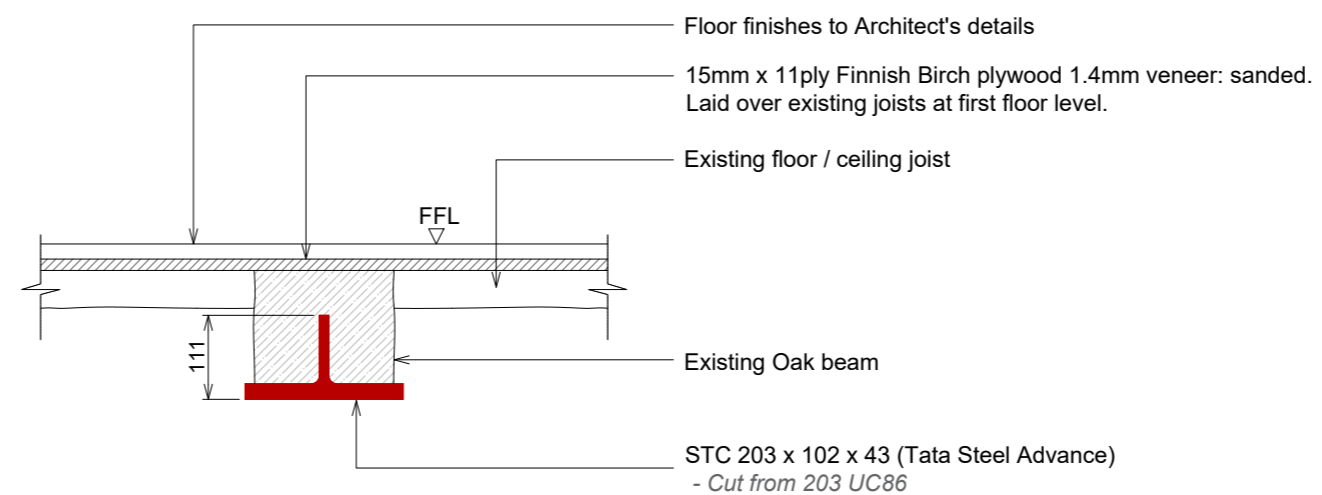

Indicative Section Through Kitchen Beam

Scale 1:10

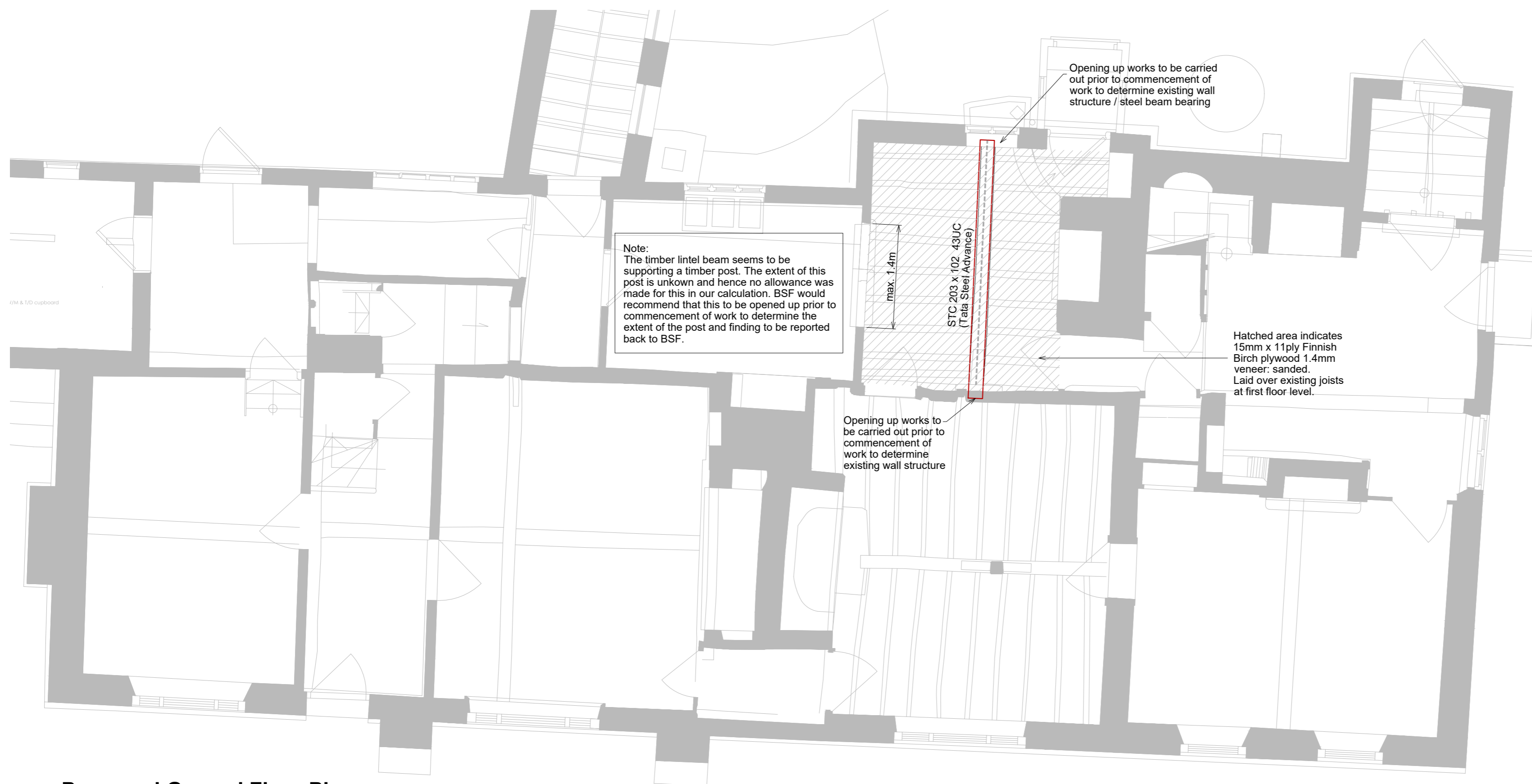

Proposed Ground Floor Plan

scale 1:50

Rev	Date	Description	By	Ckd

Copyright and other intellectual property rights in this document and all related documents, drawings, etc., including calculations, is invested in BSF Consulting Engineers Limited and cannot be used or reproduced for any other purpose than that for which they have been created without the express permission in writing by BSF Consulting Engineers Limited.

CLIENT

Jessica Arnold & James Whitfield



PROJECT TITLE

Internal Alterations at The Quest, West Street, Harrietsham

DRAWING TITLE

Ground Floor Plan

SCALE	DRAWN	DATE	SIZE
as noted	ajv	Sept'23'	A2
DESIGNED	CHECKED	APPROVED	DATE
ug			
STATUS	PRELIMINARY		BSF Project No. *****
DRAWING No.	18629/A2/001		REVISION P1