

### PROPOSED GROUND FLOOR PLAN

Scale 1:100 @A3

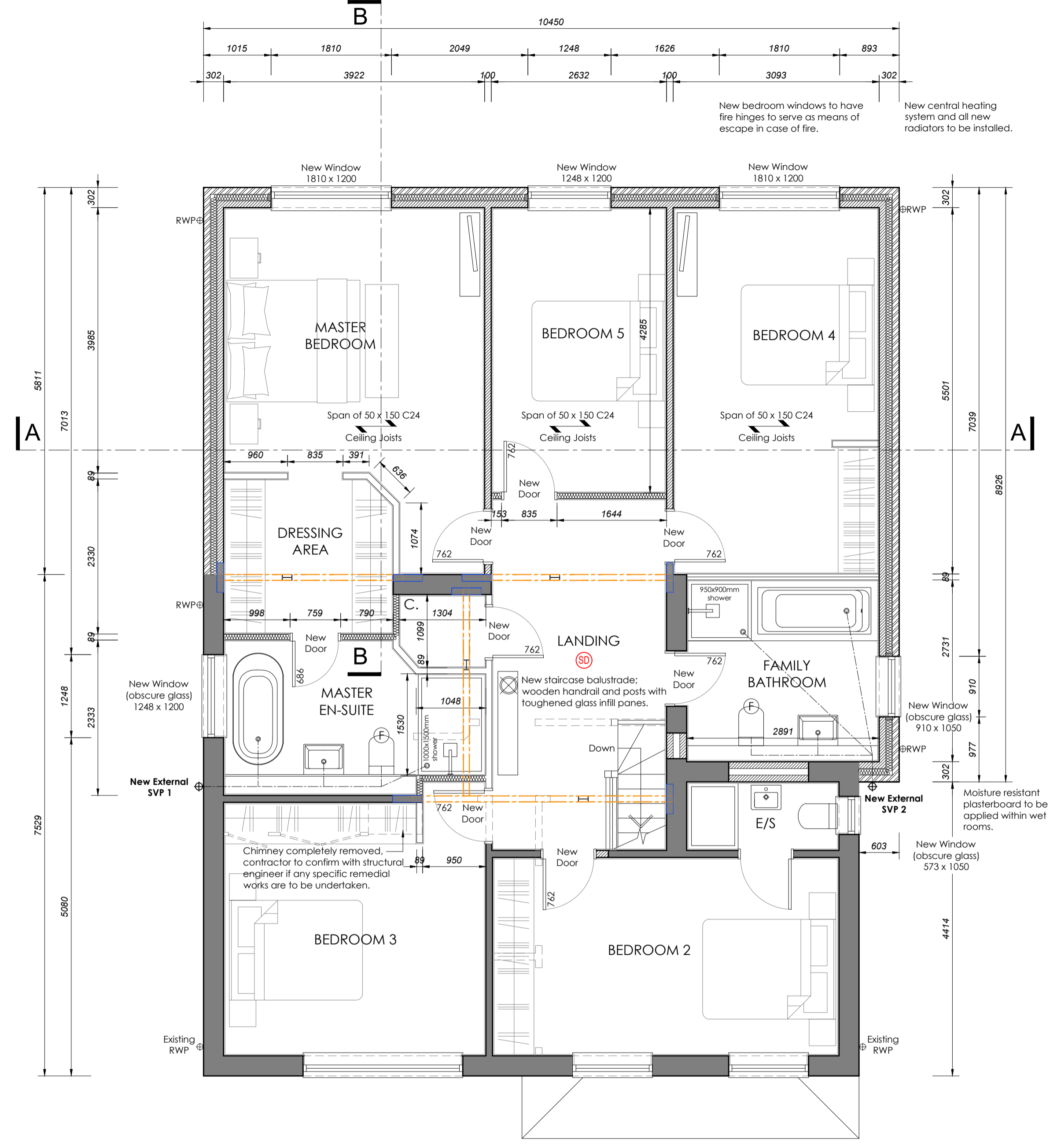

### PROPOSED FIRST FLOOR PLAN

Scale 1:100 @A3

**NOTES**

This drawing is the copyright of Hampshire Architecture Ltd ©. All rights reserved. Do not scale from this drawing except for planning purposes. Contractors, Sub Contractors and Suppliers are to check all relevant dimensions and levels of the site and building before commencing any third party drawings or building work. Any discrepancies should be recorded to Hampshire Architecture Ltd. Where applicable this drawing is to be read in conjunction with all the relevant consultants, suppliers and manufacturers drawings and information.

REV	DESCRIPTION	DATE	AUTHOR	CHK'D
P1	Preliminary Issue	23.05.22	CA	
T1	Tender Issue	18.08.22	CA	
T2	Single storey projection omitted from GF plan, internal and external drainage updated to suit. Updates clouded.	09.11.23	CA	
T3	Updated with latest Struct Eng information.	18.12.23	CA	

**MATERIAL LEGEND**

- Facing brickwork (102.5mm)
- 100mm Dense concrete (or similar) block - 7.3N/mm<sup>2</sup>.
- 100mm Thermalite (or similar) block - 3.6N/mm<sup>2</sup>.
- Internal non-loadbearing partition with insulation between

As a minimum mineral fibre insulation must be provided to the voids in studwork if partitions are between habitable rooms, or to bathrooms / W/C's in accordance with Part E requirement of 40db minimum airborne sound transmission.

**NOTES**

MORTAR DESIGNATION TO BE IN STRICT ACCORDANCE WITH ENGINEERS ADVICE.

BLOCK STRENGTHS TO BE IN STRICT ACCORDANCE WITH ENGINEERS SPECIFICATION.

**WALL CONSTRUCTIONS**

**External wall** construction to consist of 102.5mm facing brickwork to match existing house, 100mm cavity with full fill insulation Knaf Diltrem Cavity Slab 34 (i.s.c.), 100mm 3.6N (unless noted otherwise) Thermalite block inner leaf (a.s.c.), 50mm Knaf PIR Laminate (9.5mm Plasterboard + 40.5mm PIR). Moisture resistant board to be used in wet areas.

**Internal wall** construction to consist of 100/140/215mm blackwork, 15mm Gyproc wallboard plasterboard on dabs. Moisture resistant board to be used in wet areas.

**Internal partition** construction to consist of 89mm timber stud partitioning with 15mm Gyproc wallboard fixed both sides (provide 45mm Isowool APR 1200' or similar insulation to the void of partitions in accordance with Part E requirement of 40db minimum airborne sound transmission)

**Fire Safety** - Ensure stairwell wall / soffit construction to be fire resistant to 30 minutes

**STRUCTURAL SUPPORT / STEEL REQUIREMENTS**

Structural support shown indicative only, refer to engineers drawings & specification

Padstone in accordance with engineers drawings & specification

**NOTES**

**ALL STEELWORK MUST BE SUITABLY PROTECTED WITH INTUMESCENT PAINT OR ENCASED WITH PLASTERBOARD TO ENSURE 30 MINUTES FIRE RESISTANCE IS ACHIEVED IN STRICT ACCORDANCE WITH THE MANUFACTURERS RECOMMENDATIONS.**

REFER TO ENGINEERS DRAWINGS FOR STRUCTURAL REQUIREMENTS.

REFER TO SUPPLIERS SCHEDULES FOR LINTEL REQUIREMENTS.

**GENERAL LEGEND**

AAV = Air Admittance Valve  
SVP = Soil Vent Pipe  
FS = Floor Socket  
RWP = Rain Water Pipe  
ME = Mechanical Extract Fan  
FAF = Fan Assisted Flue

ED1 = External Door 1  
D1 = Door 1  
838FD30(S)SC = 30 Minutes Fire Resistance (Smoke Seals & Intumescent Strips), Self-Closing Door  
W2 = Window 2

**THIS DRAWING IS TO BE READ ALONGSIDE THE STRUCTURAL ENGINEERS CALCULATIONS AND DRAWINGS REFERENCE WRDEL/73988.**

TENDER

**HA**  
HAMPSHIRE  
ARCHITECTURE

info@hampshirearchitecture.com | www.hampshirearchitecture.com

CLIENT  
**ADAM BENNETT**

PROJECT  
**58 Woodfield Drive  
Winchester**

DRAWING  
**Ground & First Floor Plan**

SCALE	DATE	AUTHOR	CHK'D
1:50 @ A1	May 22	CA	
JOB NO.	DRAWING NO.	REV	
1006	200	T3	