

© Crown copyright and database rights
[year of supply or date of publication]
Ordnance Survey 0100031673

EXISTING AREA LOCATION

(SCALE 1:1250)

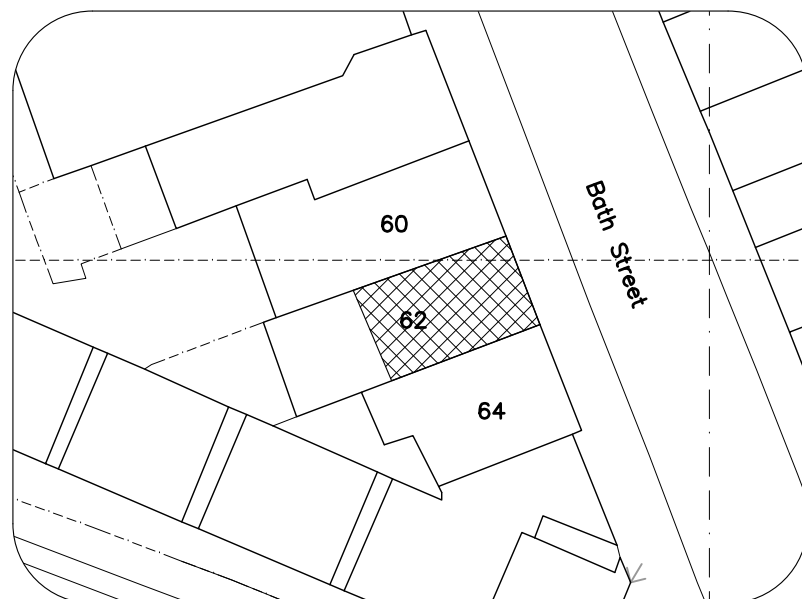

PROPOSED SITE LOCATION

(SCALE 1:500)

(proposal shown hatched)

no external bike or
bin storage to rear
as no access

0 5000 10000
(Scale 1:500)

0 25m 50m
(Scale 1:1250)

Iss	Revision	Date
 UDDIN DESIGN BESPOKE BUILDING PLANNING 3 Monway Building, Holyhead Road Wednesbury, West Midlands WS10 7PY Tel: 07958 773443 Email: info@uddindesign.co.uk		
Client		
FLAT 3 62 BATH STREET LEAMINGTON SPA CV31 3AE		
Project		
SITE AND AREA LOCATION		
Scale: 1:50(UNO)@A3 Date: 27/01/24		
Drawn: SU Paper Size: A3		
Drawing Number:		Revision
23/038/P02		