

VOLUME OF REAR DORMER	= 1/2 (LENGTH X HEIGHT X DEPTH)
VOLUME OF REAR DORMER	= 1/2 (5.400 X 2.300 X 4.000)
VOLUME REAR DORMER	= 49.680 CUBIC METERS
VOLUME REAR DORMER	= 49.68 CUBIC METERS

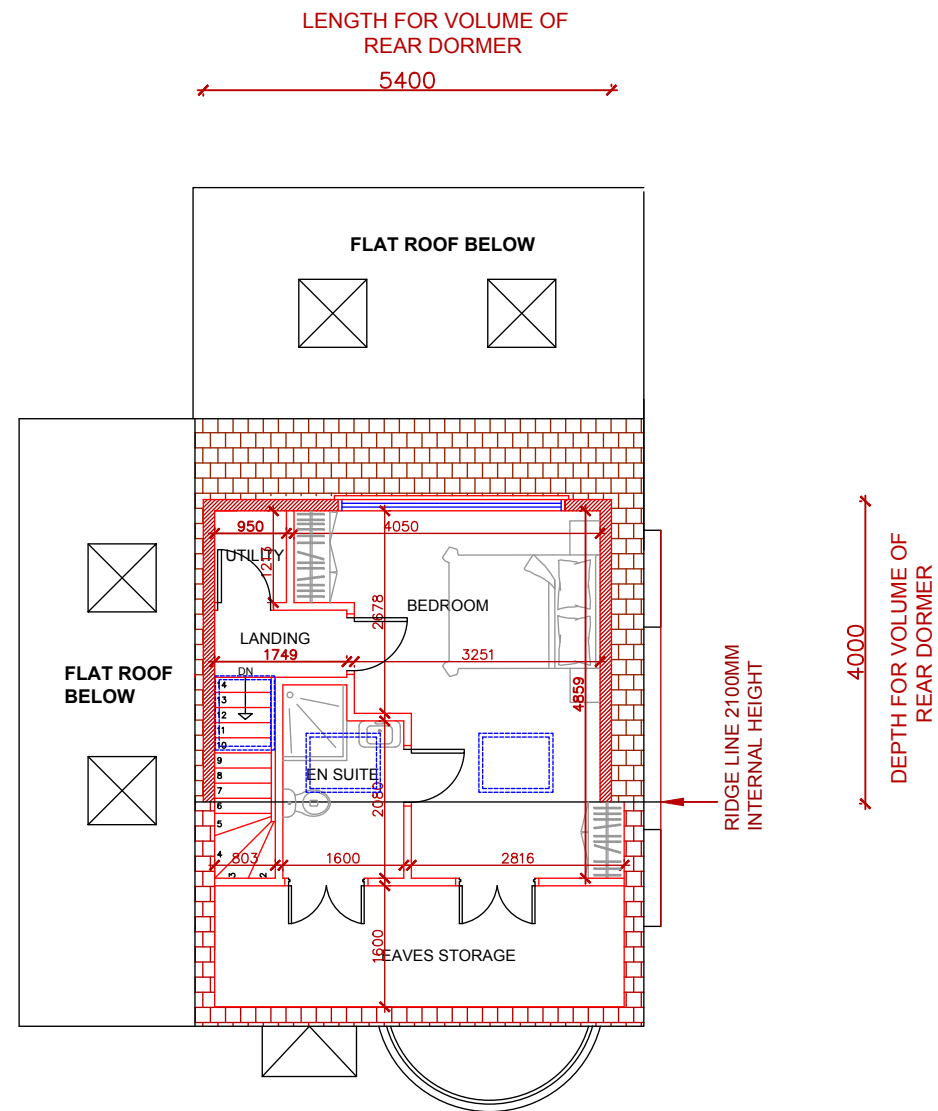

06 LOFT FLOOR - PROPOSED
1:100 @A3

ALL WORK TO COMPLY WITH CURRENT BUILDING REGULATIONS AND CODES OF PRACTICE.
ALL DIMENSIONS IN MM UNLESS NOTED OTHERWISE.
MEASURED SURVEY DOES NOT INCLUDE FOR INTRUSIVE SURVEY TO DETERMINE EXACT LOCATION OF STEELWORK/SUPPORTING STRUCTURE.
"THIS DRAWING IS PREPARED SOLELY FOR DESIGN AND PLANNING SUBMISSION PURPOSES. IT IS NOT INTENDED OR SUITABLE FOR EITHER BUILDING REGULATIONS OR CONSTRUCTION PURPOSES AND SHOULD NOT BE USED FOR SUCH".
THIS DRAWING IS COPYRIGHT AND MUST NOT BE TRACED OR COPIED IN ANY WAY OR FORM.

PLEASE NOTE: PROPERTY OWNER TO ENSURE THAT ALL ASPECTS OF THE "PARTY WALL ETC, ACT 1996" ARE COMPLIED WITH PRIOR TO ANY WORK COMMENCING ON SITE.

VARIATIONS IN SQUARENESS, DEPTH OF PLASTER ETC, MUST BE CHECKED FOR. WHERE NEW WALLS ARE SHOWN AS ALIGNED WITH EXISTING WALLS, PHYSICAL REMOVAL OF BRICKWORK AND / OR PLASTER TO ESTABLISH THE ACTUAL POSITION OF THE WALL BEING ATTACHED TO MUST BE CHECKED.

ANY DEVELOPMENT WITHOUT A CERTIFICATE OF LAWFULNESS OR PLANNING PERMISSION IS SOLELY AT OWNER'S RISK.

MATERIALS SHOULD MATCH THOSE OF THE EXISTING DWELLING

KEY:

█	→ EXISTING
█	→ PROPOSED
█	→ DEMOLISHED
█	→ WINDOW/GLASS
█	→ BOUNDARY

DO NOT USE FOR ANY CONSTRUCTION WORK
DOCUMENTS SHOULD BE USED AS THE DRAWING STATUS DESCRIBED, ANY OTHER USE IS DONE SO AT THE RESPONSIBILITY OF THE USER.

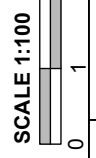

Revision	Description	Date
----------	-------------	------

ESEN LOFT ARCHITECTURE
FULL PLANNING SERVICES
02038369450 / 07475122303
Innova Business Park, Electric Avenue Vision 25, Enfield EN3 7GD
Email: info@esenloft.co.uk
Website: esenloft.co.uk

ADDRESS
19 LAWRENCE AVENUE, LONDON, NW7 4NL

PROJECT
LOFT CONVERSION WITH REAR DORMER

TITLE
LOFT PLAN

DRAWN BY HASAN BAGCIH	SCALE 1:100 @A3
DRAWING NO N170-05	DRAWN BY CHKD BY
	REVISION DATE
	05 10-12-2023

