

**CDM Regulations 2015**  
Denotes a significant hazard or difficult management procedure. Please refer to drawing notes for potential hazards. Main contractor to plan for mitigation measures in response to hazards.  
CDM Regulations require that all projects are to:  
• Have workers to be competent and are suitably skilled for the work they carry out;  
• Contractors to provide appropriate supervision, instruction and information to all on site workers to provide a safe working environment;  
• Have a written construction phase plan.

Worcester architects are appointed as 'Designer only, unless a written appointment has been completed for the formal appointment as 'Principal Designer'

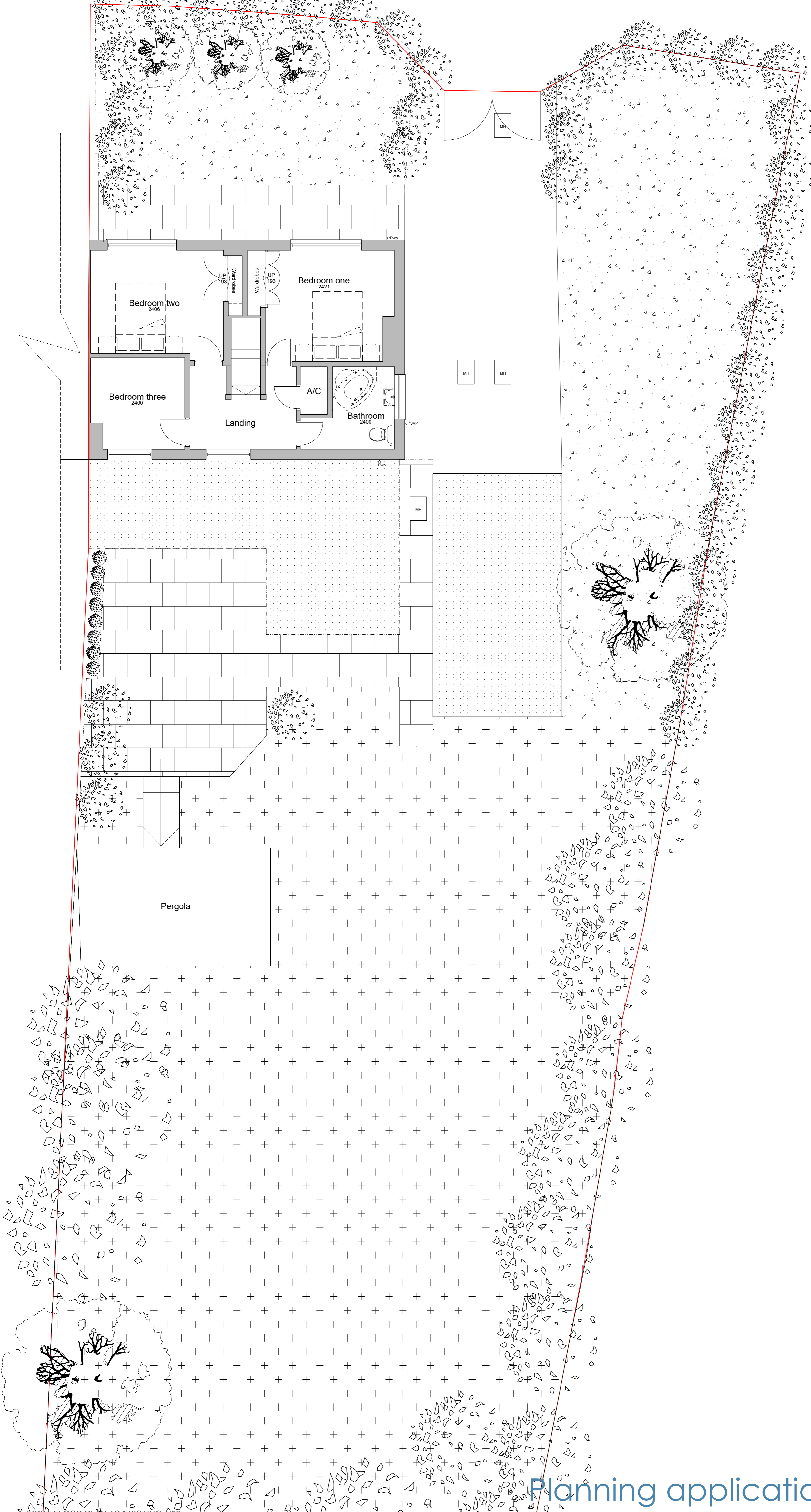

Rev	Note	Date
A	Updated to planners comments	19.12.23

**Worcester Architects**  
Office 20 Sadler Bridge Studios  
Sadler Gate Derby DE1 3NT  
07963780532 01332 742557  
info@worcester-architects.co.uk  
www.worcester-architects.co.uk



Project **10 Neale Bank, Chesterfield**

Drawing Title **First floor plan as existing**

Scale 1:50  
Sheet A1 Drawn By MS Checked By -

Date	Job No.	Drawing No.	Revision
Dec '23	082 2023	003	A

Planning application