

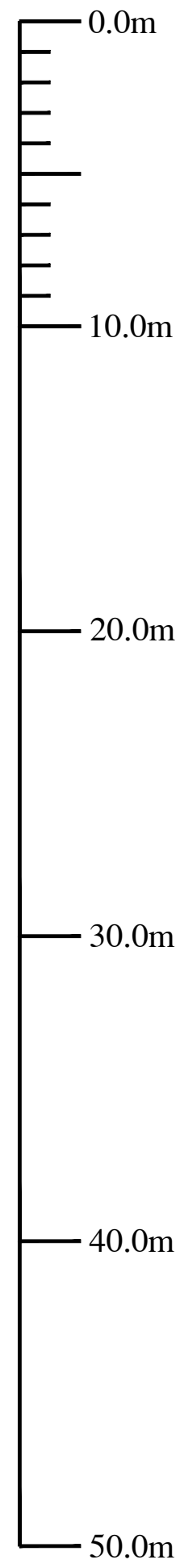

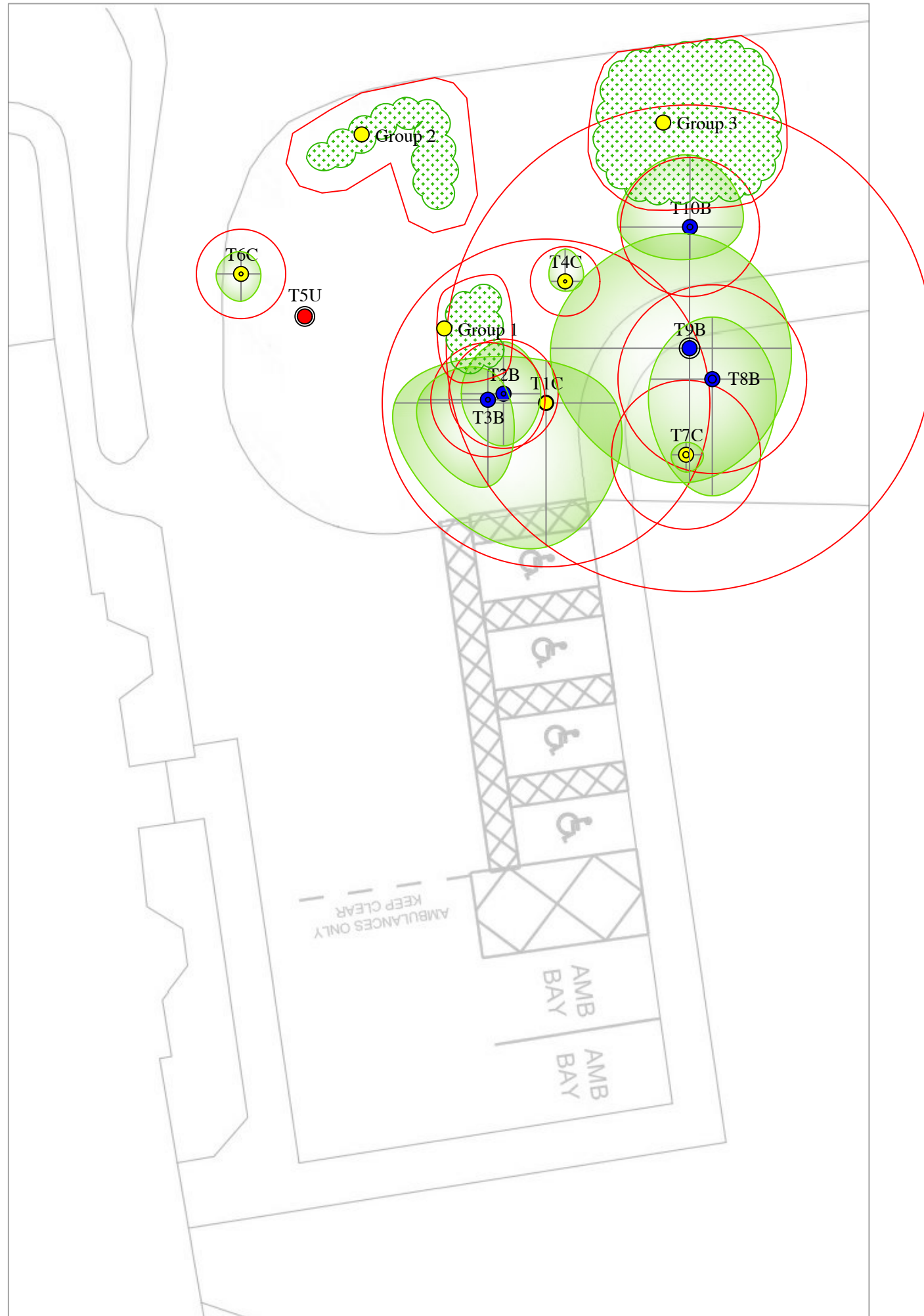

© This drawing should only be used for the purpose for which it is intended, all rights are reserved and it should not be reproduced without written permission. All dimensions should be checked on site and any discrepancies, ambiguities and/or omissions between this drawing and information issued in the accompanying report should be forwarded to this office for clarification before proceeding.

The original of this drawing was produced in colour - a monochrome copy should not be relied upon.



Key:

-  Tree Number
-  Tree Crown True Shape (Shaded Light Green)
-  Predicted Future Growth Of Canopy (Shaded Dark Green & Surrounding Current Crown Shape)
-  Trees To Be Removed (Broken Black Ring Surrounding Centre)
-  Tree Quality Assessment (Centre Colours As Below)
-  Green Centre = High Quality (Denoted By Letter A)
-  Blue Centre = Moderate Quality (Denoted By Letter B)
-  Yellow Centre = Low Quality (Denoted By Letter C)
-  Red Centre = Unsuitable To Retain (Denoted By Letter U)
-  BS Root Protection Area As Shown (By The Red Circle Around The Tree)
-  Tree / Woodland Groups (Root Protection Area Shown By Red Outline Surrounding Group)



 Institute of Chartered Foresters
Registered Consultant

Arboricultural Method Statement
Existing Trees Shown On Existing Layout

St Cuthbert's Hospice,
Durham
For
St Cuthbert's Hospice

 **AllAboutTrees Ltd**
Arboricultural & Ecological Consulting
Chartered Arboriculturalists & Environmentalists

The Old School, Quarry Lane,
Butterknowle, Co. Durham, DL13 5LN
Tel 0191 3739494 01388 710481
email info@allabouttrees.co.uk www.allabouttrees.co.uk

Drawn at Durham Office	By TA	Checked by AW
Scale 1:200 at A3	Date 05.01.24	

-Registered Chartered -Arboricultural Consultants -Planning & Development -Urban Forestry -Ecological Consultants	Drawing Ref.	Revision
	AMS	-
	EXI	-