



Key

- - - - - Existing coving
- - - - - Existing picture rail
- - - - - Existing dado rail
- - - - - Existing glazed bricks below dado rail
- - - - - Existing glazed bricks
- - - - - Existing facing brick
- - - - - Existing door height timber panelling
- Existing solid floor
- Existing timber floor
- Existing parquet floor
- ▲ Existing modern interventions

0 GA Ground Floor Plan - Existing
1:100

Key Plan:

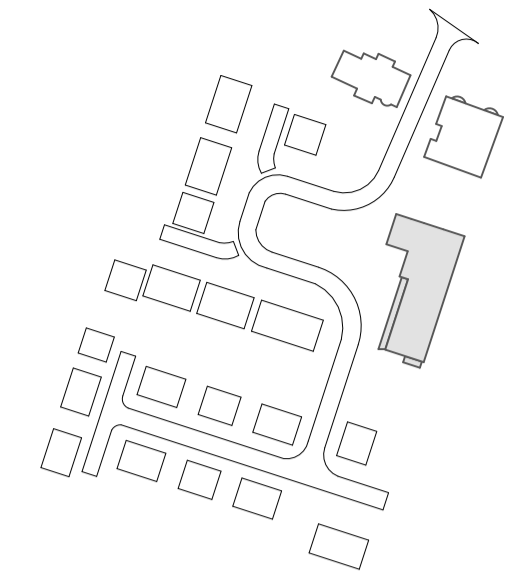

General Notes:

1. Do not scale off this drawing unless a scale bar is provided.
2. Any ambiguities, omissions and errors on this drawing should be notified immediately to the Architect before the commencement of works on site.
3. Dimensions are in millimetres unless otherwise stated.
4. Dimensions, unless otherwise indicated, are to the face of unfinished block walls or to the finished plaster face of stud partitions.
5. Dimensions are to be checked on site. Discrepancies are to be notified immediately to the Architect before the commencement of works on site.
6. All levels are in meters unless otherwise stated.
7. This drawing is to be read in conjunction with all other relevant drawings and specifications for this project.

Revision Notes:

Rev.	Date	Notes	Issuer	Checker
P1	2023-08-04	Preliminary Issue P1	IAT	JC
P2	2023-09-12	Minor amendments to existing building.	MJ	JC
P3	2023-10-06	Existing building elements highlighted post site visit.	MJ	JC
P4	2023-10-17	Planning Submission	MJ	JC



LONDON ROAD NEWARK

Job Number: 23-0030
Project Address: London Rd, Newark NG24 1TW
Client Name: Bildurn Properties

Director / Associate: Matthew Branton
Project Lead: Sarah Boxford
Status: A3 Planning
Functional Breakdown: B3 - Block 3
Sheet Size: A1L
Scale: 1:100

GA Ground Floor Plan Existing - Block 3

Full Document Reference:
BLR-FEA-B3-00-DP-A-2031

Document Number: **2031**
Current Revision: **P4**
Revision Date: **2023-10-17**

