

Key Plan:

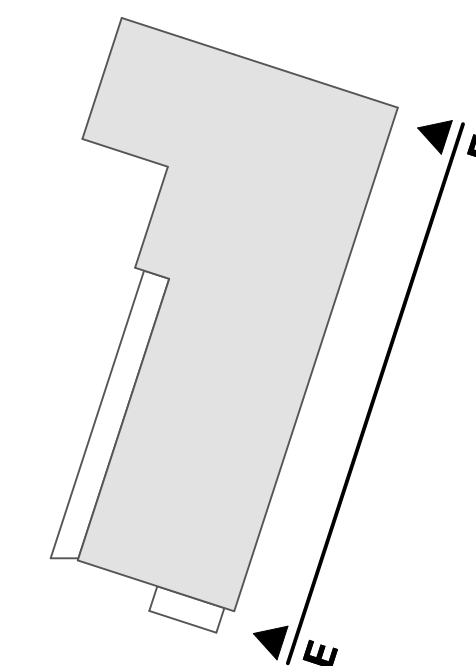

General Notes:

1. Do not scale off this drawing unless a scale bar is provided.
2. Any ambiguities, omissions and errors on this drawing should be notified immediately to the Architect before the commencement of works on site.
3. Dimensions are in millimetres unless otherwise stated.
4. Dimensions, unless otherwise indicated, are to the face of unfinished block walls or to the finished plaster face of stud partitions.
5. Dimensions are to be checked on site. Discrepancies are to be notified immediately to the Architect before the commencement of works on site.
6. All levels are in meters unless otherwise stated.
7. This drawing is to be read in conjunction with all other relevant drawings and specifications for this project.

Revision Notes:

Rev.	Date	Notes	Issuer	Checker
P1	2023-08-04	Preliminary Issue P1	IAT	JC
P2	2023-09-12	Minor amendments to existing building.	MJ	JC
P3	2023-10-17	Planning Submission	MJ	JC



E GA Elevation East Existing
1:100

- | | | |
|------------------------|---|------------------------|
| 1 Brick chimney | 5 Existing Painted timber frame windows | 9 Brick quoins |
| 2 Clay tiled roof | 6 Lead Turret | 10 Stone door surround |
| 3 Rooflight | 7 Timber Louvres | 11 Lead flat roof |
| 4 Timber painted Eaves | 8 Brickwork | 16 Timber |

LONDON ROAD NEWARK

Job Number: 23-0030
Client Name: Bildurn Properties
Project Address: London Rd, Newark NG24 1TW

Director / Associate: Matthew Branton
Project Lead: Sarah Boxford
Status: A3 Planning
Functional Breakdown: B3 - Block 3
Sheet Size: A1L
Scale: 1:100

GA East Elevation Existing - Block 3

Full Document Reference:
BLR-FEA-B3-XX-DE-A-3531
Autodesk DocID: 0030-BLR-London Road Newark/BLR-FEA-B3-XX-DE-A-3531-0031

Document Number: **3531**
Current Revision: **P3**
Revision Date: **2023-10-17**

