

Key

-  Existing walls
-  Early 20th century fabric to be removed
-  Modern interventions to be removed

Key Plan:

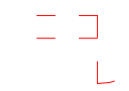
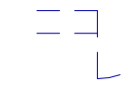
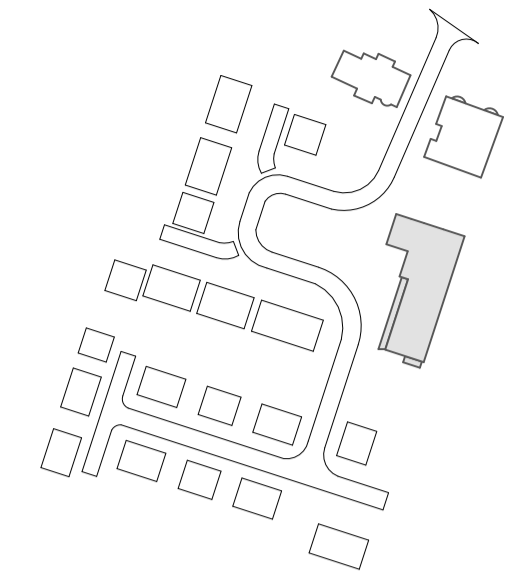

General Notes:

1. Do not scale off this drawing unless a scale bar is provided.
2. Any ambiguities, omissions and errors on this drawing should be notified immediately to the Architect before the commencement of works on site.
3. Dimensions are in millimetres unless otherwise stated.
4. Dimensions, unless otherwise indicated, are to the face of unfinished block walls or to the finished plaster face of stud partitions.
5. Dimensions are to be checked on site. Discrepancies are to be notified immediately to the Architect before the commencement of works on site.
6. All levels are in meters unless otherwise stated.
7. This drawing is to be read in conjunction with all other relevant drawings and specifications for this project.

Revision Notes:

Rev.	Date	Notes	Issuer	Checker
P1	2023-08-04	Preliminary Issue P1	IAT	JC
P2	2023-09-12	Refined layout with elevational alterations.	MJ	JC
P3	2023-09-18	Updated key and layout to show modern intervention demolition.	MJ	JC
P4	2023-10-06	Further notation added.	MJ	JC
P5	2023-10-06	Rooflight reinstated.	MJ	JC
P6	2023-10-17	Planning Submission	MJ	JC



LONDON ROAD NEWARK

Job Number: 23-0030
 Client Name: Bildurn Properties
 Project Address: London Rd, Newark NG24 1TW

Director / Associate: Matthew Branton
 Project Lead: Sarah Boxford
 Status: A3 Planning
 Functional Breakdown: B3 - Block 3
 Sheet Size: A1L
 Scale: 1:100

Drawing Name: GA Roof Plan Demolition - Block 3

Full Document Reference:
 Identification / Location: Project Originator Function Space Form Disc Number
 BLR-FEA-B3-R1-DP-A-2073
Autodesk DocID: 0000-BLR-London Road Newark/BLR-FEA-B3-R1-DP-A-2073_Sheet3.rvt

Document Number: **2073**
 Current Revision: **P6**
 Revision Date: 2023-10-17

GA Roof Plan - Demolition
1:100

