

**B GA Plan Level B1 Basement Floor Existing**  
1:100

Key Plan:

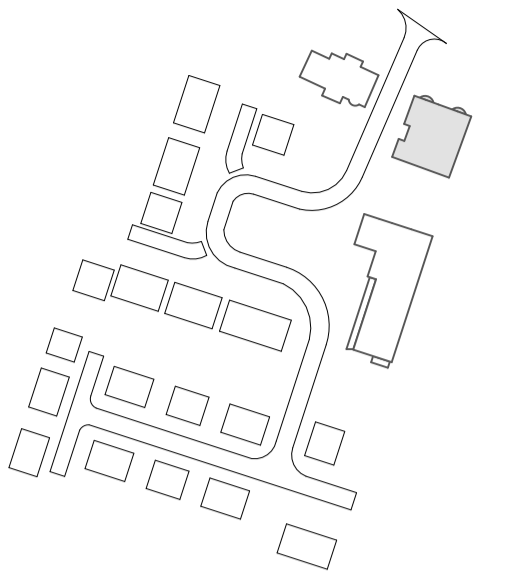

General Notes:

1. Do not scale off this drawing unless a scale bar is provided.
2. Any ambiguities, omissions and errors on this drawing should be notified immediately to the Architect before the commencement of works on site.
3. Dimensions are in millimetres unless otherwise stated.
4. Dimensions, unless otherwise indicated, are to the face of unfinished block walls or to the finished plaster face of stud partitions.
5. Dimensions are to be checked on site. Discrepancies are to be notified immediately to the Architect before the commencement of works on site.
6. All levels are in meters unless otherwise stated.
7. This drawing is to be read in conjunction with all other relevant drawings and specifications for this project.

Revision Notes:

Rev.	Date	Notes	Issuer	Checker
P1	2023-08-04	Preliminary Issue P1	IAT	JC
P2	2023-09-12	Minor refinements to existing drawings.	MJ	JC
P3	2023-10-06	Status Updated to A3 Planning.	MJ	JC
P4	2021-10-17	Planning Submission	MJ	JC



# LONDON ROAD NEWARK

Job Number: 23-0030  
 Project Address: London Rd, Newark NG24 1TW  
 Client Name: Bildurn Properties

Director / Associate: Matthew Branton  
 Project Lead: Sarah Boxford  
 Status: A3 Planning  
 Functional Breakdown: B2 - Building 2  
 Sheet Size: A1L  
 Scale: 1:100

## GA Basement Floor Plan Existing - Block 2

Full Document Reference:  
 Identification / Location: BLR-FEA-B2-B1-DP-A-2020  
 Project Originator Function Space Form Disc Number  
 Amdm Dec23-0030-BLR-London Road Newark/BLR-FEA-B2-B1-DP-A-2020-2020

Document Number: **2020**  
 Current Revision: **P4**  
 Revision Date: **2021-10-17**

