

01 Existing Ground Floor Plan
1:100 @ A3

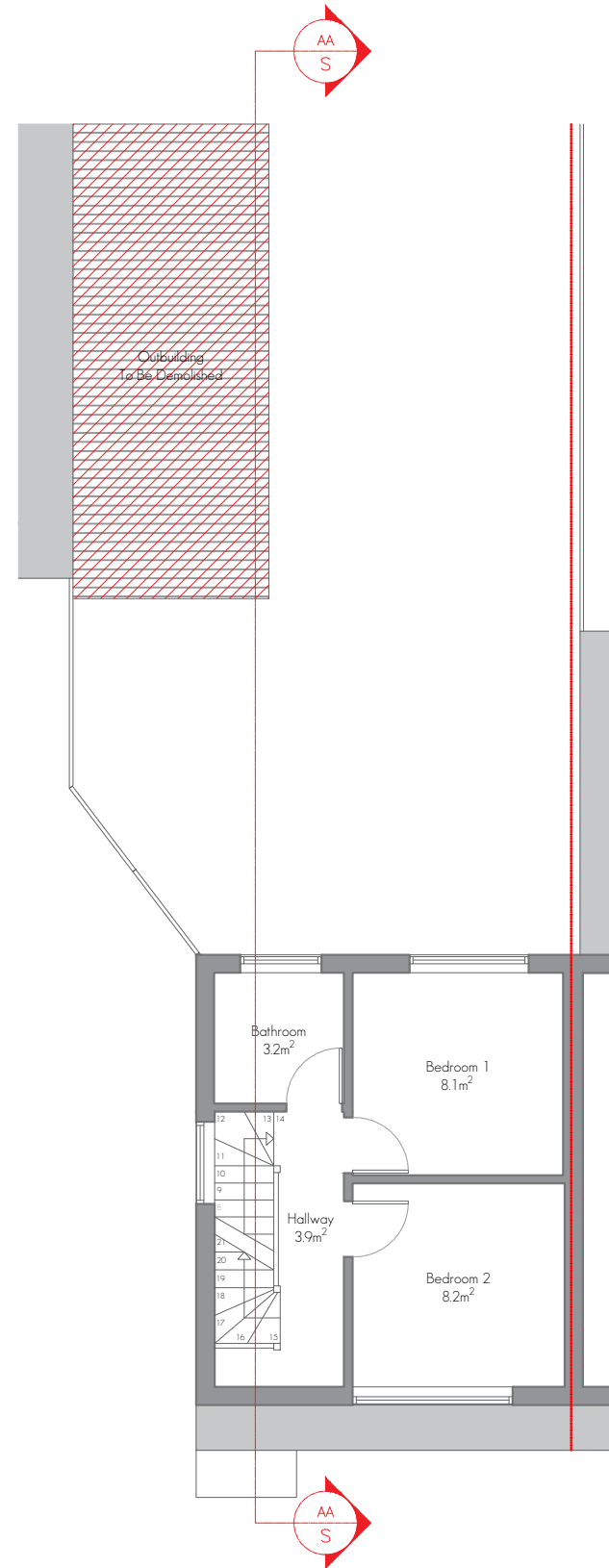

02 Existing First Floor Plan
1:100 @ A3

Key Plan:

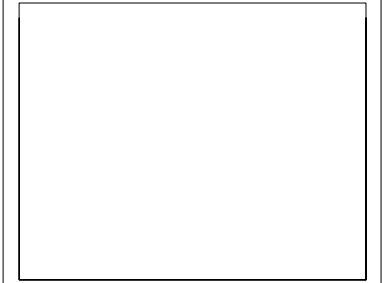

Scale: 1:100 @A3

Key:

General Notes:

Proposed Notes:

B January 2024

PLANNING ISSUE

Project Number: 23002

Date: January 2024

Scale: 1:100 @ A3

Project: 79 Mimms Hall Road, EN6 3DX

Drawing Title: Existing Ground & First Floor

Drawing Title: 23002-PL100-A

Drawn: IB Rev: B



I.B Architectural Design
Copyright I.B Architectural Design
No implied license exists. This drawing should not be used to calculate areas for the purposes of valuation. All dimensions to be checked on site by the contractor and such dimensions to be their responsibility. Do not scale drawings. All work must comply with relevant British Standards and Building Regulations requirements. Drawing errors and omissions to be reported to the designer.

