

- Fenestration:**
- Rooflight to be 625mm², Conservation Plateau by the Rooflight Company.
 - Door and two windows DXE 001, as per detail drawing.
 - Door DXG 001, re-use existing.
- Roof:**
- Timber beam at abutment of flat extension roof and existing property in accordance with engineers details.
 - Single ply membrane in conjunction with a warm roof design. All details, trims, abutments etc to be in accordance with manufacturers details and specification.
 - 18mm WBP plywood deck, mechanically fixed to timber joists.
 - 140mm Recticel Eurothane Eurodeck insulation or equal approved above the joists on 12mm WBP Plywood Deck. Thermal conductivity 0.015W/mK.
 - SW timber Joists to engineers details and specification, retained/reused in the existing extension, where possible. SW treated timber firrings to ensure 1:80 fall away from the historic property.
 - 12.5mm Gyproc Wallboard and skim to ceilings generally. Use moisture resistant plasterboard to bathroom.
 - Vapour Control layer, shown in Magenta, Breather membrane, shown in Green. To be installed in accordance with manufacturer's specifications.
- Fascia:**
- Black painted timber softwood fascia. Sized to match existing, assume 25mm thick.
- Rain water goods:**
- Alumase Heritage Cast Aluminium circular down pipes. RAL 9005 Black.
- Plinth:**
- Underground and below DPC to be engineering bricks to engineer's specifications. Cavity infilled with GEN 1 concrete.
 - Brick coursing to line through with existing extension. Bricks to be Imperial Soft Red handmade bricks.

- Walls:**
- 100mm 3.6N medium density concrete blockwork to external leaf.
 - 100mm 3.6N Autoclaved Aerated concrete blockwork to inner leaf.
 - Finish internally with 12.5mm Gyproc Wallboard (use MR in wet areas) on dabs, with 3mm skim coat, to run into openings.
 - Cavity filled with 100mm full fill Recticel Eurowall insulation. Thermal conductivity 0.022W/mK, or equal approved.
 - Rendered with a cementitious render, to match the existing extension. Painted white to match existing. Include for stainless steel bell drip and edges.
- Floor:**
- 150mm concrete slab on 150mm well compacted hardcore base. Slab connected to existing floor slab in accordance with engineers details and specification.
 - Blue: Damp proof membrane installed, and lapped to DPCs and existing DPM, in accordance with manufacturer's directions. Ensure full continuity of damp proofing!
 - 150mm Kingspan Kooltherm K103 Floorboard insulation, or equal approved, with 25mm Kingspan Kooltherm K103, or equal approved, upstand at perimeter.
 - Magenta: Minimum 500 gauge polythene vapour control layer, lapped minimum 150mm at edges, taped and sealed.
 - Min. 65mm proprietary rapid hardening leveling screed.
- Foundations:**
- In accordance with Structural Engineer's design and specification.
- Landscaping:**
- French drain laid in 150mm wide gravel beneath door.
 - External floor finish at 1:80 fall away from house.

NOTE

1. DRAWINGS MUST NOT BE SCALED; WORK ONLY TO FIGURED DIMENSIONS
2. CHECK ALL DIMENSIONS ON SITE BEFORE ORDERING MATERIALS OR PUTTING WORK IN HAND
3. SHOP DRAWINGS OF MANUFACTURED ITEMS MUST BE APPROVED BY THE ARCHITECTS BEFORE WORK IS PUT IN HAND
4. DIMENSIONS MUST BE VERIFIED ON SITE BEFORE PREPARATION OF SHOP DRAWINGS
5. THE ARCHITECT MUST BE NOTIFIED OF ANY DISCREPANCIES IMMEDIATELY
6. IF IN DOUBT ASK!

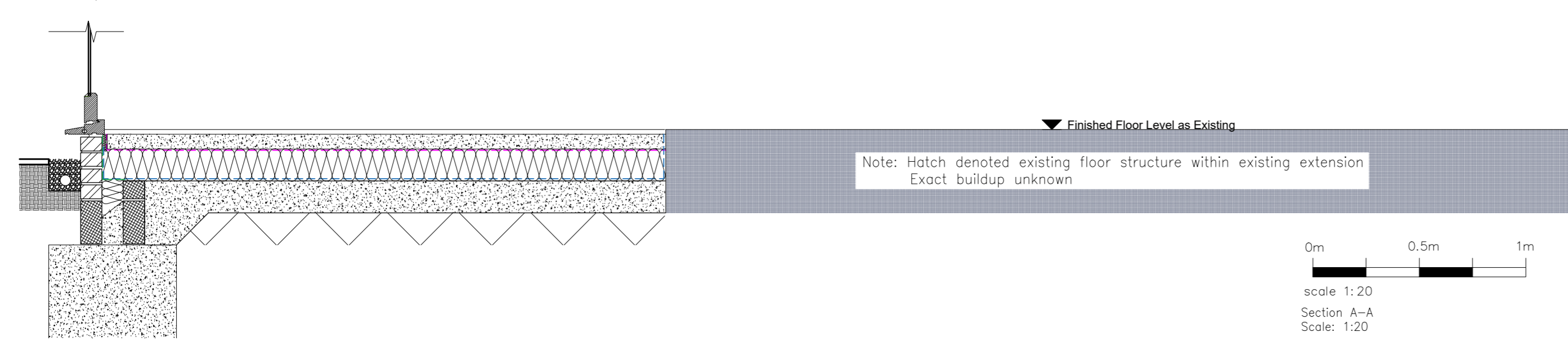
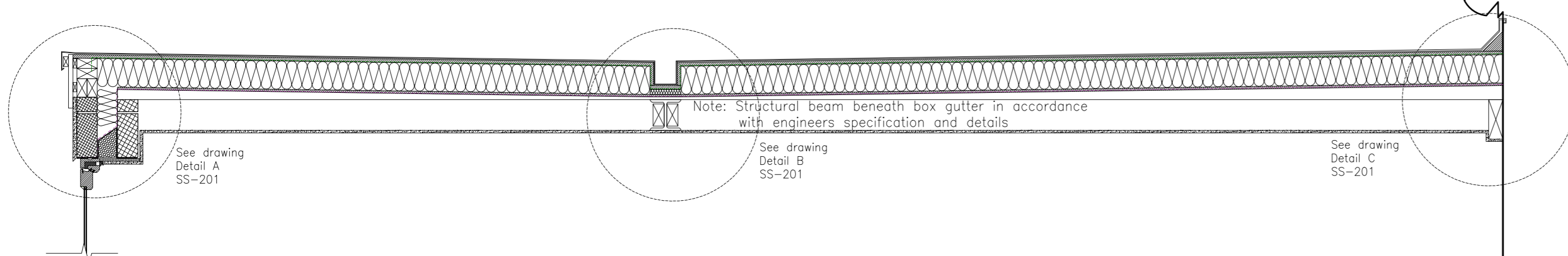

B2 31.01.24 Door detail updated
B1 29.11.23 Issued to Building Control

revisions

BUILDING REGS

MORE THAN PRETTY PICTURES
ARCHITECTS

tel: 07969355994
matthew@mtpa.co.uk

client

Mr & Mrs Chase

job title

2 Lower Road
Glensford

drawing title

Proposed Section A-A

scale

Noted @A2

drawn by

MS

date

Sept' 22

sheet / layout number

22-106-SS-200

rev

B2