

Proposed Extension to the Cottage on Churchgate

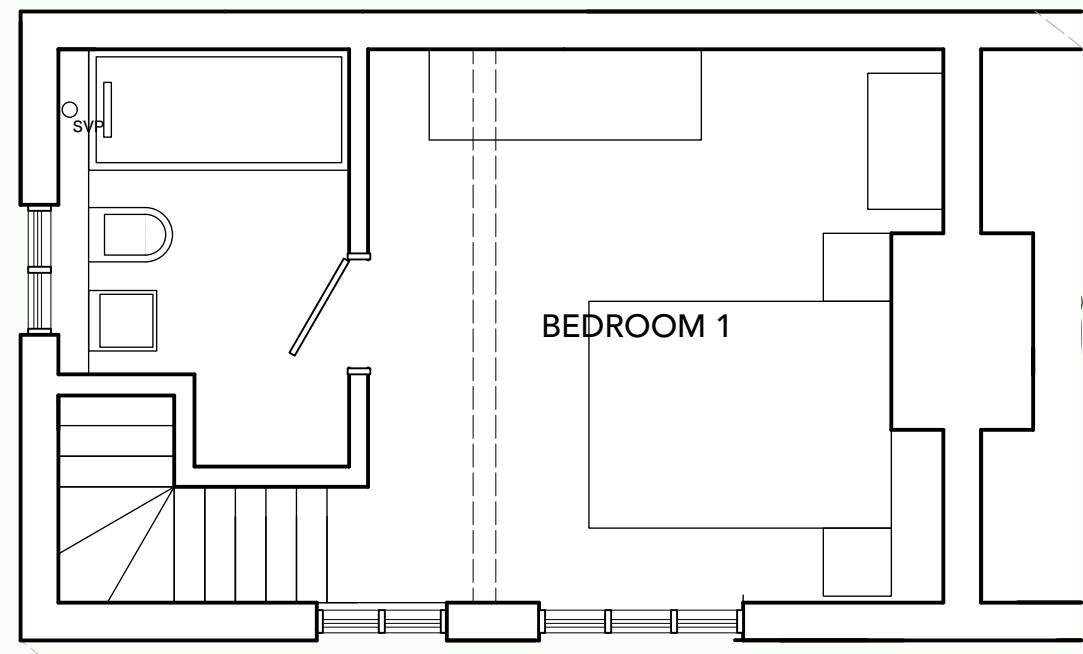
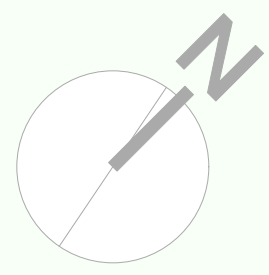

First Floor Existing Cottage

Paddock

Post and rail boundary is planted with existing Hawthorn

Fagus sylvatica hetero phyllia Aspenfolia

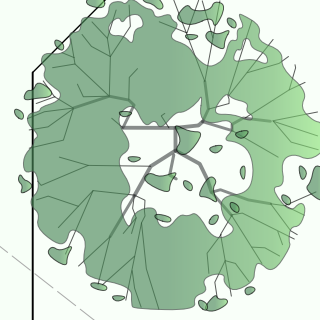

Orchard planted Open Countryside

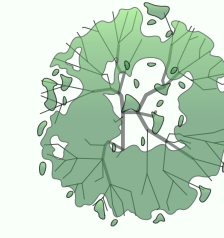
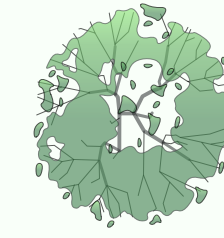
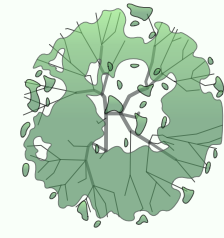

Fagus sylvatica Common Beech

Hornbeam Hedge



Figured dimensions must be taken in preference to scaled dimensions. Any discrepancies must be reported to Stanford Partnership or the relevant Designer. Contractors, sub contractors and suppliers must verify all dimensions on site before commencing any work or making any workshop drawings. All drawings are copyright of Stanford Partnership.



Domestic Garden

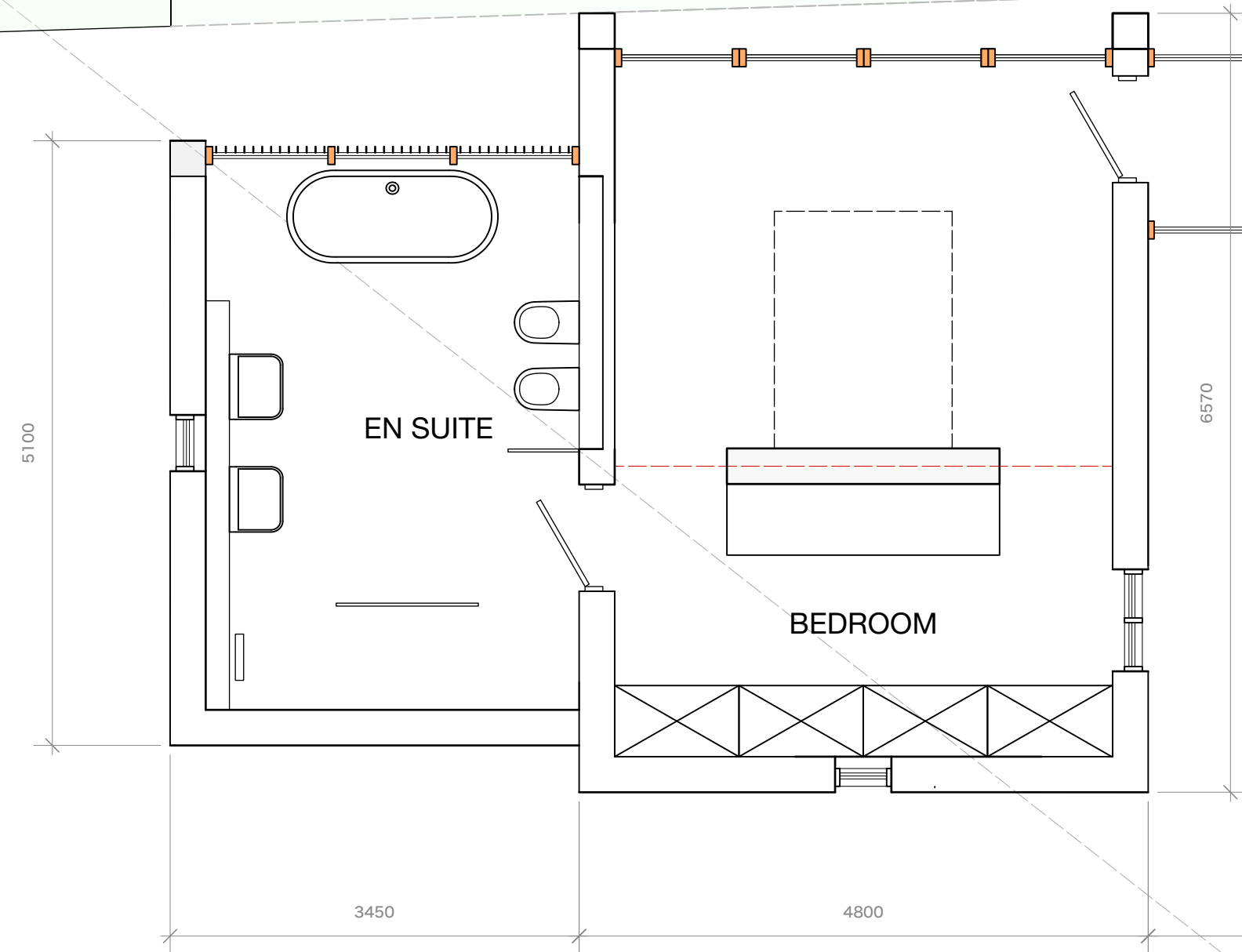

Multi Stem Birch



Domestic Garden

New Tilia cordata

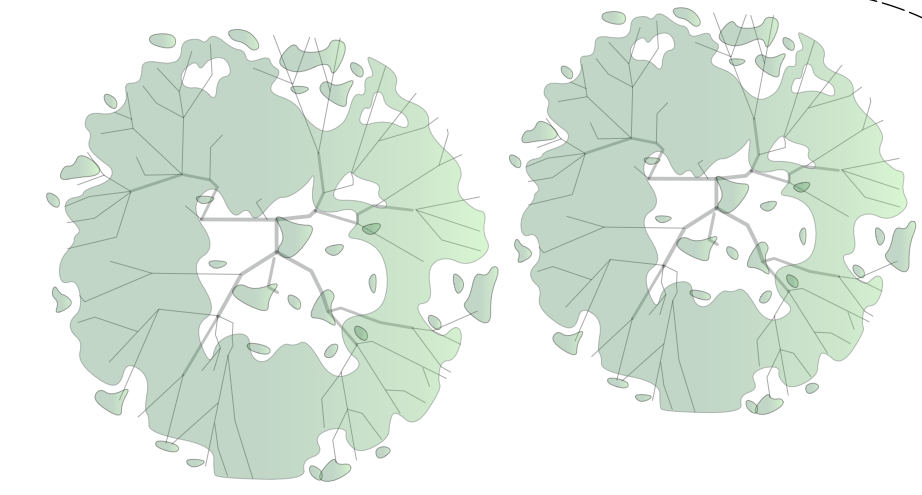
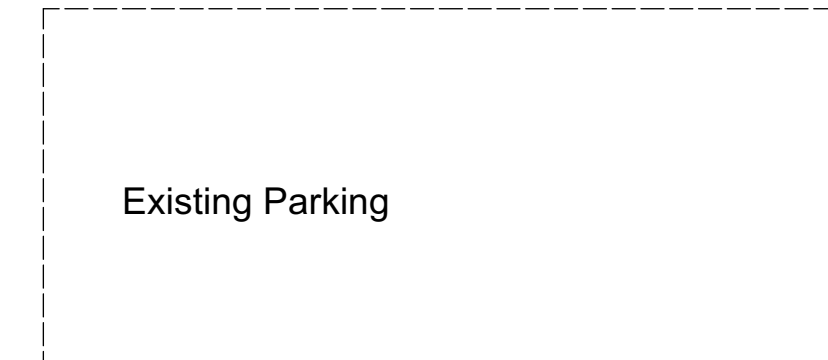
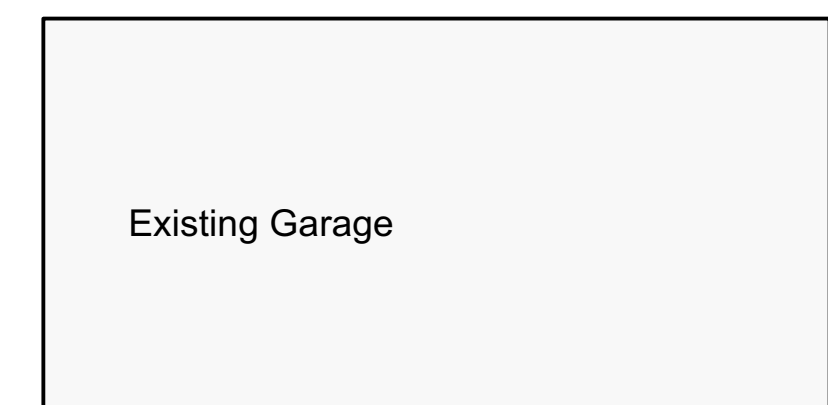
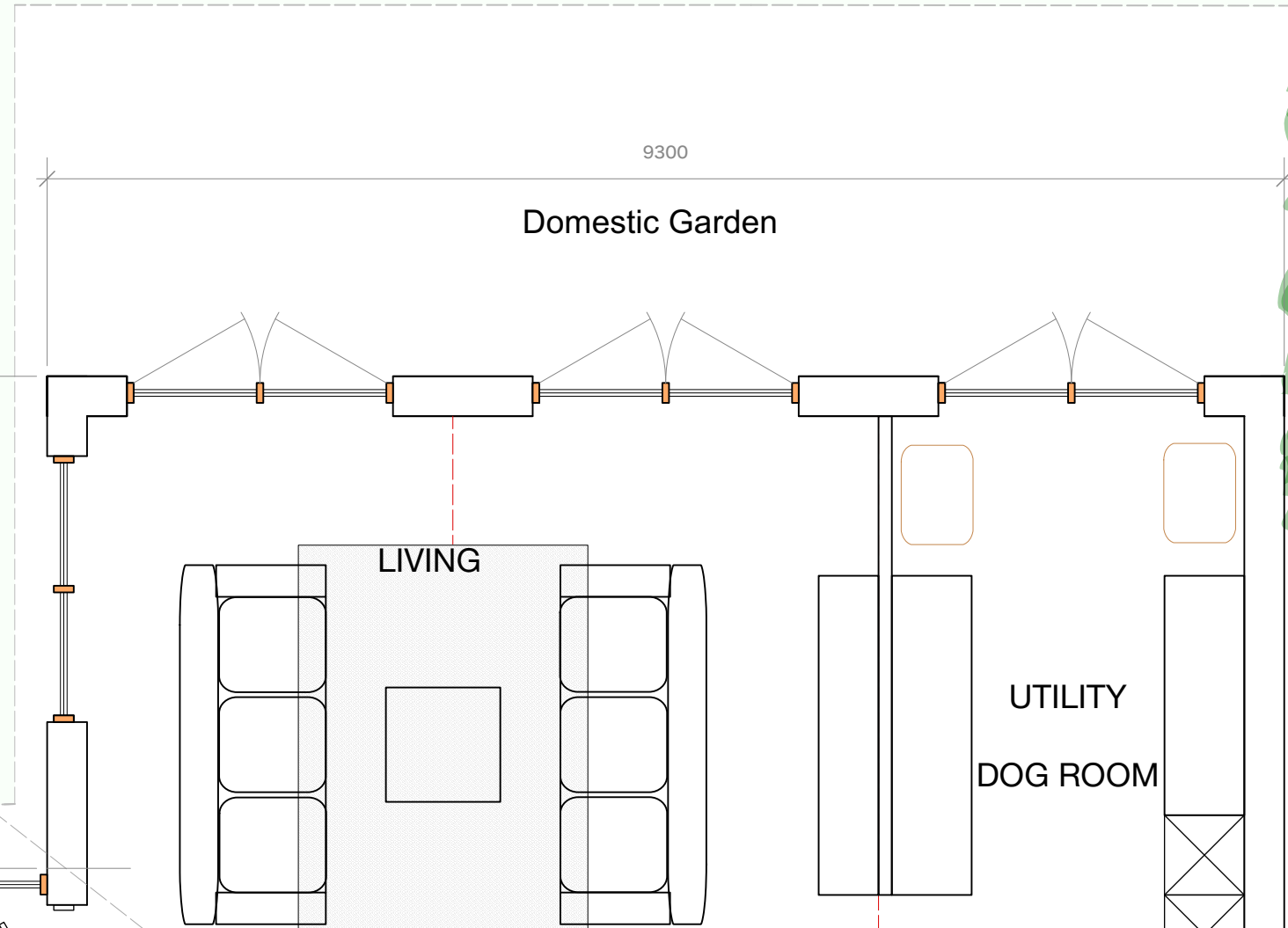
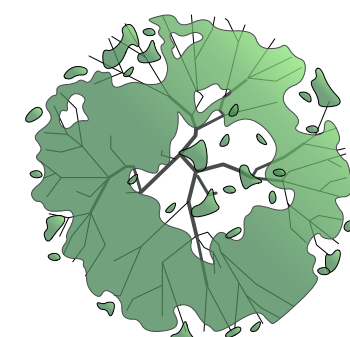

Honeysuckle Cottage

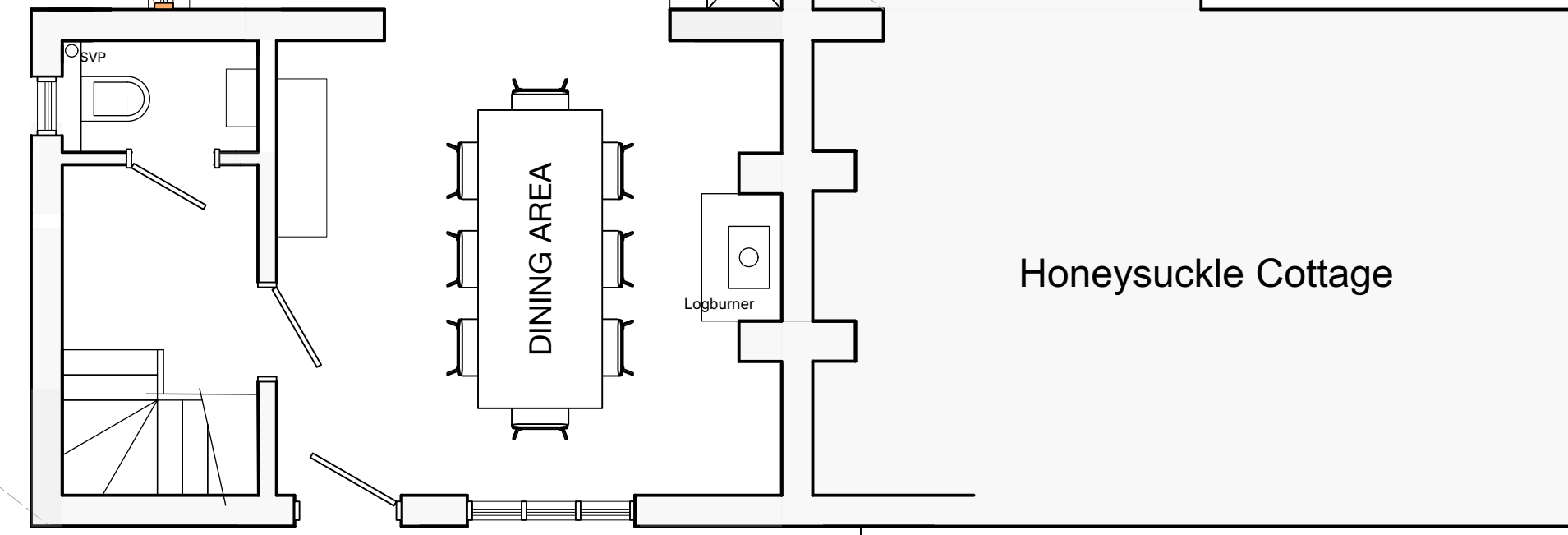

STANFORD PARTNERSHIP  
Architectural Design & Planning  
The Cottage  
School Lane  
Colston Bassett  
NG12 3FD  
07841 158957  
info@stanfordpartnership.co.uk

Date  
15th August 2023  
Drawing Title  
Layout Plan  
Scale  
1:50 @ A1  
Drawing No.  
340/02A  
Project  
Proposed Extension  
Sunset Cottage  
Client  
Lucy Roylance

