

RIVER

SMITE

Paving

- Sawn Kandla Grey Smooth Indian Sandstone Paving
22mm thick honed 900x600mm Single Size
- Gravel Paths and Parking Court
Rolled Breedon gravel
- Block paving to Highway Access
Sorrento tumbled concrete setts in grey

- Tree Planting**
- T1 Scots Pine to be removed
 - T2 Leylandii to be removed
 - T3 Prunus domestica - Plum to be removed
 - T4 Juglans regia - Common Walnut 3m
 - T5 Fagus sylvatica Dawyck - Beech 5m
 - T6 Tilia cordata Greenspire - Lime 5m
 - T7 Tilia cordata Greenspire - Lime 5m
 - T8 Tilia cordata Greenspire - Lime 5m
 - T9 Betula utilis - Silver Birch 4m
 - T10 Betula utilis - Silver Birch 4m
 - T11 Betula utilis - Silver Birch 4m
 - T12 Betula utilis multi stem - Silver Birch 2.5m
 - T13 Fagus sylvatica hetero phyllia Aspenfolia - Fern leaf Beech 3m
 - T14 Fagus sylvatica - Common Beech 3m
 - T15 Malus domestica - Bramley Apple - 2m
 - T16 Malus domestica - Bramley Apple - 2m
 - T17 Malus sylvestris - Crab Apple 2m
 - T18 Pyrus communis Conference - Pear 2m
 - T19 Prunus domestica Victoria - Plum 2m

Paddock

Paddock

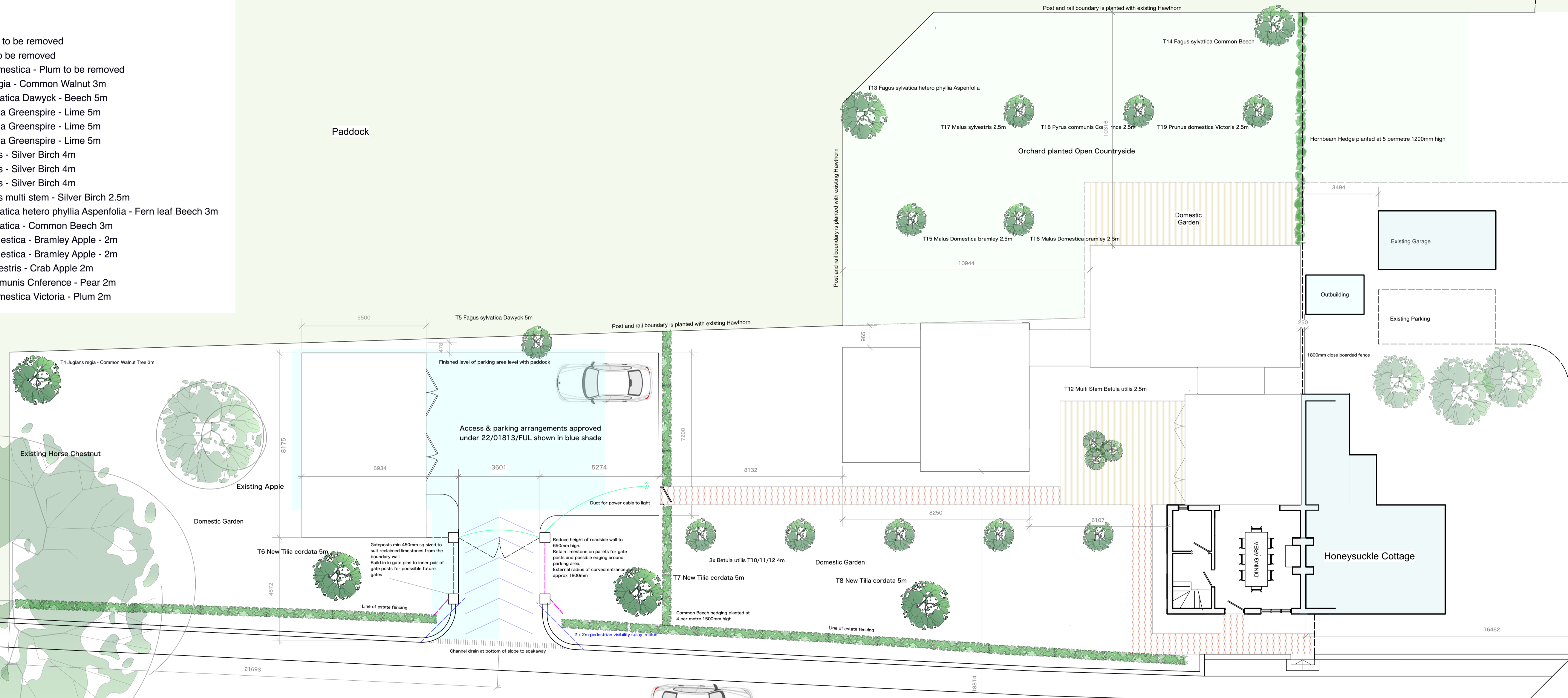

STANFORD PARTNERSHIP
 Architectural Design & Planning
 The Cottage
 School Lane
 Colston Bassett
 NG12 3FD
 07841 158957
 info@stanfordpartnership.co.uk

Date
15th August 2023

Drawing Title
Site layout / Landscape

Scale
1:200 @ A3

Drawing No
340/07

Project
Proposed Extension
Sunset Cottage

Client
Lucy Roylance

CHURCHGATE

Paynes Cottage