

FARRANS A CBM COMPANY | **ATKINS** Member of the SNC-Lavalin Group | **Atkins Limited** Chadwick House, Birchwood Park, Warrington, WA3 6AE Direct: 01925 238319

LEGEND:

- PLANNING BOUNDARY
- WORKING BOUNDARY
- WATERCOURSE
- PROPOSED PIPE ROUTE
- PUBLIC RIGHT OF WAY
- TREE
- L.V.
- A.V.
- W.O.
- SETTING OUT POINT
- ELECTRIC POLE
- HAZARD IDENTIFIER
- CLAY STANK

EXISTING SERVICES:

- W-WATER MAIN
- SSE-SEWER MAIN
- HV-ELECTRIC-HV
- HV-ELECTRIC-HV OVERHEAD
- LV-ELECTRIC-LV
- LV-ELECTRIC-LV OVERHEAD
- E-ELECTRIC
- BTR-BT UNDERGROUND
- T-BT OVERHEAD
- VM-BT-VIRGIN MEDIA
- LPG-GAS-LOW PRESSURE
- MPG-GAS-MEDIUM PRESSURE
- SWS-STORM WATER MAIN
- SL-STREET LIGHT CABLE
- GAS WORKING SAFETY ZONE
- POWER LINE SAFETY ZONE

REFERENCE:
 SZ14-T15A-PR1-M1-001-DWG-CST-G04-029: GENERAL NOTES / REFERENCES
 40018-001-DWG-CST-G02-001: FLANGE MANAGEMENT DRAWING

SAFETY, HEALTH AND ENVIRONMENTAL INFORMATION

In addition to the hazards/risks normally associated with the types of work detailed on this drawing, note the following:

CONSTRUCTION
 REFER DRA DOCUMENT NO. 40018_001_DOC_C01_001.

MAINTENANCE/CLEANING
 REFER DRA DOCUMENT NO. 40018_001_DOC_C01_001.

DECOMMISSIONING/DEMOLITION
 REFER DRA DOCUMENT NO. 40018_001_DOC_C01_001.

It is assumed that all works will be carried out by a competent contractor working, where appropriate, to an approved method statement

Steel / Ductile Iron Pipes PN16 to seal at 16barg						
Gasket Specification	DN100	DN300	DN600	DN700	DN800	DN900
Torque setting (Nm)	49	160	480	467	534	600
C.O.F.	0.120					
Torque sequence	As per Drg: 40018-001-DWG-CST-G02-001 Bolt Specification Grade 4.6					

PLAN
SCALE 1:1000

(*) - DENOTES SURVEY REQUIRED. REFER TO NOTE 4 FROM GENERAL NOTES.

LARTINGTON TO WHORLEY SETTING OUT POINTS

10000	409943.929	517121.209
10040	409970.780	517091.560
10080	409997.631	517061.912
10120	410024.482	517032.263
10160	410051.333	517002.615
10200	410078.184	516972.967
10240	410105.035	516943.318
10280	410131.886	516913.670
10320	410165.768	516902.534
10360	410205.531	516906.880
10400	410245.294	516911.227
10440	410284.402	516906.424
10480	410323.138	516896.449

HORIZONTAL BEND

SOP NO.	EASTING	NORTHING
LW-H034	410144.115	516900.167
LW-H035	410259.655	516912.796

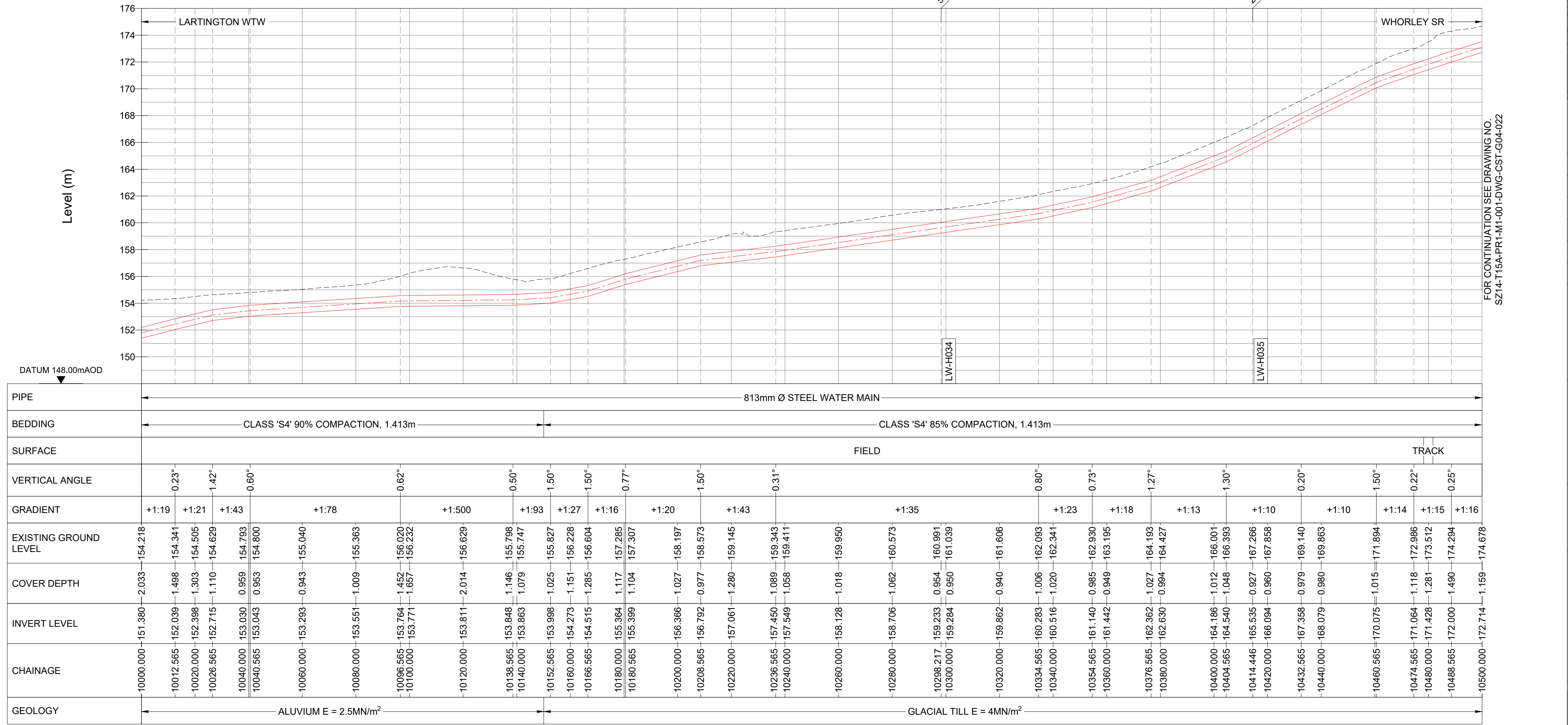

LONGITUDINAL SECTION
HORIZONTAL SCALE 1:1000 VERTICAL SCALE 1:200

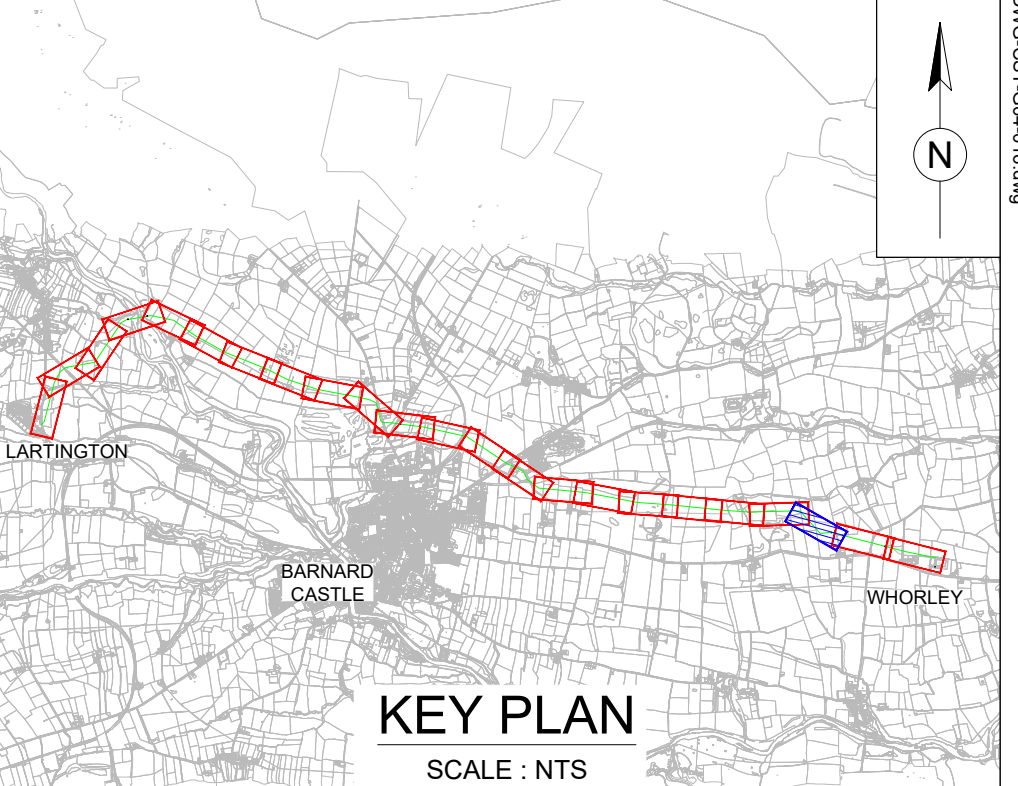
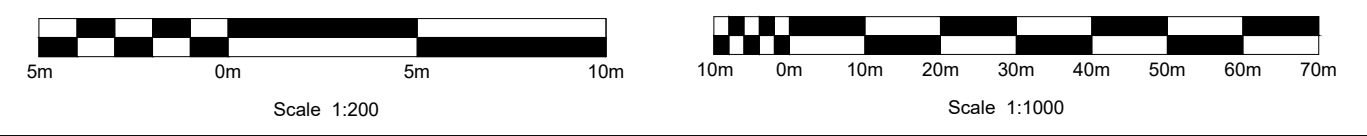

KEY PLAN
SCALE : NTS

Drawing Status: FOR REVIEW BY LEAD APPOINTED PARTY

Suitability: S4

Rev.	Description	Date	Drawn	Chk'd	App'd
P04	FOR REVIEW	20.11.2023	AJ	RH	SK
P03	FOR REVIEW	18.09.2023	AJ	RH	SK
P02	FOR REVIEW	26.07.2023	AJ	RH	SK
P01	REVIEW AND COMMENTS	25.04.2023	AJ	SM	SK

Note:-
 IF THIS DRAWING IS FOUND TO BE IN ANY WAY INACCURATE, PLEASE ADVISE THE RECORD OFFICE IMMEDIATELY AND COMPLETE AN AMENDMENT FORM.



CONTRACTOR: FARRANS
REF. NO.: WN019/0205-4.11
I.D. PROJECT NO.: WN019/0205

Drawing Title:
 TEES STRATEGIC TRANSFER MAIN
 LARTINGTON WTW TO WHORLEY SR
 PLAN AND LONGITUDINAL SECTION

Dwg No:
 SZ14-T15A-PR1-M1-001-DWG-CST-G04-021

Sheet:	Date:	Sheet:	Scale:	Rev No:
21 OF 23	20.11.2023	A1	AS SHOWN	P04