

PLAN
SCALE 1:1000

SAFETY, HEALTH AND ENVIRONMENTAL INFORMATION
 In addition to the hazards/risks normally associated with the types of work detailed on this drawing, note the following:

CONSTRUCTION
 REFER DRA DOCUMENT NO. 40018_001_DOC_C01_001.

MAINTENANCE/CLEANING
 REFER DRA DOCUMENT NO. 40018_001_DOC_C01_001.

DECOMMISSIONING/DEMOLITION
 REFER DRA DOCUMENT NO. 40018_001_DOC_C01_001.

It is assumed that all works will be carried out by a competent contractor working, where appropriate, to an approved method statement

(*) - DENOTES SURVEY REQUIRED. REFER TO NOTE 4 FROM GENERAL NOTES.

Gasket Specification	Steel / Ductile Iron Pipes PN16 to seal at 16barg					
	DN100	DN300	DN600	DN700	DN800	DN900
Torque setting (Nm)	49	160	480	467	534	600
C.O.F.	0.120					
Torque sequence	As per Drg: 40018-001-DWG-CST-G02-001 Bolt Specification Grade 4.6					

FARRANS A CBM COMPANY
ATKINS Member of the SNC-Lavalin Group
Atkins Limited
 Chadwick House, Birchwood Park, Warrington, WA3 6AE
 Direct: 01925 238319

LEGEND:

- PLANNING BOUNDARY
- WORKING BOUNDARY
- WATERCOURSE
- PROPOSED PIPE ROUTE
- PUBLIC RIGHT OF WAYS
- TREE
- L.V.
- A.V.
- W.O.
- SETTING OUT POINT
- ELECTRIC POLE
- HAZARD IDENTIFIER
- CLAY STANK

EXISTING SERVICES:

- W WATER MAIN
- SSE SEWER MAIN
- HV ELECTRIC-HV
- HV OVERHEAD ELECTRIC-HV OVERHEAD
- LV ELECTRIC-LV
- LV OVERHEAD ELECTRIC-LV OVERHEAD
- E ELECTRIC LINE
- BTR BT UNDERGROUND
- T BT OVERHEAD
- VM BT-VIRGIN MEDIA
- LPG GAS-LOW PRESSURE
- MPG GAS-MEDIUM PRESSURE
- SWS STORM WATER MAIN
- SL STREET LIGHT CABLE
- GAS WORKING SAFETY ZONE
- POWER LINE SAFETY ZONE

REFERENCE:
 SZ14-T15A-PR1-M3-001-DWG-CST-G04-034: GENERAL NOTES / REFERENCES
 40018-001-DWG-CST-G02-001: FLANGE MANAGEMENT DRAWING

WHORLEY TO SHILDON SETTING OUT POINTS

CHAINAGE (m)	EASTING	NORTHING
4520	415725.550	517944.925
4560	415742.348	517980.635
4600	415776.746	518001.051
4640	415811.143	518021.467
4680	415845.540	518041.884
4720	415879.938	518062.300
4760	415915.243	518081.072
4800	415950.842	518099.313
4840	415986.441	518117.554
4880	416022.039	518135.794
4920	416057.638	518154.035
4960	416093.237	518172.276
5000	416128.836	518190.517

WHORLEY TO LONG NEWTON SETTING OUT POINTS

CHAINAGE (m)	EASTING	NORTHING
4520	415723.934	517933.277
4560	415739.354	517970.185
4600	415770.207	517993.682
4640	415804.604	518014.098
4680	415839.002	518034.514
4720	415873.399	518054.930
4760	415908.425	518074.208
4800	415944.024	518092.449
4840	415979.623	518110.689
4880	416015.222	518128.930
4920	416050.820	518147.171
4960	416086.418	518165.412
5000	416122.018	518183.652

HORIZONTAL BEND

SOP NO.	EASTING	NORTHING
WS-H018	415739.848	517979.151
WS-H019	415888.347	518067.291
WL-H026	415742.233	517977.078
WL-H027	415889.798	518064.663

AIRVALVE

SOP NO.	EASTING	NORTHING
WS-AV-09	415875.662	518059.762
WL-AV-09	415877.193	518057.182

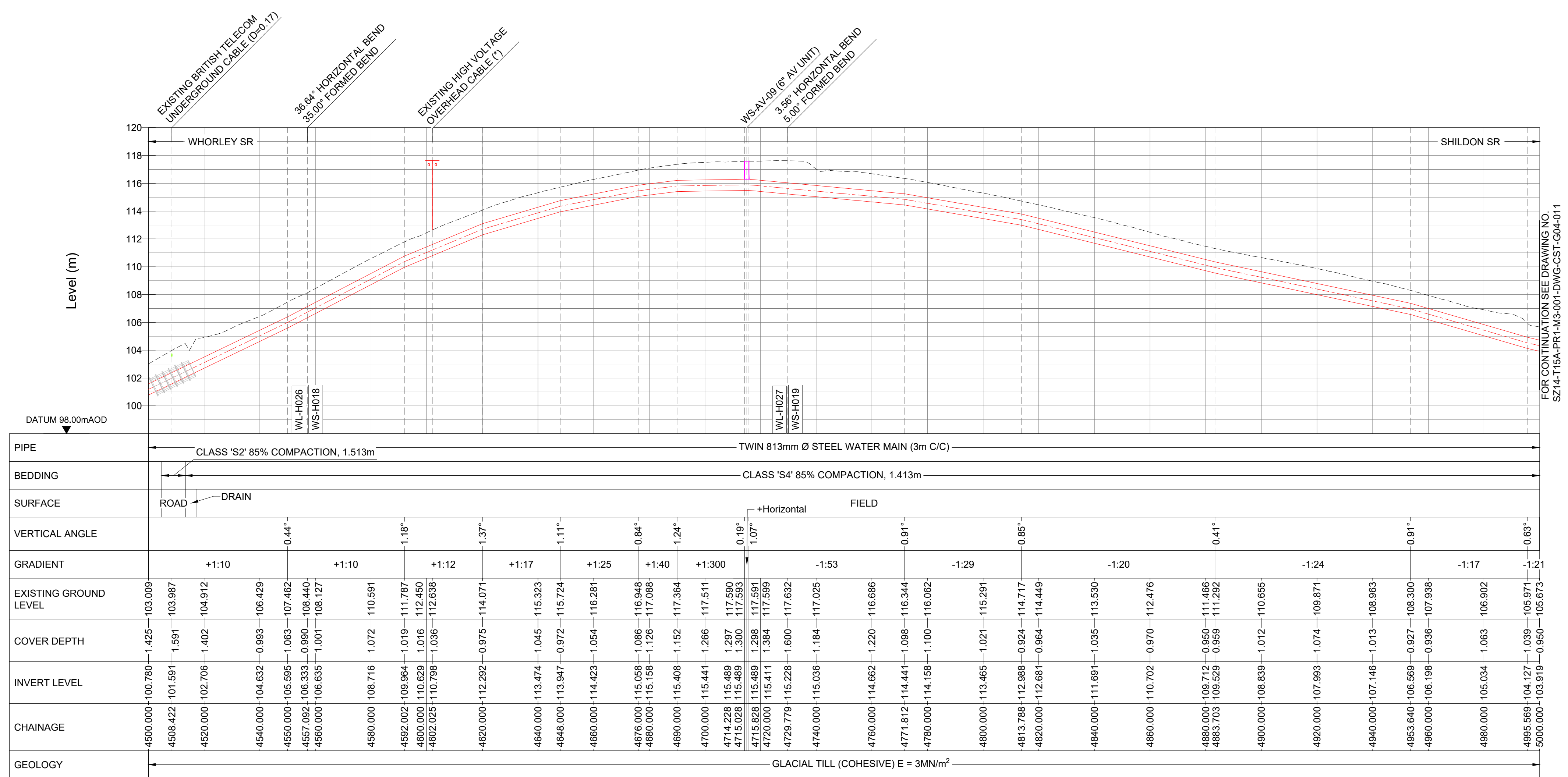

LONGITUDINAL SECTION
 HORIZONTAL SCALE 1:1000 VERTICAL SCALE 1:200

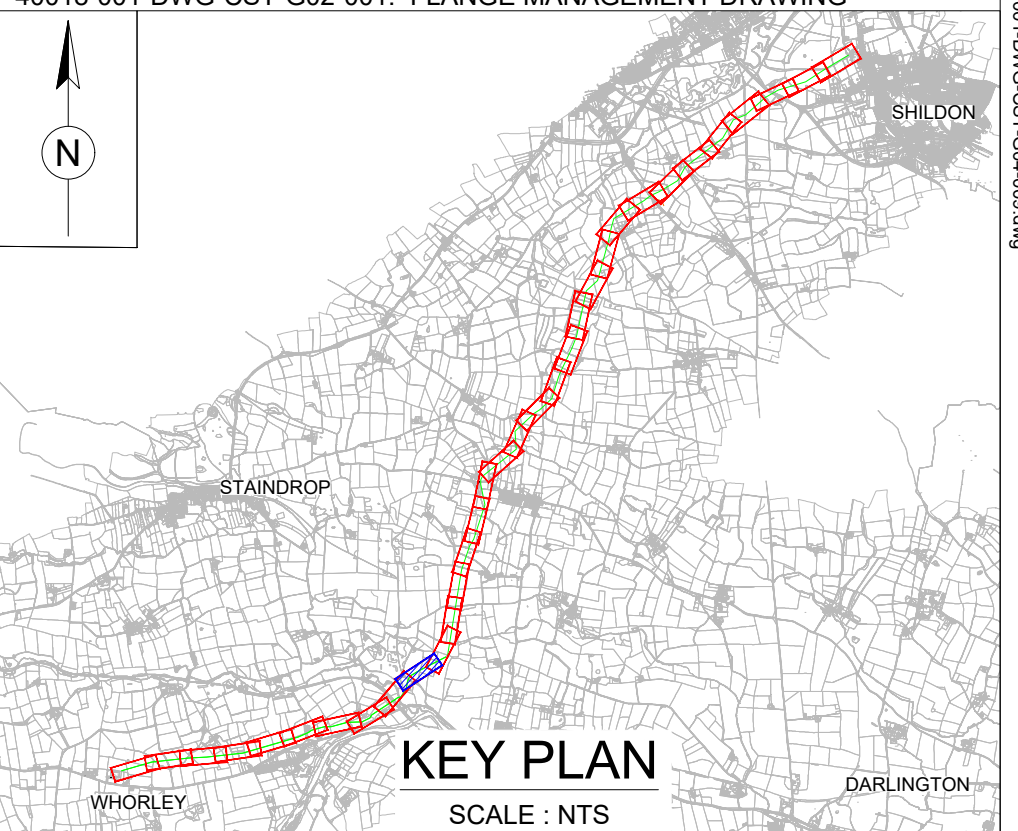
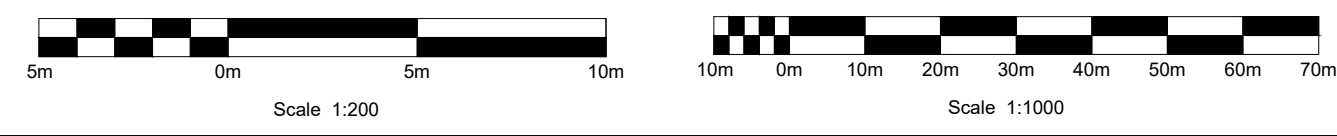

KEY PLAN
SCALE : NTS

Drawing Status:
FOR REVIEW BY LEAD APPOINTED PARTY

Suitability:
S4

P06	FOR REVIEW	17.11.2023	AJ	RH	SK
P05	FOR REVIEW	10.10.2023	AJ	RH	SK
P04	FOR REVIEW	18.09.2023	AJ	RH	SK
P03	FOR REVIEW	26.07.2023	AJ	RH	SK
P02	FOR REVIEW	30.06.2023	AJ	RH	SK

Note:-
 IF THIS DRAWING IS FOUND TO BE IN ANY WAY INACCURATE, PLEASE ADVISE THE RECORD OFFICE IMMEDIATELY AND COMPLETE AN AMENDMENT FORM.



CONTRACTOR: FARRANS
REF. NO.: WN019/0205-4.11
I.D. PROJECT NO.: WN019/0205

Drawing Title:
 TEES STRATEGIC TRANSFER MAIN
 WHORLEY SR TO SHILDON SR
 PLAN AND LONGITUDINAL SECTION

Dwg No:
 SZ14-T15A-PR1-M3-001-DWG-CST-G04-010

Sheet:	Date:	Sheet:	Scale:	Rev No:
10 OF 33	17.11.2023	A1	AS SHOWN	P06