

Gasket Specification	Steel / Ductile Iron Pipes PN16 to seal at 16 barg					
	DN100	DN300	DN600	DN700	DN800	DN900
Torque setting (Nm)	49	160	480	467	534	600
C.O.F.	0.120					
Torque sequence	As per Drg: 40018-001-DWG-CST-G02-001 Bolt Specification Grade 4.6					

FARRANS A CBM COMPANY

ATKINS Member of the SNC-Lavalin Group

Atkins Limited
Chadwick House, Birchwood Park, Warrington, WA3 6AE
Direct: 01925 238319

LEGEND:

- PLANNING BOUNDARY
- WORKING BOUNDARY
- WATERCOURSE
- PROPOSED PIPE ROUTE
- PUBLIC RIGHT OF WAYS
- TREE
- L.V.
- A.V.
- W.O.
- SETTING OUT POINT
- ELECTRIC POLE
- HAZARD IDENTIFIER
- CLAY STANK

EXISTING SERVICES:

- W WATER MAIN
- SSE SEWER MAIN
- HV ELECTRIC-HV
- HV OVERHEAD ELECTRIC-HV OVERHEAD
- LV ELECTRIC-LV
- LV OVERHEAD ELECTRIC-LV OVERHEAD
- E ELECTRIC LINE
- BTR BT UNDERGROUND
- T BT OVERHEAD
- VM BT-VIRGIN MEDIA
- LPG GAS-LOW PRESSURE
- MPG GAS-MEDIUM PRESSURE
- SWS STORM WATER MAIN
- SL STREET LIGHT CABLE
- GAS WORKING SAFETY ZONE
- POWER LINE SAFETY ZONE

REFERENCE:
SZ14-T15A-PR1-M3-001-DWG-CST-G04-034: GENERAL NOTES / REFERENCES
40018-001-DWG-CST-G02-001: FLANGE MANAGEMENT DRAWING

SAFETY, HEALTH AND ENVIRONMENTAL INFORMATION

In addition to the hazards/risks normally associated with the types of work detailed on this drawing, note the following:

CONSTRUCTION
REFER DRA DOCUMENT NO.40018_001_DOC_C01_001.

MAINTENANCE/CLEANING
REFER DRA DOCUMENT NO. 40018_001_DOC_C01_001.

DECOMMISSIONING/DEMOLITION
REFER DRA DOCUMENT NO. 40018_001_DOC_C01_001.

It is assumed that all works will be carried out by a competent contractor working, where appropriate, to an approved method statement

WHORLEY TO SHILDON SETTING OUT POINTS

CHAINAGE (m)	EASTING	NORTHING
7520	416804.565	520535.517
7560	416796.460	520574.687
7600	416788.355	520613.857
7640	416780.250	520653.028
7680	416772.144	520692.198
7720	416764.038	520731.368
7760	416755.932	520770.538
7800	416747.826	520809.708
7840	416739.720	520848.878
7880	416731.614	520888.048
7920	416723.508	520927.218
7960	416715.402	520966.388
8000	416707.296	521005.558

HORIZONTAL BEND

SOP NO.	EASTING	NORTHING
WS-H025	416763.284	520735.015
WS-H026	416762.788	520799.407
WS-H027	416783.271	520850.084

AIRVALVE

SOP NO.	EASTING	NORTHING
WS-AV-013	416780.072	520653.885

WASHOUT

SOP NO.	EASTING	NORTHING
WS-WO-012	416762.894	520785.629

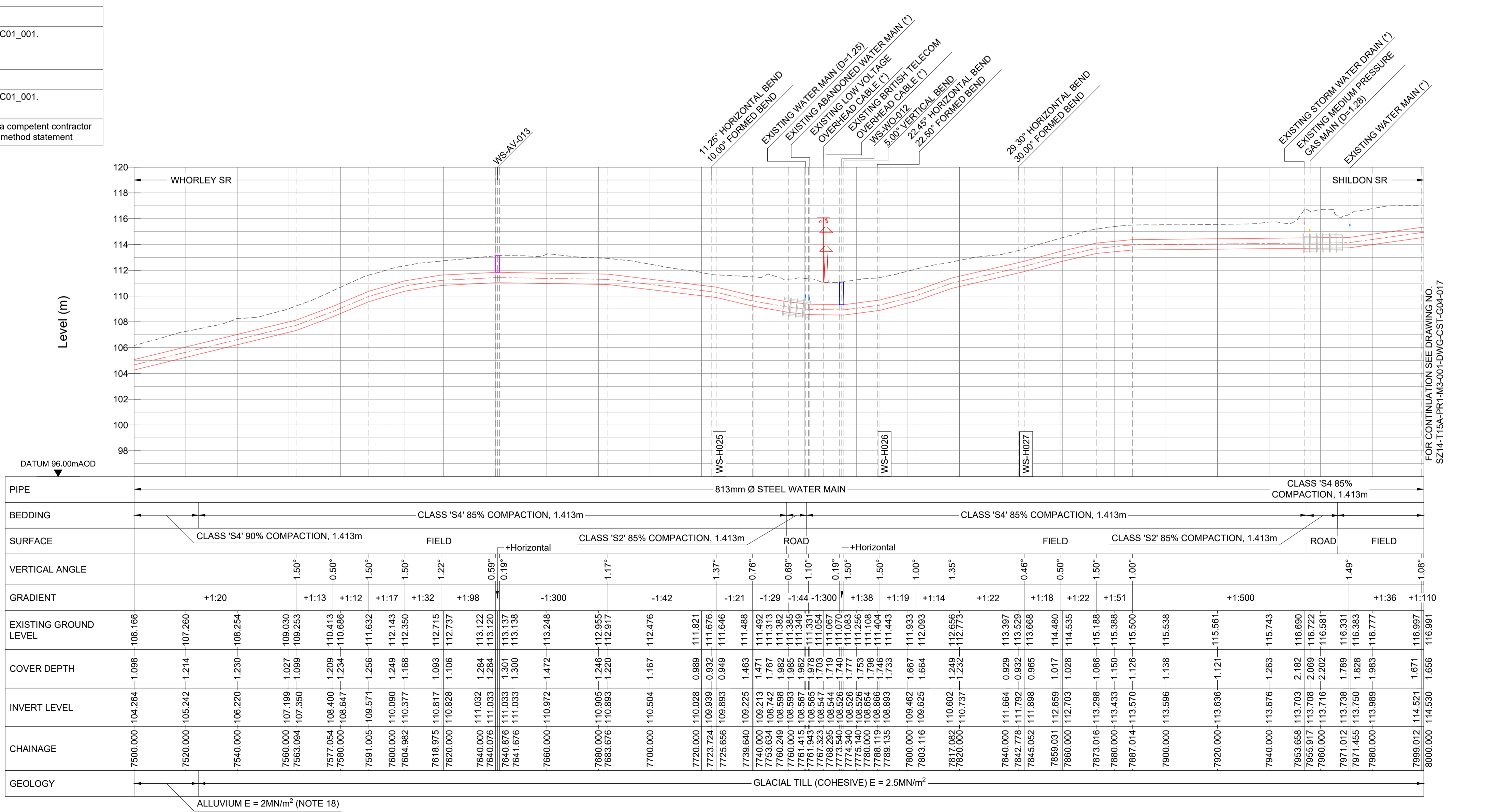

GRADIENT

CHAINAGE	GRADIENT
7500.000	+1:20
7560.000	+1:13
7620.000	+1:12
7680.000	+1:17
7740.000	+1:32
7800.000	+1:98
7860.000	-1:300
7920.000	-1:42
7980.000	-1:21
8000.000	-1:29

LONGITUDINAL SECTION
HORIZONTAL SCALE 1:1000 VERTICAL SCALE 1:200

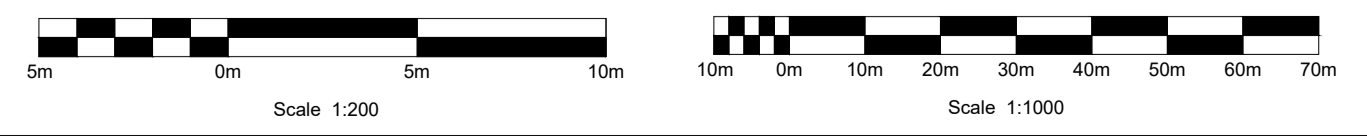

Drawing Status: FOR REVIEW BY LEAD APPOINTED PARTY

Suitability: S4

Rev.	Description	Date	Drawn	Chk'd	App'd
P06	FOR REVIEW	17.11.2023	AJ	RH	SK
P05	FOR REVIEW	10.10.2023	AJ	RH	SK
P04	FOR REVIEW	18.09.2023	AJ	RH	SK
P03	FOR REVIEW	26.07.2023	AJ	RH	SK
P02	FOR REVIEW	30.06.2023	AJ	RH	SK

Note:-
IF THIS DRAWING IS FOUND TO BE IN ANY WAY INACCURATE, PLEASE ADVISE THE RECORD OFFICE IMMEDIATELY AND COMPLETE AN AMENDMENT FORM.



CONTRACTOR: FARRANS
REF. NO.: WN019/0205-4.11
I.D. PROJECT NO.: WN019/0205

Drawing Title:
TEES STRATEGIC TRANSFER MAIN
WHORLEY SR TO SHILDON SR
PLAN AND LONGITUDINAL SECTION

Dwg No: SZ14-T15A-PR1-M3-001-DWG-CST-G04-016

Sheet:	Date:	Sheet:	Scale:	Rev No:
16 OF 33	17.11.2023	A1	AS SHOWN	P06