

SOP NO.	EASTING	NORTHING
WS-WO-06	415440.268	517585.776
WS-WO-07	415671.346	517766.765
WL-WO-06	415441.901	517583.259
WL-WO-07	415680.432	517760.565

SOP NO.	EASTING	NORTHING
WS-V007	415421.984	517573.670
WS-V008	415431.791	517580.163
WS-V009	415571.385	517672.591
WS-V010	415575.173	517673.306
WS-V011	415605.094	517678.955
WS-V012	415608.257	517679.552
WS-V013	415676.379	517774.142
WS-V014	415690.587	517797.900
WS-V015	415704.175	517880.794

SOP NO.	EASTING	NORTHING
WS-V016	415705.094	517678.955
WS-V017	415708.257	517679.552
WS-V018	415776.379	517774.142
WS-V019	415790.587	517797.900
WS-V020	415804.175	517880.794

SOP NO.	EASTING	NORTHING
WS-V021	415805.094	517678.955
WS-V022	415808.257	517679.552
WS-V023	415876.379	517774.142
WS-V024	415890.587	517797.900
WS-V025	415904.175	517880.794

SOP NO.	EASTING	NORTHING
WS-V026	415905.094	517678.955
WS-V027	415908.257	517679.552
WS-V028	415976.379	517774.142
WS-V029	415990.587	517797.900
WS-V030	416004.175	517880.794

SOP NO.	EASTING	NORTHING
WS-V031	416005.094	517678.955
WS-V032	416008.257	517679.552
WS-V033	416076.379	517774.142
WS-V034	416090.587	517797.900
WS-V035	416104.175	517880.794

SOP NO.	EASTING	NORTHING
WS-V036	416105.094	517678.955
WS-V037	416108.257	517679.552
WS-V038	416176.379	517774.142
WS-V039	416190.587	517797.900
WS-V040	416204.175	517880.794

SOP NO.	EASTING	NORTHING
WS-V041	416205.094	517678.955
WS-V042	416208.257	517679.552
WS-V043	416276.379	517774.142
WS-V044	416290.587	517797.900
WS-V045	416304.175	517880.794

SOP NO.	EASTING	NORTHING
WS-V046	416305.094	517678.955
WS-V047	416308.257	517679.552
WS-V048	416376.379	517774.142
WS-V049	416390.587	517797.900
WS-V050	416404.175	517880.794

SOP NO.	EASTING	NORTHING
WS-V051	416405.094	517678.955
WS-V052	416408.257	517679.552
WS-V053	416476.379	517774.142
WS-V054	416490.587	517797.900
WS-V055	416504.175	517880.794

SOP NO.	EASTING	NORTHING
WS-V056	416505.094	517678.955
WS-V057	416508.257	517679.552
WS-V058	416576.379	517774.142
WS-V059	416590.587	517797.900
WS-V060	416604.175	517880.794

SOP NO.	EASTING	NORTHING
WS-V061	416605.094	517678.955
WS-V062	416608.257	517679.552
WS-V063	416676.379	517774.142
WS-V064	416690.587	517797.900
WS-V065	416704.175	517880.794

SOP NO.	EASTING	NORTHING
WS-V066	416705.094	517678.955
WS-V067	416708.257	517679.552
WS-V068	416776.379	517774.142
WS-V069	416790.587	517797.900
WS-V070	416804.175	517880.794

SOP NO.	EASTING	NORTHING
WS-V071	416805.094	517678.955
WS-V072	416808.257	517679.552
WS-V073	416876.379	517774.142
WS-V074	416890.587	517797.900
WS-V075	416904.175	517880.794

SOP NO.	EASTING	NORTHING
WS-V076	416905.094	517678.955
WS-V077	416908.257	517679.552
WS-V078	416976.379	517774.142
WS-V079	416990.587	517797.900
WS-V080	417004.175	517880.794

SOP NO.	EASTING	NORTHING
WS-V081	417005.094	517678.955
WS-V082	417008.257	517679.552
WS-V083	417076.379	517774.142
WS-V084	417090.587	517797.900
WS-V085	417104.175	517880.794

SOP NO.	EASTING	NORTHING
WS-V086	417105.094	517678.955
WS-V087	417108.257	517679.552
WS-V088	417176.379	517774.142
WS-V089	417190.587	517797.900
WS-V090	417204.175	517880.794

SOP NO.	EASTING	NORTHING
WS-V091	417205.094	517678.955
WS-V092	417208.257	517679.552
WS-V093	417276.379	517774.142
WS-V094	417290.587	517797.900
WS-V095	417304.175	517880.794

SOP NO.	EASTING	NORTHING
WS-V096	417305.094	517678.955
WS-V097	417308.257	517679.552
WS-V098	417376.379	517774.142
WS-V099	417390.587	517797.900
WS-V100	417404.175	517880.794

SOP NO.	EASTING	NORTHING
WS-V101	417405.094	517678.955
WS-V102	417408.257	517679.552
WS-V103	417476.379	517774.142
WS-V104	417490.587	517797.900
WS-V105	417504.175	517880.794

SOP NO.	EASTING	NORTHING
WS-V106	417505.094	517678.955
WS-V107	417508.257	517679.552
WS-V108	417576.379	517774.142
WS-V109	417590.587	517797.900
WS-V110	417604.175	517880.794

SOP NO.	EASTING	NORTHING
WS-V111	417605.094	517678.955
WS-V112	417608.257	517679.552
WS-V113	417676.379	517774.142
WS-V114	417690.587	517797.900
WS-V115	417704.175	517880.794

SOP NO.	EASTING	NORTHING
WS-V116	417705.094	517678.955
WS-V117	417708.257	517679.552
WS-V118	417776.379	517774.142
WS-V119	417790.587	517797.900
WS-V120	417804.175	517880.794

SOP NO.	EASTING	NORTHING
WS-V121	417805.094	517678.955
WS-V122	417808.257	517679.552
WS-V123	417876.379	517774.142
WS-V124	417890.587	517797.900
WS-V125	417904.175	517880.794

SOP NO.	EASTING	NORTHING
WS-V126	417905.094	517678.955
WS-V127	417908.257	517679.552
WS-V128	417976.379	517774.142
WS-V129	417990.587	517797.900
WS-V130	418004.175	517880.794

SOP NO.	EASTING	NORTHING
WS-V131	418005.094	517678.955
WS-V132	418008.257	517679.552
WS-V133	418076.379	517774.142
WS-V134	418090.587	517797.900
WS-V135	418104.175	517880.794

SOP NO.	EASTING	NORTHING
WS-V136	418105.094	517678.955
WS-V137	418108.257	517679.552
WS-V138	418176.379	517774.142
WS-V139	418190.587	517797.900
WS-V140	418204.175	517880.794

SOP NO.	EASTING	NORTHING
WS-V141	418205.094	517678.955
WS-V142	418208.257	517679.552
WS-V143	418276.379	517774.142
WS-V144	418290.587	517797.900
WS-V145	418304.175	517880.794

SOP NO.	EASTING	NORTHING
WS-V146	418305.094	517678.955
WS-V147	418308.257	517679.552
WS-V148	418376.379	517774.142
WS-V149	418390.587	517797.900
WS-V150	418404.175	517880.794

SOP NO.	EASTING	NORTHING
WS-V151	418405.094	517678.955
WS-V152	418408.257	517679.552
WS-V153	418476.379	517774.142
WS-V154	418490.587	517797.900
WS-V155	418504.175	517880.794

SOP NO.	EASTING	NORTHING
WS-V156	418505.094	517678.955
WS-V157	418508.257	517679.552
WS-V158	418576.379	517774.142
WS-V159	418590.587	517797.900
WS-V160	418604.175	517880.794

Gasket Specification	DN100	DN300	DN600	DN700	DN800	DN900
Rubber encased steel core (Type G-S-S)	49	160	480	467	534	600
Torque setting (Nm)	As per Drg: 40018-001-DWG-CST-G02-001					
C.O.F.	0.120					
Torque sequence	As per Drg: 40018-001-DWG-CST-G04-001					

SAFETY, HEALTH AND ENVIRONMENTAL INFORMATION
 In addition to the hazards/risks normally associated with the types of work detailed on this drawing, note the following:

CONSTRUCTION
 REFER DRA DOCUMENT NO.40018_001_DOC_C01_001.

MAINTENANCE/CLEANING
 REFER DRA DOCUMENT NO. 40018_001_DOC_C01_001.

DECOMMISSIONING/DEMOLITION
 REFER DRA DOCUMENT NO. 40018_001_DOC_C01_001.

It is assumed that all works will be carried out by a competent contractor working, where appropriate, to an approved method statement.

FARRANS A CBM COMPANY | **ATKINS** Member of the SNC-Lavalin Group

Atkins Limited
 Chadwick House, Birchwood Park, Warrington, WA3 6AE
 Direct: 01925 238319

LEGEND:

- PLANNING BOUNDARY
- WORKING BOUNDARY
- WATERCOURSE
- PROPOSED PIPE ROUTE
- PUBLIC RIGHT OF WAYS
- TREE
- L.V.
- A.V.
- W.O.
- SETTING OUT POINT
- ELECTRIC POLE
- HAZARD IDENTIFIER
- CLAY STANK

EXISTING SERVICES:

- WATER MAIN
- SEWER MAIN
- ELECTRIC-HV
- ELECTRIC-HV OVERHEAD
- ELECTRIC-LV
- ELECTRIC-LV OVERHEAD
- ELECTRIC LINE
- BT UNDERGROUND
- BT OVERHEAD
- BT-VIRGIN MEDIA
- GAS-LOW PRESSURE
- GAS-MEDIUM PRESSURE
- STORM WATER MAIN
- STREET LIGHT CABLE
- GAS WORKING SAFETY ZONE
- POWER LINE SAFETY ZONE

REFERENCE:
 SZ14-T15A-PR1-M3-001-DWG-CST-G04-034: GENERAL NOTES / REFERENCES
 40018-001-DWG-CST-G02-001: FLANGE MANAGEMENT DRAWING

(*) - DENOTES SURVEY REQUIRED. REFER TO NOTE 4 FROM GENERAL NOTES.

KEY PLAN
 SCALE: NTS

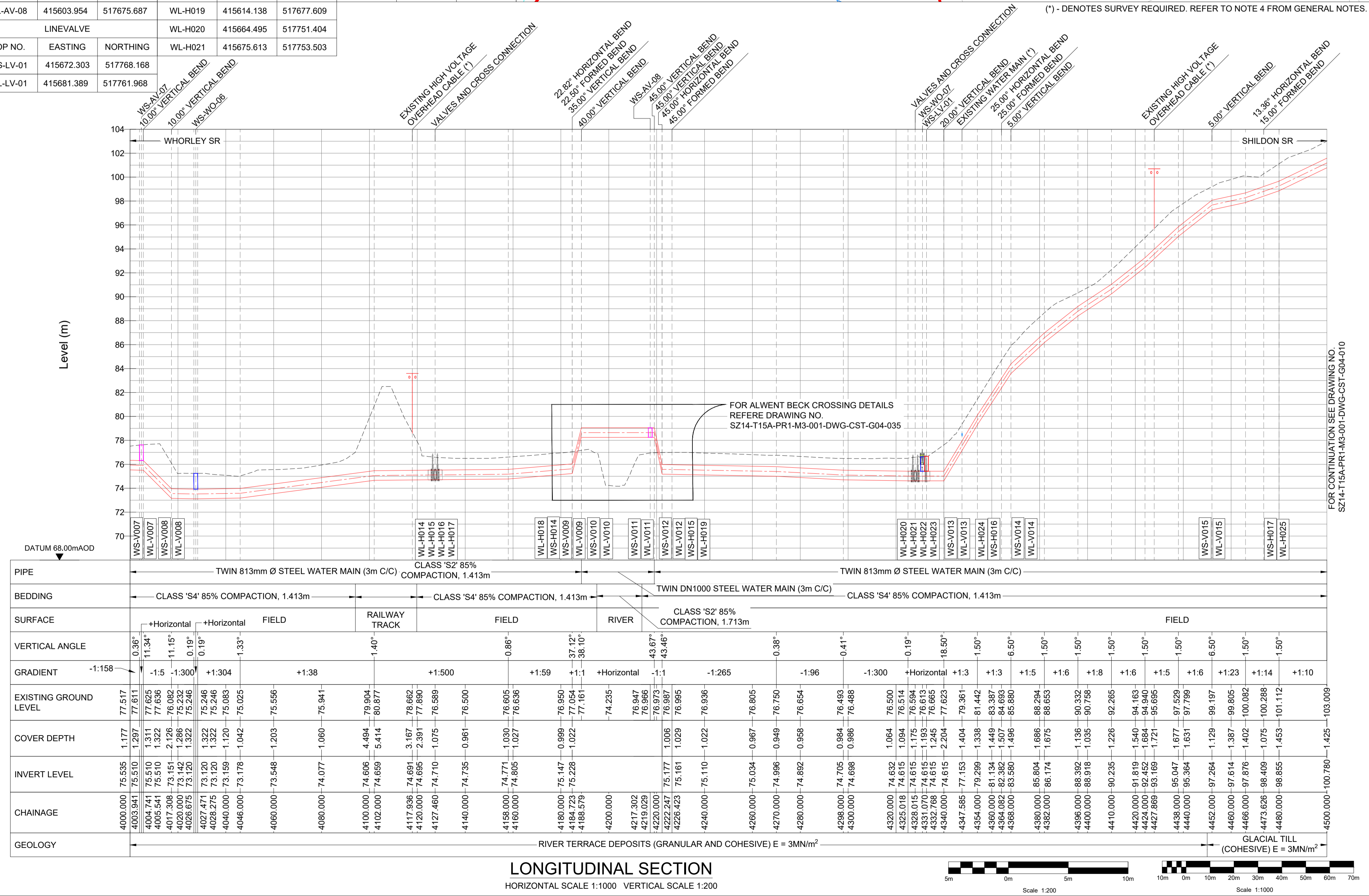

Drawing Status:
 FOR REVIEW BY LEAD APPOINTED PARTY

Suitability:
 S4

P06	FOR REVIEW	17.11.2023	AJ	RH	SK
P05	FOR REVIEW	10.10.2023	AJ	RH	SK
P04	FOR REVIEW	18.09.2023	AJ	RH	SK
P03	FOR REVIEW	26.07.2023	AJ	RH	SK
P02	FOR REVIEW	30.06.2023	AJ	RH	SK

Rev. Description Date Drawn Chk'd App'd

Note:-
 IF THIS DRAWING IS FOUND TO BE IN ANY WAY INACCURATE, PLEASE ADVISE THE RECORD OFFICE IMMEDIATELY AND COMPLETE AN AMENDMENT FORM.

NORTHUMBRIAN WATER living water

CONTRACTOR: FARRANS
REF. NO.: WN019/0205-4.11
I.D. PROJECT NO.: WN019/0205

Drawing Title:
 TEES STRATEGIC TRANSFER MAIN
 WHORLEY SR TO SHILDON SR
 PLAN AND LONGITUDINAL SECTION

Dwg No:
 SZ14-T15A-PR1-M3-001-DWG-CST-G04-009

Sheet: 9 OF 33 | **Date:** 17.11.2023 | **Sheet:** A1 | **Scale:** AS SHOWN | **Rev No:** P06

File Name: C:\Users\VA158\Documents\SINCE\EDM\2023\1651-1652-1653-1654-1655-1656-1657-1658-1659-1660-1661-1662-1663-1664-1665-1666-1667-1668-1669-1670-1671-1672-1673-1674-1675-1676-1677-1678-1679-1680-1681-1682-1683-1684-1685-1686-1687-1688-1689-1690-1691-1692-1693-1694-1695-1696-1697-1698-1699-1700-1701-1702-1703-1704