

**SAFETY, HEALTH AND ENVIRONMENTAL INFORMATION**  
 In addition to the hazards/risks normally associated with the types of work detailed on this drawing, note the following:

**CONSTRUCTION**  
 REFER DRA DOCUMENT NO. 40018\_001\_DOC\_C01\_001.

**MAINTENANCE/CLEANING**  
 REFER DRA DOCUMENT NO. 40018\_001\_DOC\_C01\_001.

**DECOMMISSIONING/DEMOLITION**  
 REFER DRA DOCUMENT NO. 40018\_001\_DOC\_C01\_001.

It is assumed that all works will be carried out by a competent contractor working, where appropriate, to an approved method statement

|                      |   |       |       |       |       |       |
|----------------------|---|-------|-------|-------|-------|-------|
|                      | Steel / Ductile Iron Pipes PN16 to seal at 16barg                     |       |       |       |       |       |
|                      | DN100   | DN300 | DN600 | DN700 | DN800 | DN900 |
| Gasket Specification | Rubber encased steel core (Type G-S-S)                                |       |       |       |       |       |
| Torque setting (Nm)  | 49  | 160   | 480   | 467   | 534   | 600   |
| C.O.F.               | 0.120   |       |       |       |       |       |
| Torque sequence      | As per Drg: 40018-001-DWG-CST-G02-001<br>Bolt Specification Grade 4.6 |       |       |       |       |       |

**FARRANS** A CBM COMPANY  
**ATKINS** Member of the SNC-Lavalin Group

**Atkins Limited**  
 Chadwick House, Birchwood Park, Warrington, WA3 6AE  
 Direct: 01925 238319

**LEGEND:**

- PLANNING BOUNDARY
- WORKING BOUNDARY
- WATERCOURSE
- PROPOSED PIPE ROUTE
- PUBLIC RIGHT OF WAY
- TREE
- L.V.
- A.V.
- W.O.
- SETTING OUT POINT
- ELECTRIC POLE
- HAZARD IDENTIFIER
- CLAY STANK

**EXISTING SERVICES:**

- WATER MAIN
- SEWER MAIN
- ELECTRIC-HV
- ELECTRIC-HV OVERHEAD
- ELECTRIC-LV
- ELECTRIC-LV OVERHEAD
- ELECTRIC
- BT UNDERGROUND
- BT OVERHEAD
- BT-VIRGIN MEDIA
- GAS-LOW PRESSURE
- GAS-MEDIUM PRESSURE
- STORM WATER MAIN
- STREET LIGHT CABLE
- GAS WORKING SAFETY ZONE
- POWER LINE SAFETY ZONE

| HORIZONTAL BEND |            |            |
|-----------------|------------|------------|
| SOP NO.         | EASTING    | NORTHING   |
| LW-H036         | 411117.202 | 516691.977 |
| LW-H037         | 411385.359 | 516636.357 |

| AIRVALVE  |            |            |
|-----------|------------|------------|
| SOP NO.   | EASTING    | NORTHING   |
| LW-AV-019 | 411090.665 | 516698.810 |
| LW-AV-020 | 411399.683 | 516634.783 |

| WASHOUT   |            |            |
|-----------|------------|------------|
| SOP NO.   | EASTING    | NORTHING   |
| LW-WO-018 | 411256.827 | 516663.017 |

| LINE VALVE |            |            |
|------------|------------|------------|
| SOP NO.    | EASTING    | NORTHING   |
| LW-LV-05   | 411459.073 | 516628.256 |

| LARTINGTON TO WHORLEY SETTING OUT POINTS |            |            |
|--|------------|------------|
| 11120                                    | 410942.920 | 516736.855 |
| 11160                                    | 410981.656 | 516726.880 |
| 11200                                    | 411020.393 | 516716.905 |
| 11240                                    | 411059.129 | 516706.931 |
| 11280                                    | 411097.865 | 516696.956 |
| 11320                                    | 411136.601 | 516686.981 |
| 11360                                    | 411175.337 | 516676.956 |

| LARTINGTON TO WHORLEY SETTING OUT POINTS |            |            |
|--|------------|------------|
| 11400                                    | 411215.150 | 516671.661 |
| 11440                                    | 411254.316 | 516663.537 |
| 11480                                    | 411293.483 | 516655.414 |
| 11520                                    | 411332.649 | 516647.290 |
| 11560                                    | 411371.816 | 516639.166 |
| 11600                                    | 411411.371 | 516633.499 |
| 11640                                    | 411451.131 | 516629.129 |

(\*) - DENOTES SURVEY REQUIRED. REFER TO NOTE 4 FROM GENERAL NOTES.

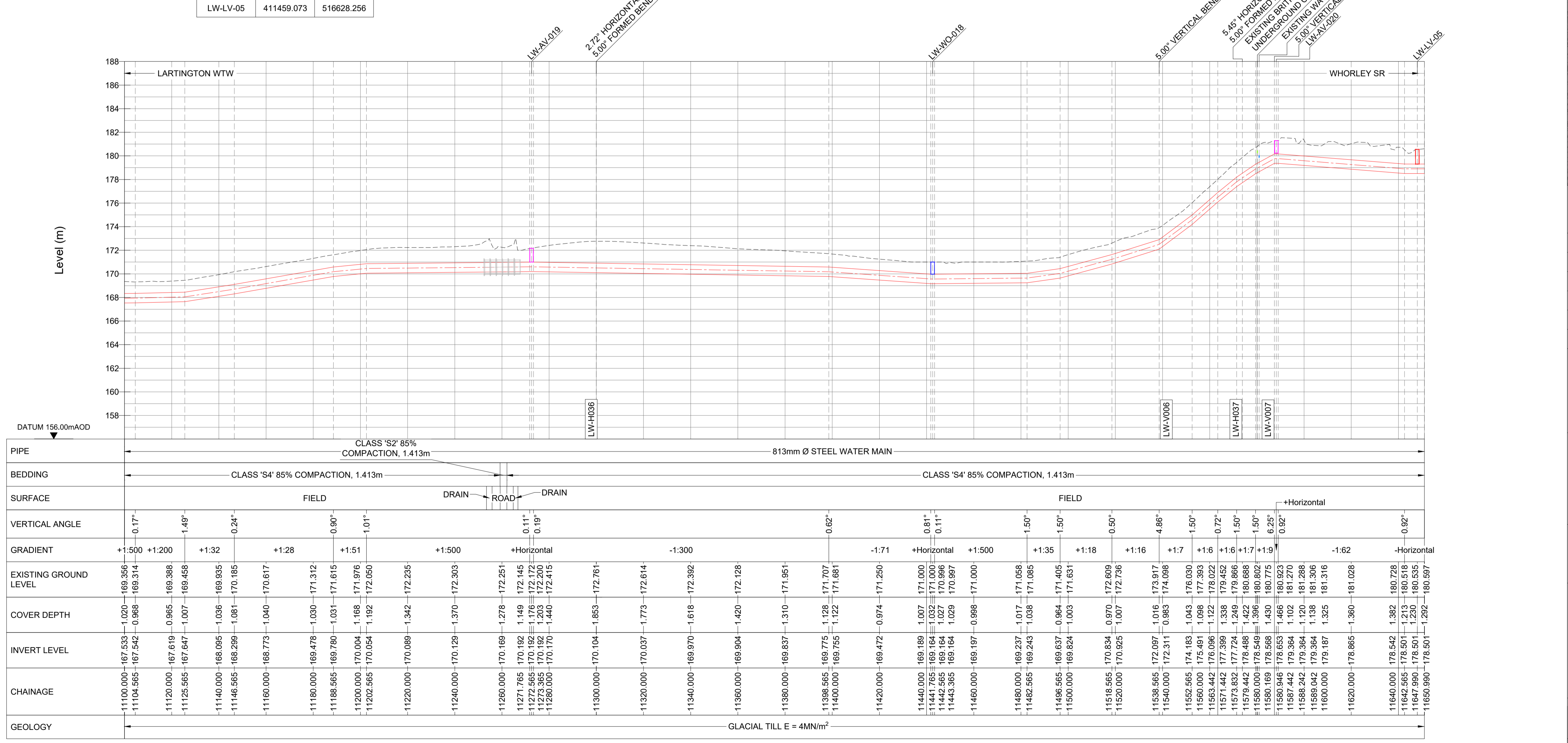

**LONGITUDINAL SECTION**  
 HORIZONTAL SCALE 1:1000 VERTICAL SCALE 1:200

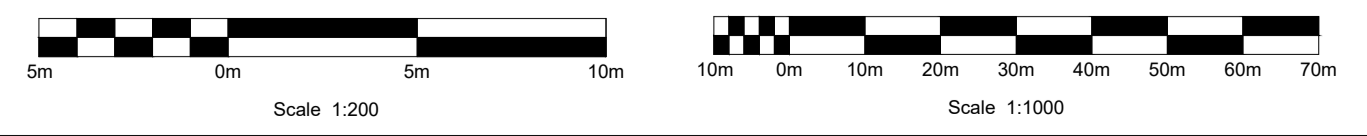

**REFERENCE:**  
 SZ14-T15A-PR1-M1-001-DWG-CST-G04-029: GENERAL NOTES / REFERENCES  
 40018-001-DWG-CST-G02-001: FLANGE MANAGEMENT DRAWING

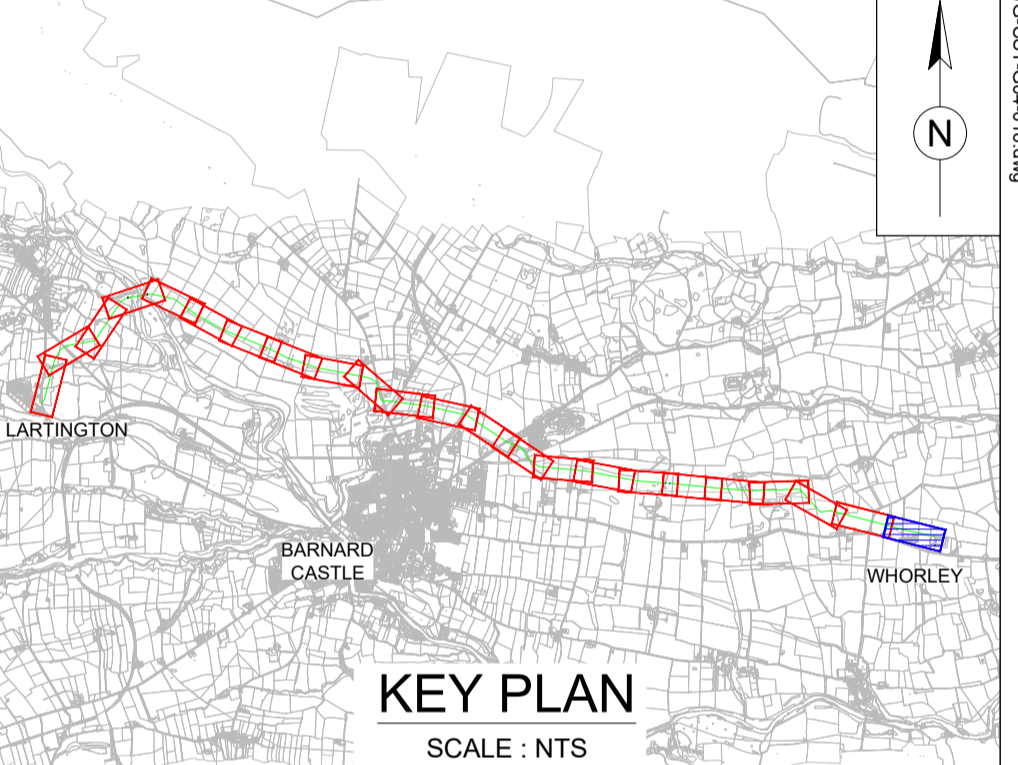

**Drawing Status:**  
 FOR REVIEW BY LEAD APPOINTED PARTY

**Suitability:**  
 S4

| Rev. | Description         | Date       | Drawn | Chk'd | App'd |
|------|---------------------|------------|-------|-------|-------|
| P04  | FOR REVIEW          | 20.11.2023 | AJ    | RH    | SK    |
| P03  | FOR REVIEW          | 18.09.2023 | AJ    | RH    | SK    |
| P02  | FOR REVIEW          | 26.07.2023 | AJ    | RH    | SK    |
| P01  | REVIEW AND COMMENTS | 25.04.2023 | AJ    | SM    | SK    |

**Note:-**  
 IF THIS DRAWING IS FOUND TO BE IN ANY WAY INACCURATE, PLEASE ADVISE THE RECORD OFFICE IMMEDIATELY AND COMPLETE AN AMENDMENT FORM.



**CONTRACTOR:** FARRANS  
**REF. NO.:** WN019/0205-4.11  
**I.D. PROJECT NO.:** WN019/0205

**Drawing Title:**  
 TEES STRATEGIC TRANSFER MAIN  
 LARTINGTON WTW TO WHORLEY SR  
 PLAN AND LONGITUDINAL SECTION

**Dwg No:**  
 SZ14-T15A-PR1-M1-001-DWG-CST-G04-023

|                        |                         |                  |                        |                    |
|------------------------|-------------------------|------------------|------------------------|--------------------|
| <b>Sheet:</b> 23 OF 23 | <b>Date:</b> 20.11.2023 | <b>Sheet:</b> A1 | <b>Scale:</b> AS SHOWN | <b>Rev No:</b> P04 |
|------------------------|-------------------------|------------------|------------------------|--------------------|