

**FARRANS** A CH2M COMPANY | **ATKINS** Member of the SNC-Lavalin Group | **Atkins Limited** Chadwick House, Birchwood Park, Warrington, WA3 6AE Direct: 01925 238319

**LEGEND:**

- PLANNING BOUNDARY
- WORKING BOUNDARY
- WATERCOURSE
- PROPOSED PIPE ROUTE
- PUBLIC RIGHT OF WAY
- TREE
- L.V.
- A.V.
- W.O.
- SETTING OUT POINT
- ELECTRIC POLE
- HAZARD IDENTIFIER
- CLAY STANK

**EXISTING SERVICES:**

- WATER MAIN
- SEWER MAIN
- ELECTRIC-HV
- ELECTRIC-HV OVERHEAD
- ELECTRIC-LV
- ELECTRIC-LV OVERHEAD
- ELECTRIC
- BT UNDERGROUND
- BT OVERHEAD
- BT-VIRGIN MEDIA
- GAS-LOW PRESSURE
- GAS-MEDIUM PRESSURE
- STORM WATER MAIN
- STREET LIGHT CABLE
- GAS WORKING SAFETY ZONE
- POWER LINE SAFETY ZONE

**REFERENCE:** SZ14-T15A-PR1-M1-001-DWG-CST-G04-029: GENERAL NOTES / REFERENCES 40018-001-DWG-CST-G02-001: FLANGE MANAGEMENT DRAWING

**Drawing Status:** FOR REVIEW BY LEAD APPOINTED PARTY | **Suitability:** S4

**SAFETY, HEALTH AND ENVIRONMENTAL INFORMATION**

In addition to the hazards/risks normally associated with the types of work detailed on this drawing, note the following:

**CONSTRUCTION**  
REFER DRA DOCUMENT NO. 40018\_001\_DOC\_C01\_001.

**MAINTENANCE/CLEANING**  
REFER DRA DOCUMENT NO. 40018\_001\_DOC\_C01\_001.

**DECOMMISSIONING/DEMOLITION**  
REFER DRA DOCUMENT NO. 40018\_001\_DOC\_C01\_001.

It is assumed that all works will be carried out by a competent contractor working, where appropriate, to an approved method statement

**LARTINGTON TO WHORLEY SETTING OUT POINTS**

10520	410361.874	516886.475
10560	410400.611	516876.500
10600	410439.347	516866.525
10640	410478.084	516856.551
10680	410516.820	516846.576
10720	410555.556	516836.601
10760	410594.293	516826.627
10800	410633.029	516816.652

**LARTINGTON TO WHORLEY SETTING OUT POINTS**

10840	410671.765	516806.677
10880	410710.502	516796.703
10920	410749.238	516786.728
10960	410787.974	516776.753
11000	410826.711	516766.779
11040	410865.447	516756.804
11080	410904.184	516746.829

**WASHOUT**

SOP NO.	EASTING	NORTHING
LW-WO-017	410739.356	516789.273

**AIRVALVE**

SOP NO.	EASTING	NORTHING
LW-AV-018	410389.265	516879.421

Steel / Ductile Iron Pipes PN16 to seal at 16barg

Gasket Specification	DN100	DN300	DN600	DN700	DN800	DN900
Torque setting (Nm)	49	160	480	467	534	600
C.O.F.	0.120					
Torque sequence	As per Drg: 40018-001-DWG-CST-G02-001 Bolt Specification Grade 4.6					

(\*) - DENOTES SURVEY REQUIRED. REFER TO NOTE 4 FROM GENERAL NOTES.

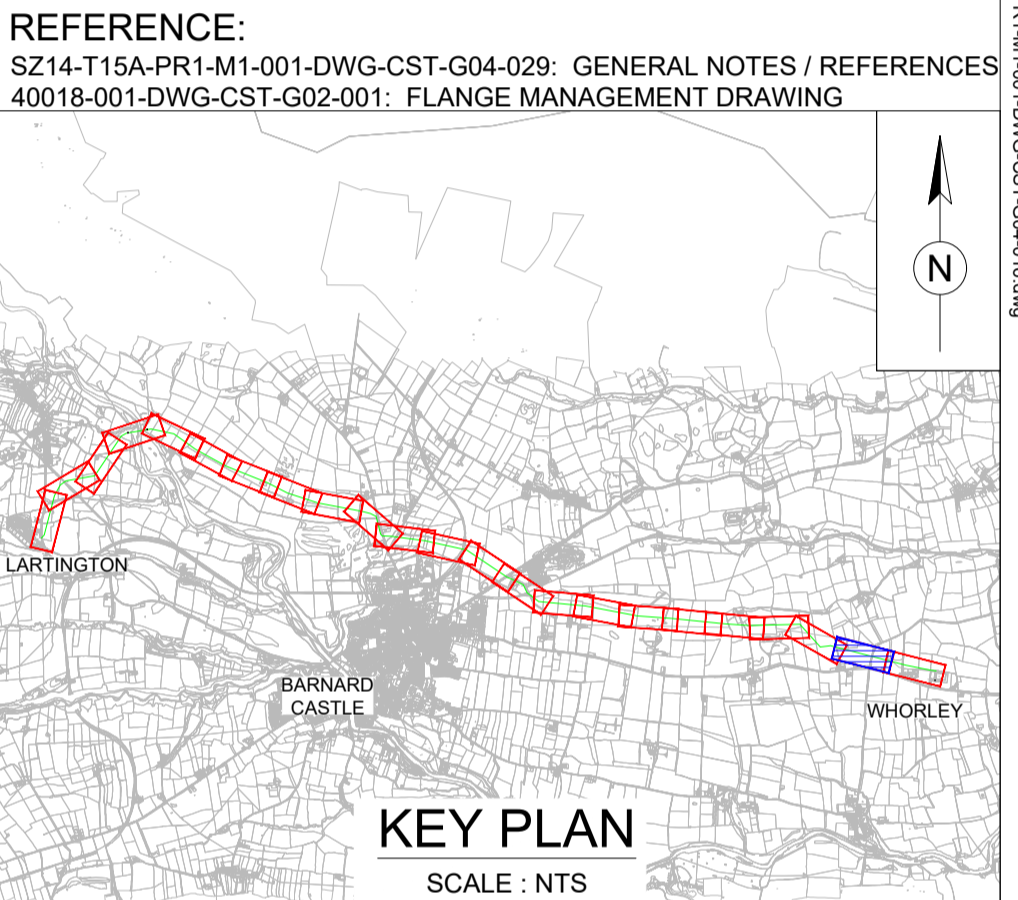
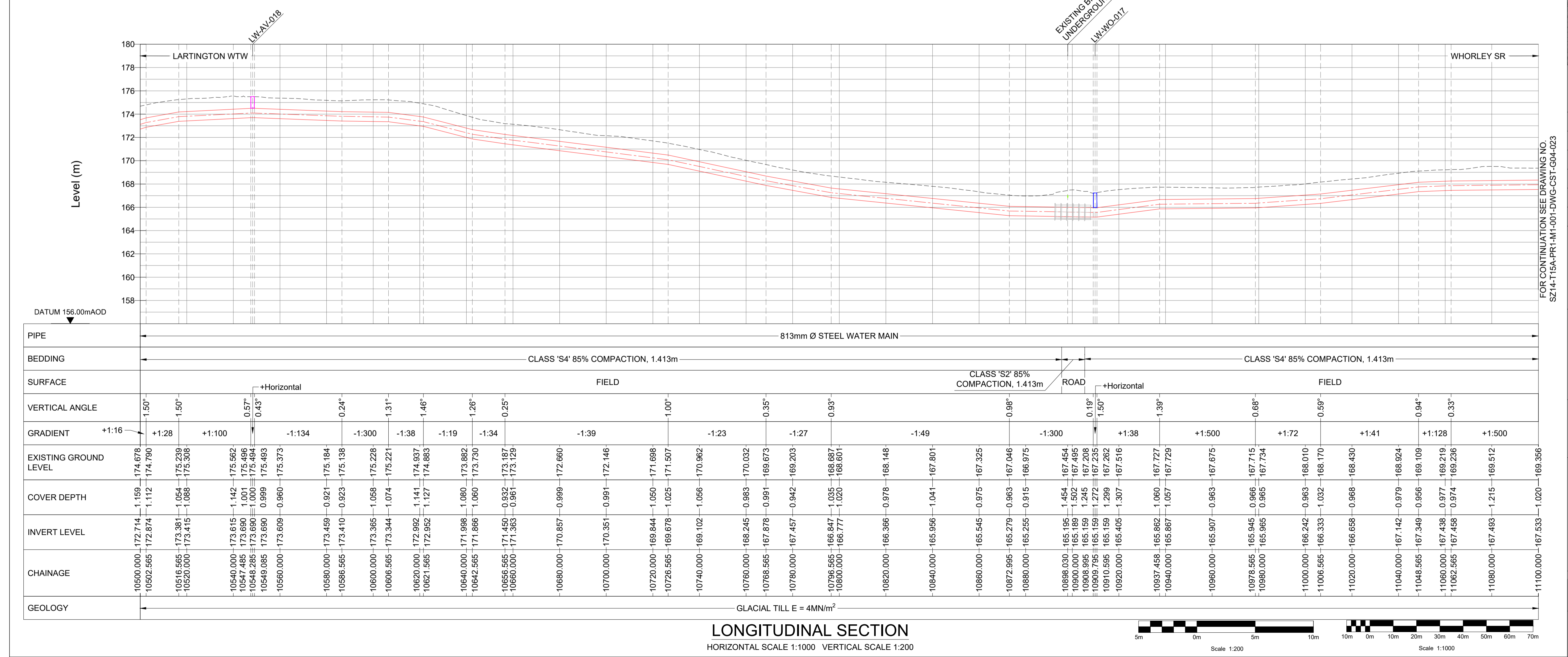

**Drawing Status:** FOR REVIEW BY LEAD APPOINTED PARTY | **Suitability:** S4

Rev.	Description	Date	Drawn	Chk'd	App'd
P04	FOR REVIEW	20.11.2023	AJ	RH	SK
P03	FOR REVIEW	18.09.2023	AJ	RH	SK
P02	FOR REVIEW	26.07.2023	AJ	RH	SK
P01	REVIEW AND COMMENTS	25.04.2023	AJ	SM	SK

**Note:-**  
IF THIS DRAWING IS FOUND TO BE IN ANY WAY INACCURATE, PLEASE ADVISE THE RECORD OFFICE IMMEDIATELY AND COMPLETE AN AMENDMENT FORM.



**CONTRACTOR:** FARRANS  
**REF. NO.:** WN019/0205-4.11  
**I.D. PROJECT NO.:** WN019/0205

**Drawing Title:**  
TEES STRATEGIC TRANSFER MAIN  
LARTINGTON WTW TO WHORLEY SR  
PLAN AND LONGITUDINAL SECTION

**Dwg No:** SZ14-T15A-PR1-M1-001-DWG-CST-G04-022

Sheet:	Date:	Sheet:	Scale:	Rev No:
22 OF 23	20.11.2023	A1	AS SHOWN	P04