

Surface type 7 - Permeable PCC Flags
 Location/Use: Podium landscape
 Colour/Size/Pattern: Natural / 400x400x95mm / Laid stack bond
 Build-up: Flags installed on pedestals. To Architects details and specification.
 Waterproofing, insulation and structural slab to Architects and Engineers detail and specification.
 Ref.: Hydrogrape textured flags from Tobermore or similar approved

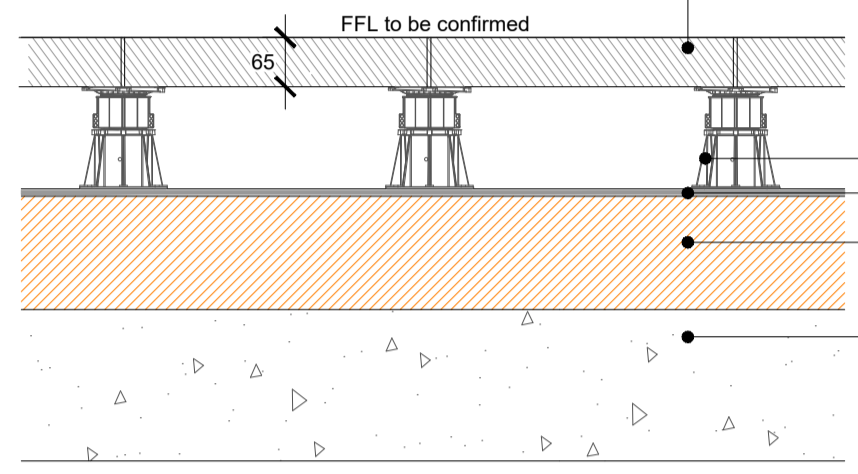

07 Surface type 7 - Permeable PCC Flags to podium
 502 Typical detail SCALE 1:10

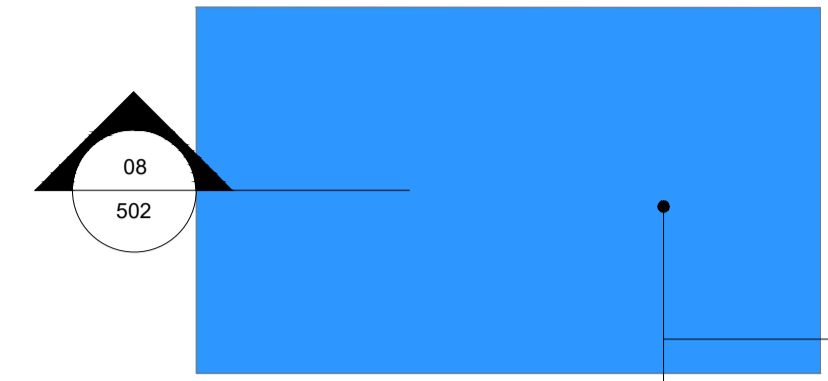

Surface type 8 - Wet pour surfacing
 Location/Use: Equipped play areas
 Colour/Size/Finish: Light blue
 Build-up: 15mm wet pour wearing course
 Min. 25mm wet pour base course (Variable shock-pad/impact absorbing layer)
 125mm Compacted Type 1 Stone Base (non vehicular)
 Ref.: Wet pour from Alumasc or similar approved

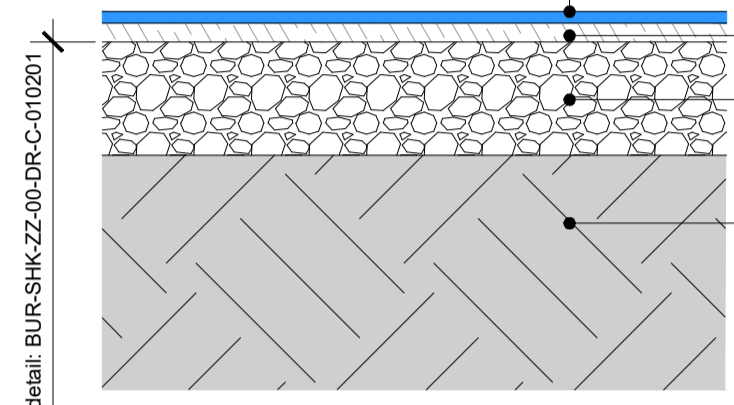

08 Surface type 8 - Wet pour surfacing to play areas
 502 Typical detail SCALE 1:10

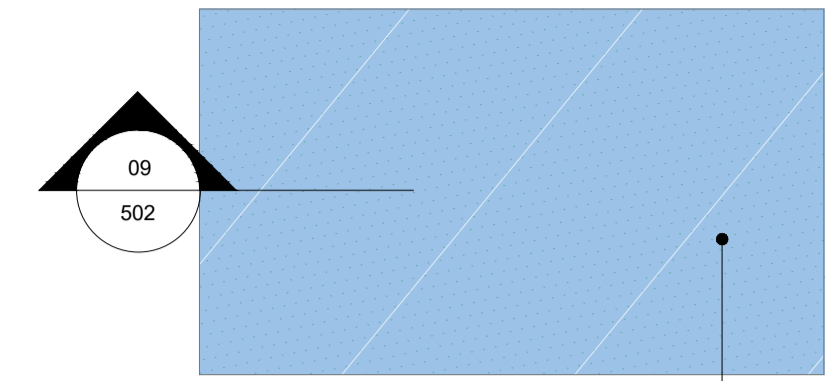

Surface type 09 - Sand dressed, artificial grass play surface
 Location/Use: Junior MUGA
 Colour/Finish: Green / Artificial grass
 Build-up: To manufacturers detail
 Ref.: Synthetic turf from SIS pitches or similar approved

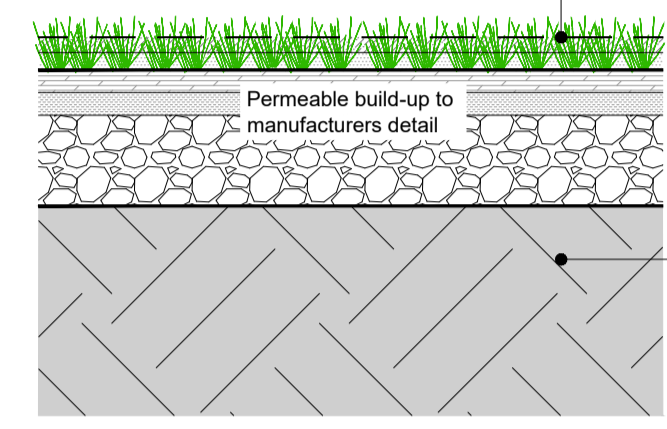

09 Surface type 9 - Artificial turf to Junior MUGA
 502 Typical detail SCALE 1:10

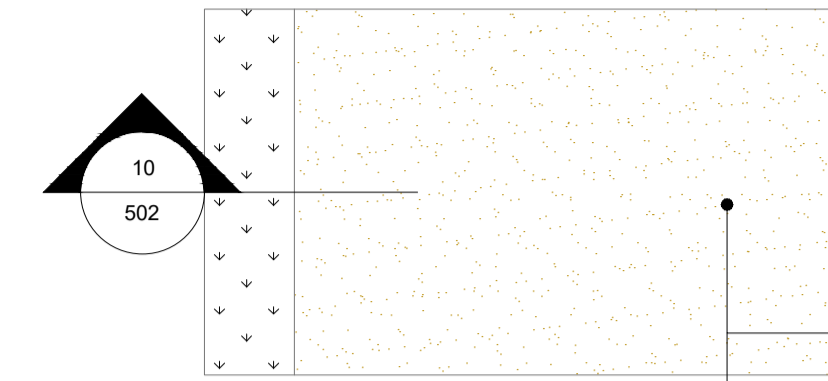

Surface type 10 - Rubber mulch on grass
 Location/Use: Mile a day track (1m wide)
 Colour: Natural
 Build-up: 40mm wearing course laid on geotextile
 No base course or sub-base required
 Ref.: JungleMulch from PlaySmartUK or similar approved

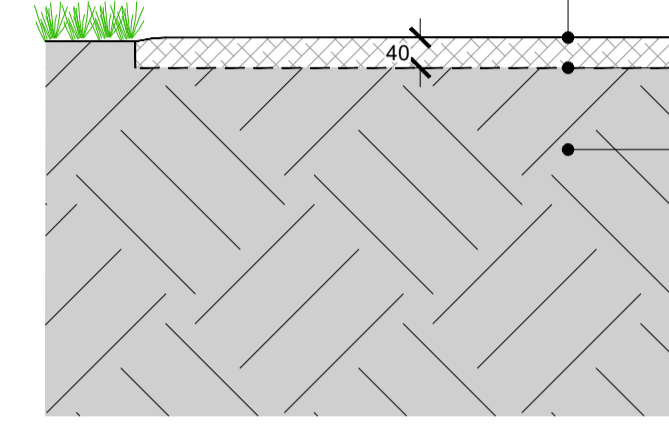

10 Surface type 10 - Rubber mulch matt for running
 502 Typical detail SCALE 1:10

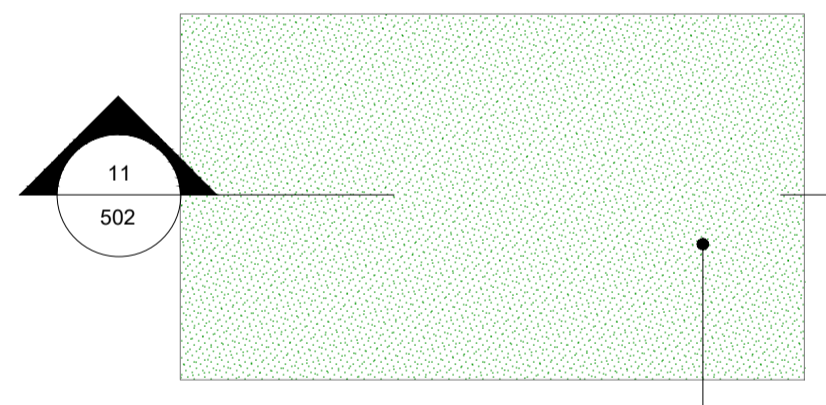

Surface type 11 - Sand dressed, artificial grass play surface
 Location/Use: Infant MUGA
 Colour/Finish: Green / Artificial grass
 Build-up: To manufacturers detail
 Ref.: Synthetic turf from SIS pitches or similar approved

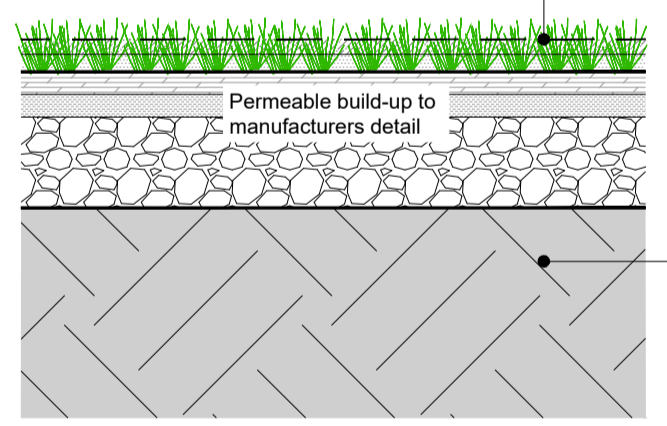

11 Surface type 11 - Artificial turf to infant MUGA
 502 Typical detail SCALE 1:10

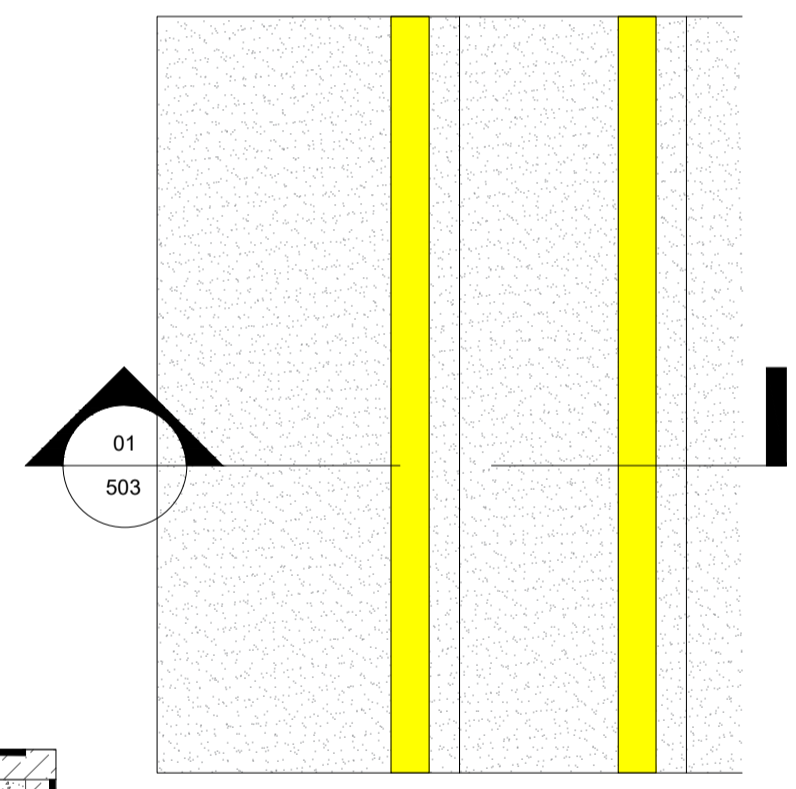

Surface type 12 - Steps
 Granite aggregate step units with contrasting nosing
 Colour & Size: Grey granite @ 350x150x100mm
 Build-up: To Engineers detail and specification.
 Ref.: Granite aggregate steps from Tobermore or similar approved.

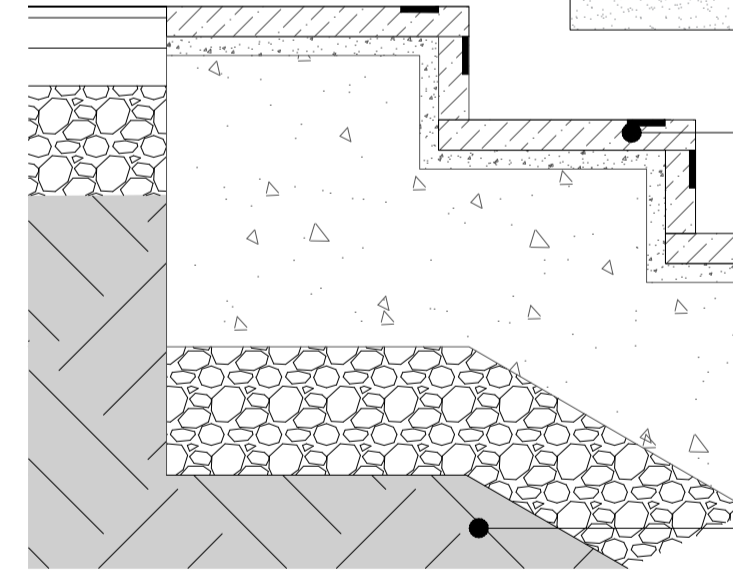

01 Surface type 12 - Steps
 503 Typical detail SCALE 1:10

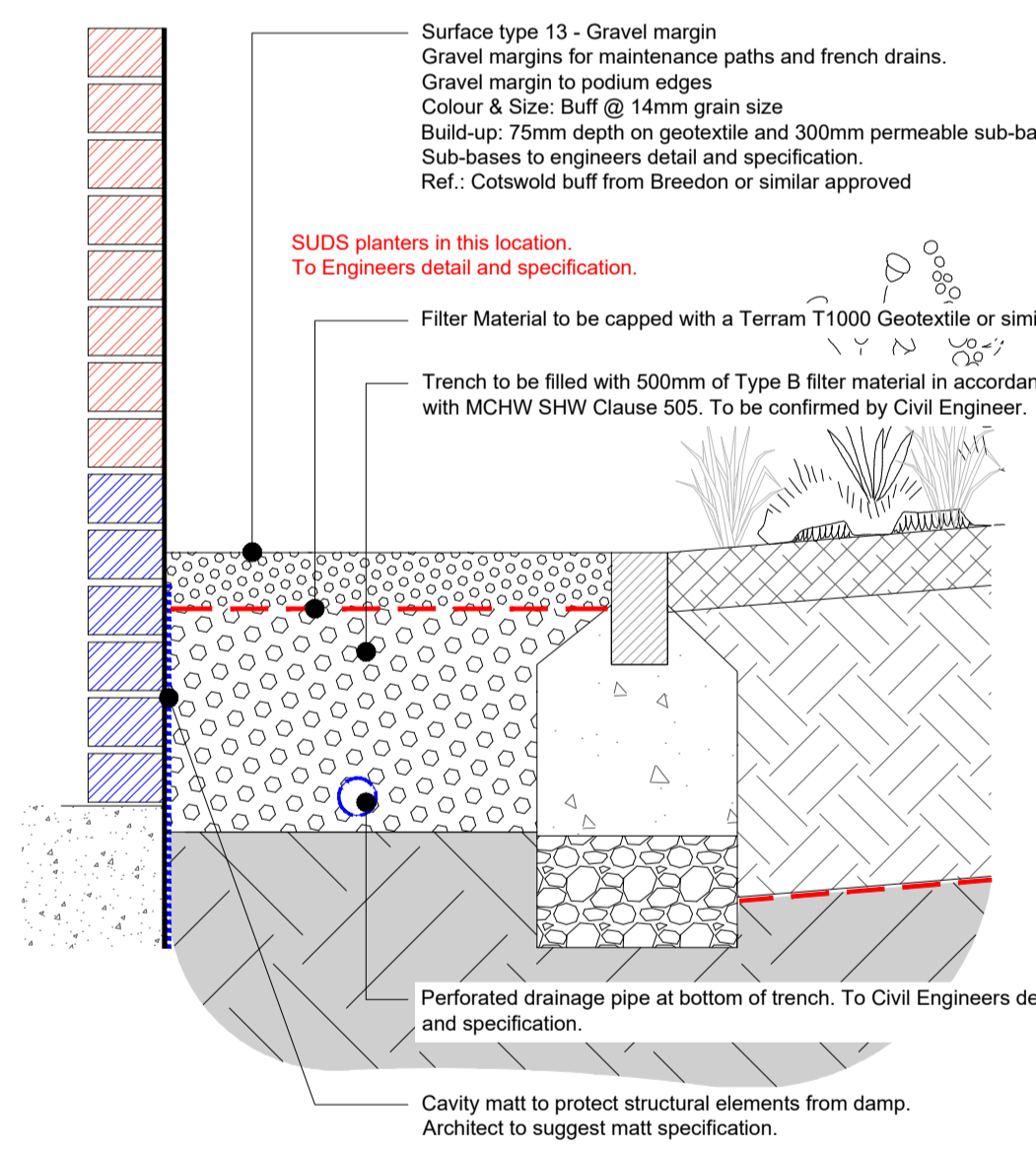

13 Surface type 13 - Gravel margin
 502 Typical detail SCALE 1:10

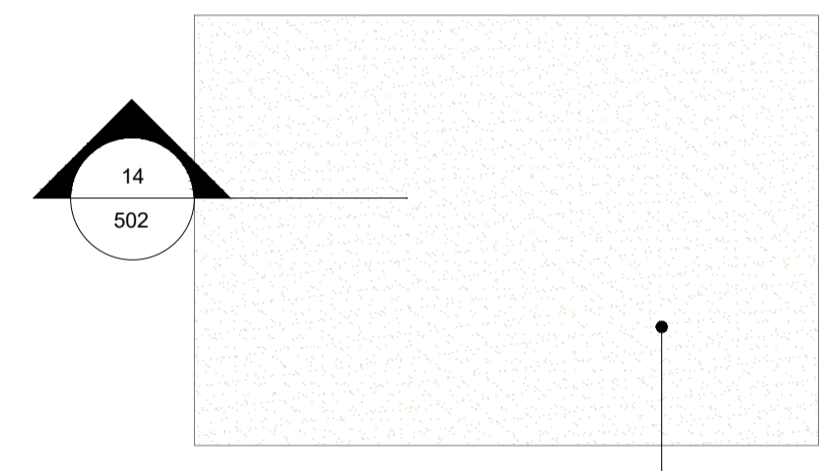

Surface type 14 - Permeable wet pour / Coloured Tarmac (Play/buff)
 Porous colour coated Macadam to ball games space north of new school building.
 Colour & Size: Buff, 10mm surface layer and 30-45mm nominal layer thickness. Manufacturer to confirm.
 Build-up: To Engineers detail and specification
 Ref.: Ulicolour from Tarmac or similar approved
 Refer to link / drawing: <https://tarmac.com/products/asphalt/ulicolour/>

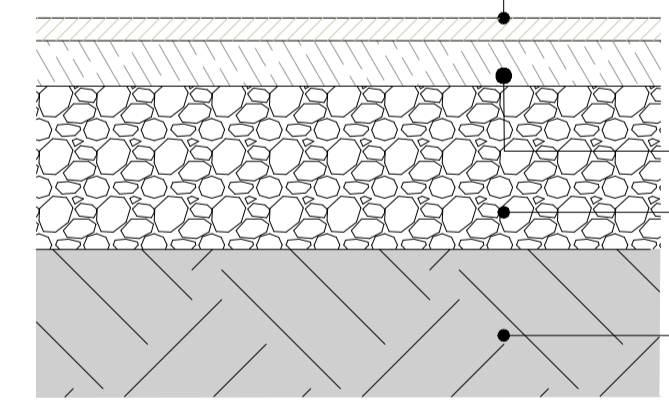

14 Surface type 14 - Permeable wet pour / Coloured macadam surfacing to play areas
 502 Typical detail SCALE 1:10

Rev	Date	Description	Drm
T1	20/12/22	For Information	SO
T2	14/08/23	Amended specification	JG