

1:1250  
 0 25 50  
 m

Planning application boundary

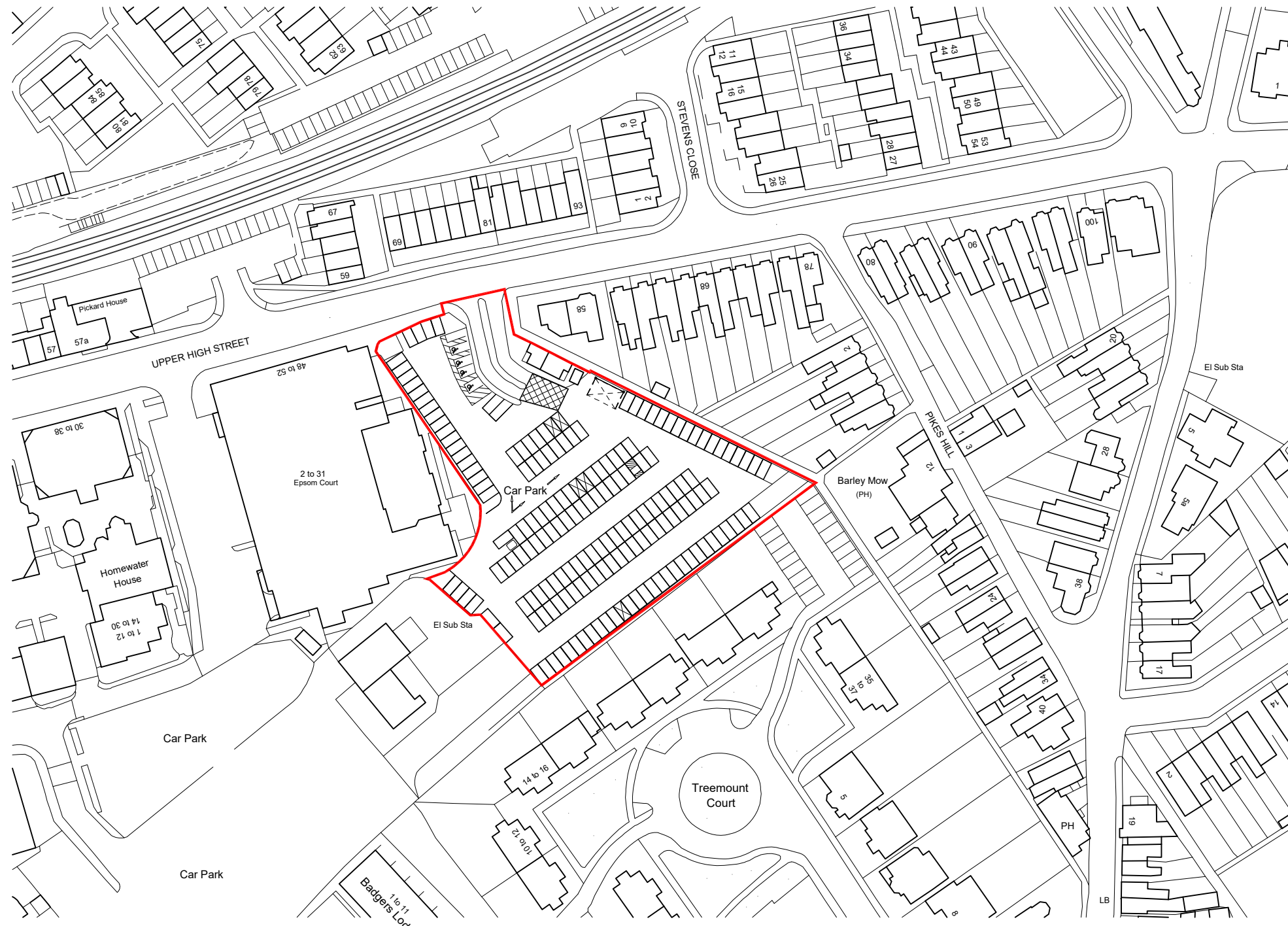

|  |        |              |                  |
|--|--------|--------------|------------------|
| REVISION 3   | BY: SB | CHECKED:     | DATE: 29/01/2024 |
| Revised following planning comments to extend application boundary to include the whole Car Park.                                      |        |              |                  |
| REVISION 2   | BY: SB | CHECKED:     | DATE: 19/01/2024 |
| Revised following planning comments to extend application boundary to include land required to access to the site from public highway. |        |              |                  |
| REVISION 1   | BY: SB | CHECKED: JSP | DATE: 05/01/2024 |
| Initial issue  |        |              |                  |

STATUS

**S4a | FOR PLANNING**

CLIENT



PROJECT

**CAR PARK VALETING  
 EPSOM, UPPER HIGH STREET**

TITLE

**SITE LOCATION PLAN**

**Hadfield Cawkwell Davidson**  
 Broomgrove Lodge, 13 Broomgrove Rd, Sheffield, S10 2LZ T 0114 266 8181 www.hcd.co.uk

|                             |                      |                         |
|-----------------------------|----------------------|-------------------------|
| HCD PROJECT NO.<br>2023-243 | SCALE<br>1:1250 @ A3 | REV.<br>3               |
| PROJECT<br>2023-243         | ORIGINATOR<br>HCD    | DIVISION<br>XXX         |
| LEVEL<br>00                 | TYPE<br>DR           | ROLE + NUMBER<br>A-9100 |