

LEGEND	
	PROPOSED ADOPTABLE FOOTWAY TO CARRIAGEWAY SPECIFICATION
	PROPOSED ADOPTABLE FOOTWAY
	PROPOSED ADOPTABLE VERGE
	HIGHWAY BOUNDARY
	EXISTING GROUND LEVEL
	PROPOSED CONCRETE HALF BATTERED KERB WITH 125m KERB FACE
	PROPOSED BULL NOSED CONCRETE KERB WITH KERB FACE UPSTAND AS SPECIFIED
	PROPOSED CONCRETE TRANSITIONAL KERB
	PROPOSED EDGING KERB
	VISIBILITY SPLAYS
	PROPOSED LEVELS
	PROPOSED DOUBLE LINES
	EXISTING TREES TO REMAIN PLEASE REFER TO AIA FOR FURTHER INFORMATION BY RAVENCROFT REFERENCE 130522/01

INSPECTIONS REQUIRED BY THE HIGHWAYS INSPECTOR

THE CONTRACTOR SHALL GIVE AT LEAST 48 HOURS ADVANCE NOTICE TO NORFOLK COUNTY COUNCIL TO ALLOW THE INSPECTOR PROPER INSPECTION AND CHECKING OF THE WORKS AT THE FOLLOWING DESIGNATED STAGES:

- 1) START OF THE WORKS
- 2) BEFORE BACK FILLING ANY TRENCHES UNDER NEW HIGHWAY
- 3) COMPLETION OF FORMATION
- 4) COMPLETION OF SUB-BASE
- 5) LAYING OF SAND
- 6) LAYING OF BINDER COURSE
- 7) LAYING OF SURFACE COURSE

SAFETY, HEALTH AND ENVIRONMENTAL INFORMATION

NOTES: THIS DRAWING IS TO BE READ IN CONJUNCTION WITH THE RISK REGISTER PRODUCED FOR INCLUSION IN THE HEALTH AND SAFETY PLAN. THE HAZARDS NOTED ARE IN ADDITION TO THE NORMAL HAZARDS AND RISKS FACED BY A COMPETENT CONTRACTOR WHEN DEALING WITH THE TYPE OF WORKS DETAILED ON THIS DRAWING.

CONSTRUCTION RISKS:

- UNKNOWN LOCATION OF EXISTING UTILITIES.
- WORKS WITHIN EXISTING CARRIAGEWAY.
- OVERHEAD LIVE CABLES.
- CONNECTION TO LIVE SEWER.

MAINTENANCE/CLEANING/IN USE RISKS:

- NO SIGNIFICANT RISKS.

DEMOLITION RISKS:

- NO SIGNIFICANT RISKS.

CONTRACTOR SHALL PROVIDE, ERECT, MAINTAIN AND REMOVE UPON COMPLETION ALL TEMPORARY SIGNING REQUIRED FOR WORKS CARRIED OUT WITHIN THE HIGHWAY. THE CONTRACTOR SHALL SUBMIT TO THE HIGHWAYS INSPECTOR OF NORFOLK COUNTY COUNCIL WITH REGARD TO AGREEING APPROPRIATE METHODS OF TRAFFIC MANAGEMENT.

22. THE CONTRACTOR SHALL SUBMIT TO THE STREET WORKS COORDINATOR AND UTILITY COMPANIES THE APPROPRIATE 'N' NOTICES. UPON COMPLETION OF THE WORKS THE CONTRACTOR SHALL SUBMIT TO THE STREET WORKS COORDINATOR THE APPROPRIATE 'R' NOTICE.
23. ALL PROPRIETARY MATERIALS SHALL BE INSTALLED IN ACCORDANCE WITH THE MANUFACTURER'S INSTRUCTIONS AND RECOMMENDATIONS.
24. NO TREES, HEDGES OR SHRUBS SHALL BE TAKEN UP OR OTHERWISE DAMAGED UNLESS NOTED TO THE CONTRARY ON THE DRAWINGS. OR EXPRESS PERMISSION IS FIRST OBTAINED FROM THE EMPLOYER.
25. FOR PRECISE POSITIONS AND DETAILS OF DOMESTIC PATHS, SHEDS, BIN STORES, WASHING LINES ETC PLEASE REFER TO THE ARCHITECT'S DRAWINGS.
26. FOR DETAILS OF LANDSCAPING AND PLANTING PLEASE REFER TO THE LANDSCAPING DRAWING PREPARED BY OTHERS.
27. THE MAIN CONTRACTOR IS RESPONSIBLE FOR ACHIEVING AND MAINTAINING THE STABILITY OF EARTHWORKS AND ANY EXISTING STRUCTURES ON THE SITE AND ADJOINING SITES, TAKING ALL NECESSARY PRECAUTIONS TO SAFEGUARD THIS STABILITY. ADEQUATE SHORING IS TO BE INSERTED DURING THE WORKS TO ENSURE STABILITY AND SUCH SHORING IS TO BE ADEQUATELY FOUNDED AND BRACED.
28. AS UNDERLYING GROUND CONDITIONS MAY BE VARIABLE ACROSS THE SITE THE CONTRACTOR SHALL UNDERTAKE ONSITE POROSITY TESTS AT THE LOCATION AND DEPTH OF EACH SOAKAWAY. TESTS SHOULD BE UNDERTAKEN IN ACCORDANCE WITH BRE365 AND RESULTS FORWARDED TO THE ENGINEERS TO ALLOW VERIFICATION OF DESIGNS.
29. PRIOR TO COMMENCING ANY DRAINAGE WORKS THE CONTRACTOR SHALL CHECK AND CONFIRM BACK TO ROSSI LONG CONSULTING LTD THE EXISTING INVERT LEVEL OF ALL OUTFALLS AND/OR CONNECTIONS TO EXISTING SEWERS. ANY WORK CARRIED OUT WITHOUT DOING THIS IS ENTIRELY AT THE CONTRACTOR'S OWN RISK.

© ROSSI LONG CONSULTING 2023.

- NOTE:**
1. DO NOT SCALE, IF IN DOUBT ASK.
 2. THIS DRAWING IS TO BE READ IN CONJUNCTION WITH ALL RELEVANT STRUCTURAL ENGINEERS DRAWINGS AND DETAILS. THE SPECIFICATION FOR THE WORKS, THE RELEVANT ARCHITECT'S DRAWINGS AND ANY OTHER SPECIALIST'S DRAWINGS.
 3. ANY DISCREPANCIES FOUND ON THIS OR ANY OTHER DRAWINGS ARE TO BE REPORTED TO AND RESOLVED BY ROSSI LONG CONSULTING BEFORE THE COMMENCEMENT OF ANY WORK RELEVANT TO THE DISCREPANCY.
 4. THE PRINCIPAL CONTRACTOR IS TO PROVIDE FULLY DESIGNED PROPPING/SHORING TO FACILITATE THE WORKS. ALL PROPPING & BRACING IS TO BE ADEQUATELY FOUNDED TO ENSURE THE STABILITY/INTEGRITY OF THE EXISTING/PROPOSED STRUCTURES &/OR EARTHWORKS IS MAINTAINED. UNLESS INDICATED ON THE DRAWINGS, THE TEMPORARY WORKS ARE NOT TO IMPOSE REACTIONS ON THE PERMANENT STRUCTURE WITHOUT PRIOR WRITTEN CONSENT FROM ROSSI LONG CONSULTING.
 5. THIS DOCUMENT HAS BEEN PREPARED IN ACCORDANCE WITH THE SCOPE OF ROSSI LONG CONSULTING'S APPOINTMENT WITH ITS CLIENT AND IS SUBJECT TO THE TERMS OF THAT APPOINTMENT. ROSSI LONG CONSULTING ACCEPTS NO LIABILITY FOR ANY USE OF THIS DOCUMENT OTHER THAN BY ITS CLIENT AND ONLY FOR THE PURPOSES FOR WHICH IT WAS PREPARED AND PROVIDED. ONLY WRITTEN DIMENSIONS SHALL BE USED.
 6. THIS DRAWING IS BASED ON A TOPOGRAPHICAL SURVEY CARRIED OUT BY BB SURVEYS AS DEPICTED ON THEIR DRAWING BBS-BB-EGL-SU-10 AND PLANNING DRAWINGS BY ARCHITECTS DESIGN PARTNERSHIP.
 7. DIMENSIONS ARE STATED IN MILLIMETRES UNLESS SHOWN OTHERWISE. CHANGINGS ARE STATED IN METRES. LEVELS ARE IN METRES AND RELATED TO ORDNANCE DATUM.
 8. DIMENSIONS AND CO-ORDINATES SHOULD NOT BE SCALED FROM THIS DRAWING, IF IN DOUBT PLEASE ASK.
 9. THE CONTRACTOR IS TO VERIFY THE ACCURACY OF INFORMATION PROVIDED BY OTHERS.
 10. EXISTING PUBLIC UTILITY SERVICES AND PRIVATE APPARATUS ARE NOT NECESSARILY ALL SHOWN ON THIS DRAWING. THE CONTRACTOR SHALL LIAISE WITH THE APPROPRIATE UTILITY PROVIDER TO DETERMINE PRECISELY WHERE ON SITE EXISTING SERVICES ARE LOCATED. SERVICES SHALL BE LOCATED AND MARKED OUT ON SITE PRIOR TO ANY EXCAVATION WORK BEING COMMENCED.
 11. ALL EXISTING SERVICES, SEWERS AND DRAINS INDICATED ON THIS AND ANY OTHER RELATED DRAWINGS ARE SHOWN ONLY INDICATIVELY, AND SHALL HAVE THEIR POSITION AND LEVEL CONFIRMED ON SITE BY THE CONTRACTOR.
 12. ALL HIGHWAY WORKS SHALL BE CONSTRUCTED FULLY IN ACCORDANCE WITH NORFOLK COUNTY COUNCIL'S SPECIFICATION, CONTAINED IN THEIR PUBLICATION 'ESTATE DESIGN GUIDE - ROAD CONSTRUCTION AND STREET LIGHTING SPECIFICATION (AUGUST 2007)' AND THE HIGHWAYS AGENCY SPECIFICATION. THE CONTRACTOR SHALL LIAISE WITH NORFOLK COUNTY COUNCIL'S HIGHWAYS INSPECTOR WITH REGARD TO INSPECTIONS AT THE APPROPRIATE STAGES OF THE WORKS.
 13. SURFACE WATER FROM THE DEVELOPED SITE SHALL BE DRAINED TO ONSITE SOAKAWAYS. THE CONTRACTOR SHALL UNDERTAKE AN ONSITE POROSITY TEST TO COMPLY WITH BRE 365 AT THE LOCATION OF EACH SOAKAWAY.
 14. FOUL WATER FROM THE DEVELOPMENT SHALL BE DRAINED TO THE EXISTING FOUL SEWER IN A149 ROAD VIA GRAVITY.
 15. CONNECTIONS TO THE EXISTING SEWER SHALL BE SUBJECT TO THE APPROVAL OF ANGLIAN WATER AND SHALL BE CARRIED OUT BY A CONTRACTOR APPROVED BY ANGLIAN WATER. THE CONTRACTOR SHALL COMPLY WITH THE REQUIREMENTS OF ANGLIAN WATER WITH REGARD TO SUBMITTING METHOD STATEMENTS, RISK ASSESSMENTS ETC FOR OBTAINING A PERMIT TO WORK ON THE SEWER.
 16. ALL CONNECTIONS TO ADOPTABLE SEWERS TO BE MADE IN VITRIFIED CLAY ONLY.
 17. ALL NON-ADOPTABLE DOMESTIC DRAINAGE SHALL BE SUBJECT TO INSPECTIONS BY THE LOCAL BUILDING CONTROL OFFICER. THE CONTRACTOR SHALL LIAISE WITH THE BUILDING INSPECTOR WITH REGARD TO ARRANGING INSPECTIONS AT THE APPROPRIATE STAGES OF THE WORK.
 18. PROTECTION TO DOMESTIC SEWERS: WHERE THE COVER TO PIPES UNDER TRAFFICKED AREAS IS LESS THAN 900mm THE PIPELINE SHALL BE PROTECTED WITH A MIN 150mm THICK CONCRETE SURROUND (BED TYPE Z1).
 19. ALL PIPES ENTERING OR LEAVING MANHOLES SHALL BE LAID WITH THEIR SOFFITS LEVEL, UNLESS SHOWN OR AGREED OTHERWISE.
 20. ALL DOMESTIC DRAINAGE PIPE LINES SHALL BE 100mm DIA CLAYWARE OR PVC UNLESS STATED OTHERWISE. 100mm DIA STORM DRAINS SHALL BE LAID AT A GRADIENT NO FLATTER THAN 1 IN 100, AND FOUL DRAINS TO A GRADIENT NO FLATTER THAN 1 IN 80.
 21. ALL WORKS WITHIN THE EXISTING HIGHWAY SHALL BE CARRIED OUT FULLY IN ACCORDANCE WITH THE NEW WORKS AND STREET WORKS ACT 1991 AND TO CHAPTER 8 OF THE TRAFFIC SIGNS MANUAL. THE

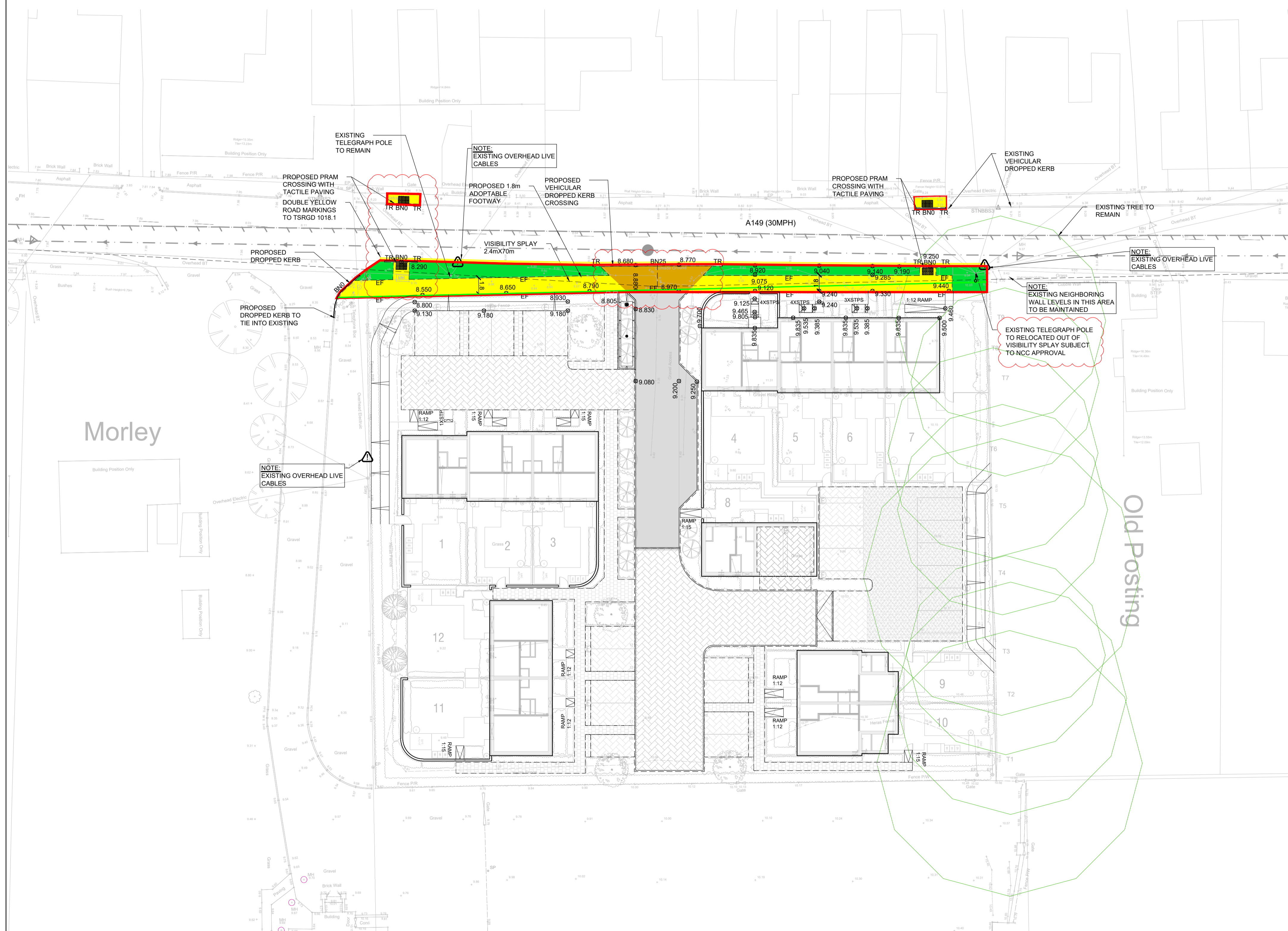

PRELIMINARY DRAWING:
THIS DRAWING IS FOR PRELIMINARY PURPOSES ONLY AND MUST NOT BE READ AS A CONSTRUCTION ISSUE. IT INDICATES DESIGN INTENT ONLY AND IS SUBJECT TO AMENDMENT DURING FINAL DESIGN DEVELOPMENT.

REV	DESCRIPTION	DATE	BY	AUTH
P02	UPDATED TO MEET NCC COMMENTS.	06.12.23	EG	-
P01	PRELIMINARY ISSUE.	30.10.23	EG	-

Rossi Long Consulting
16 Meridian Way, Norwich, Norfolk, NR7 0TA
T: 01603 706 420 www.rossilong.co.uk

CLIENT
FREEBRIDGE COMMUNITY HOUSING

PROJECT
LAND AT BRENTWOOD BRANCASTER STAITHE

TITLE
S278 WORKS LAYOUT

DRAWN	AUTHORISED	DATE	SCALE AT A1
EG	ML	OCT 2023	1:250
SUITABILITY S0 - WORK IN PROGRESS			
PROJECT NO.	DRAWING FIELDS.	DRAWING NO.	REV
211382		C-160	P02

