

proposed g.f plan

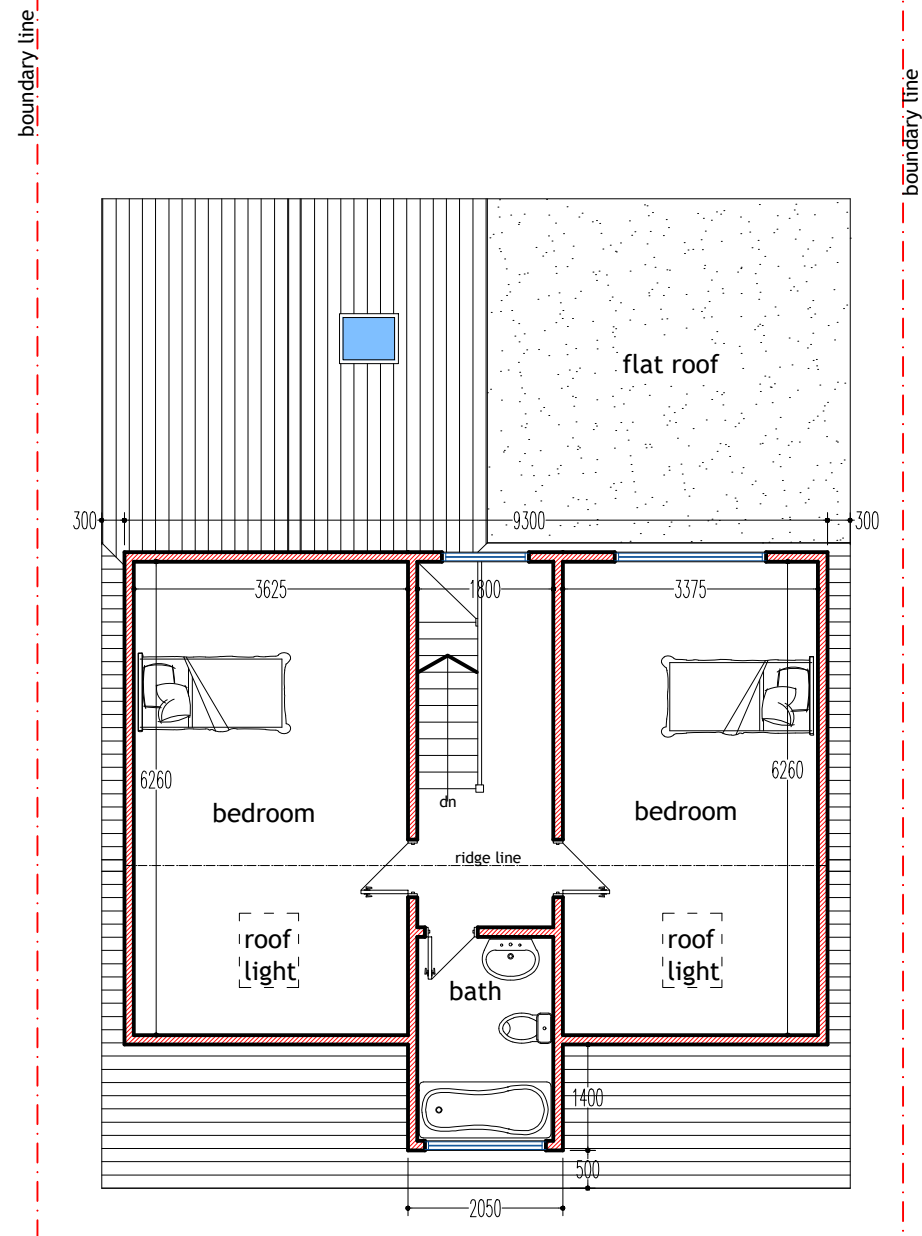

proposed f.f plan

**general notes**

- ALL EXTERNAL FINISHING MATERIALS TO MATCH EXISTING.
- ALL DIMENSIONS TO BE CHECKED ON SITE PRIOR TO COMMENCEMENT OF WORK.
- CONTRACTOR/BUILDER MUST ENSURE ALL NEW GUTTERING, FASCIA, ETC. OF THE NEW ROOF ARE WITHIN BOUNDARY LINE AND MUST NOT PROJECT OVER THE BOUNDARY LINE.
- POSITION OF BOUNDARY LINE/WALL TO ADJACENT PROPERTIES TO BE AGREED IN WRITING BY PARTIES INVOLVED AS SET OUT IN THE PARTY WALL ACT 1996 PRIOR TO WORK COMMENCEMENT.
- CLIENT AND CONTRACTOR TO ENSURE SAFETY OF ALL ON SITE WHILE DEVELOPMENT IS CARRIED OUT, CDM 2015.

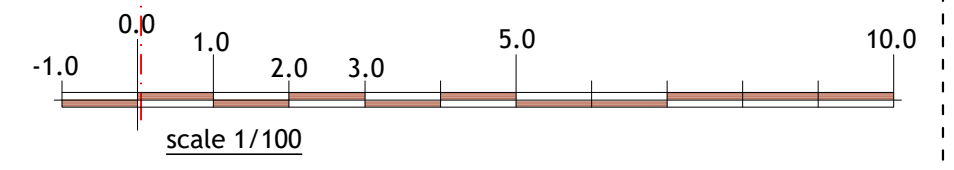
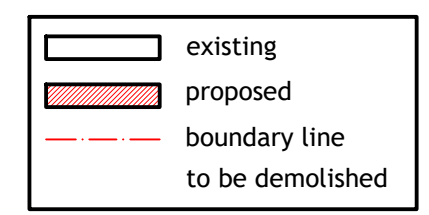

**plan & build**



PH: 07816611144

shamshadali@hotmail.co.uk

ADDRESS: 40 CATSBROOK RD, LUTON, LU3 2ET

TITLE: PROPOSED PLANS

PROJECT: SINGLE STOREY REAR AND FRONT EXTENSION  
HIP TO GABLE ROOF ALTERATION WITH DORMERS

DATE 30/10/2023 DWG NO. 03/07

DRAWN BY SCALE 1:100

**A3**