



General Notes

- 1.) This drawing is to be used in conjunction with all relevant drawings, specifications and details.
- 2.) All dimensions are in metres unless noted otherwise.
- 3.) Do not scale from this drawing.

Drawing Key

- Site boundary
- Bituminous Carriageway
- Bituminous Private Footway
- Bituminous Public Footpath
- Block Paved Footway
- Permeable Parking Bay
- Grass Verge
- Utilities Buildings
- Tactile Paving
- Indicative Trapped Pot Gully
- Indicative Bus Stop Area to be relocated (subject to liaison and agreement with Luton Borough Council)
- Metal fencing and gateway
- Filter Drain
- Visibility 2.4m x 43m
- Junction Visibility Splay

Kerbing key

- Half batter kerb type HB2 (125mm upstand)
- Bullnosed kerb type BN (0mm upstand)
- Dropper Kerb (125mm - 0mm)
- Stretcher Course Brickwork
- Footway Edging
- R24m Kerb radius

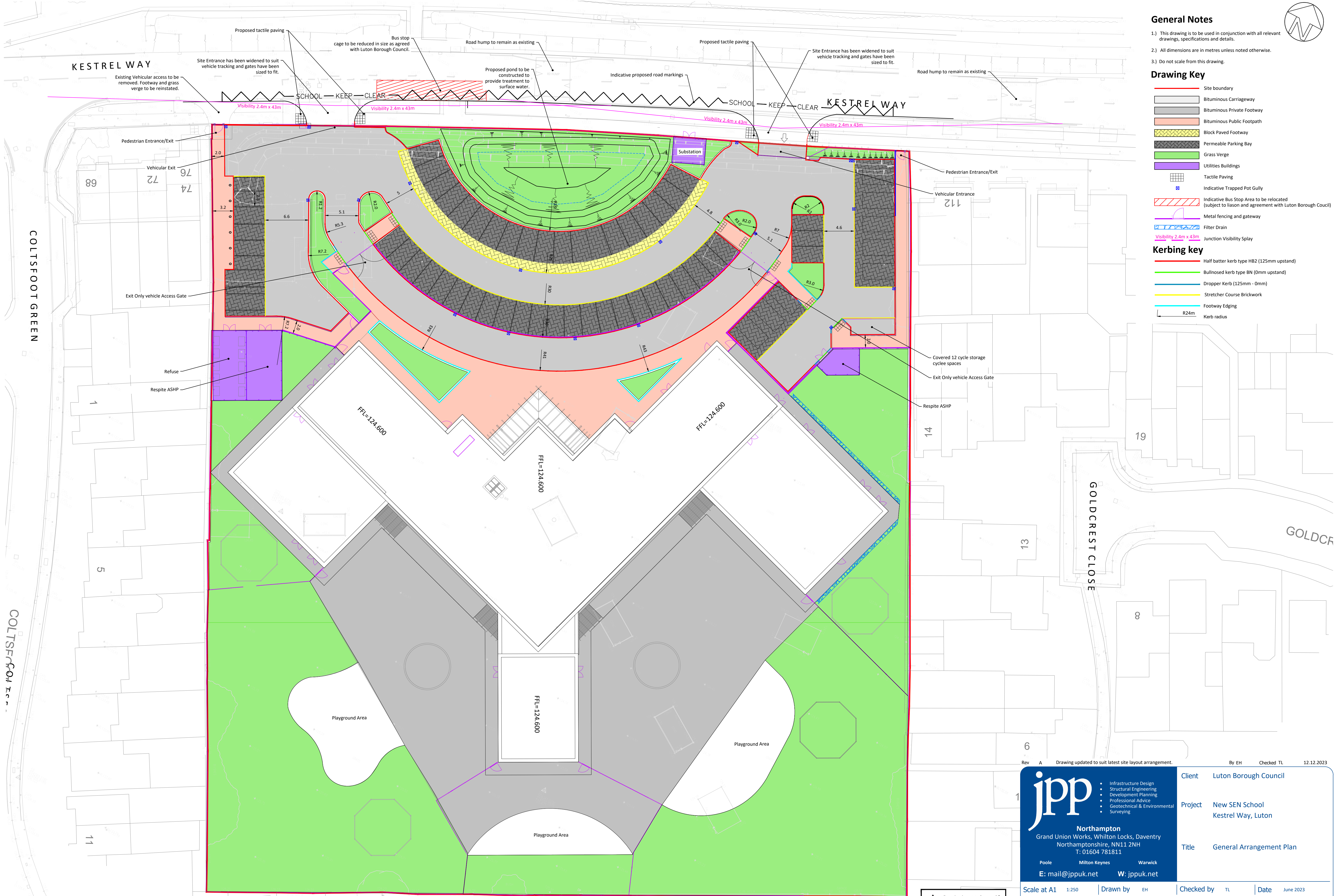

Rev A Drawing updated to suit latest site layout arrangement. By EH Checked TL 12.12.2023

jpp
 Northampton
 Grand Union Works, Whilton Locks, Daventry
 Northamptonshire, NN11 2NH
 T: 01604 781811
 Poole Milton Keynes Warwick
 E: mail@jppuk.net W: jppuk.net

Client	Luton Borough Council
Project	New SEN School Kestrel Way, Luton
Title	General Arrangement Plan

Scale at A1	1:250	Drawn by	EH	Checked by	TL	Date	June 2023
Status	FOR PLANNING	Project ref	25910	Drawing no.	101	Revision	A

