

Aspen Lodge

Aspen Parva

52.0m

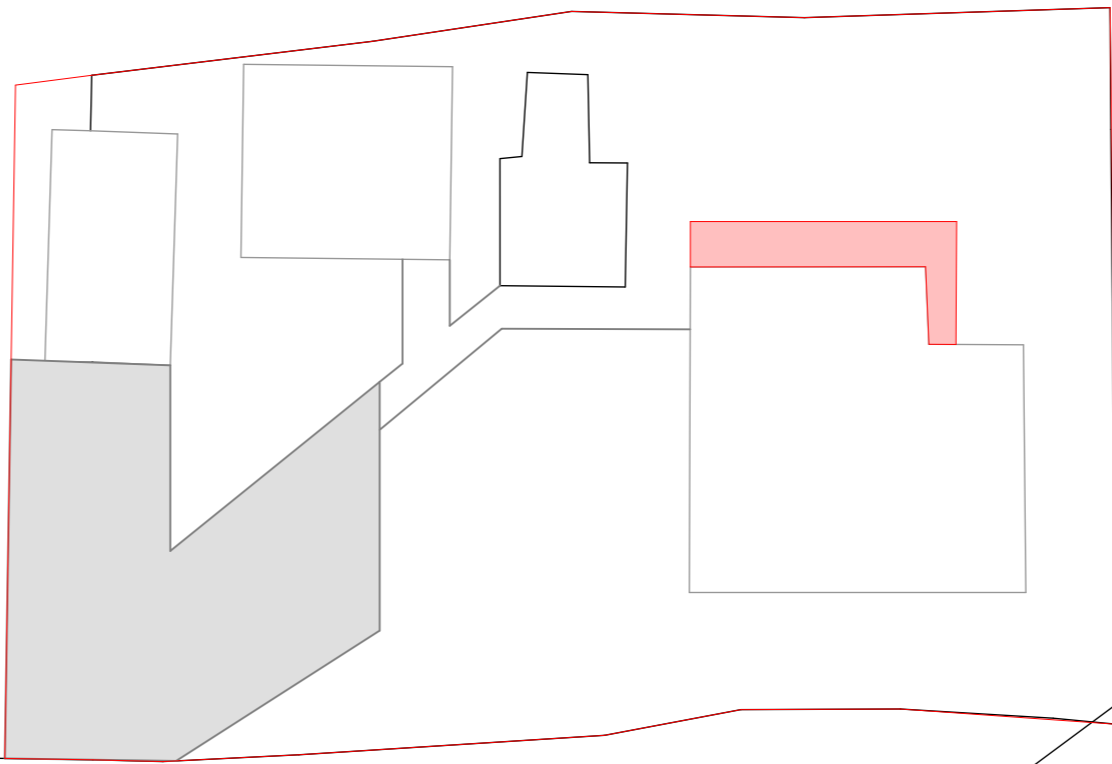

To A143 Bury Road
Stanton
Wattisfield

The Street

To Hepworth
and Barningham

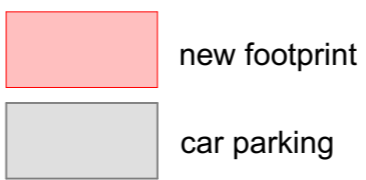

Produced on 29 January 2024 from the Ordnance Survey National Geographic Database and incorporating surveyed revision available at this date.
 This map shows the area bounded by 598670 274300,598812 274300,598812 274442,598670 274442,598670 274300
 Crown copyright and database rights 2024 OS 100054135. Supplied by copla ltd trading as UKPlanningMaps.com a licensed Ordnance Survey partner (OS 100054135).
 Data licence expires 29 January 2025. Unique plan reference: v2e//1051611/1416744

Rev A - car parking added

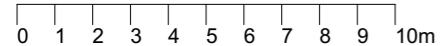

Aspen Parva The Street Hepworth for Mr and Mrs Roberts	BLOCK PLAN		Malcolm Ness Architect 10 Tennyson Cose Caldicot NP26 4LL e:malcolmessarchitect@gmail.com t: 07795 254 999	
	2393-BP A	scale 1:200 @A3		