

EXISTING GROUND FLOOR PLAN

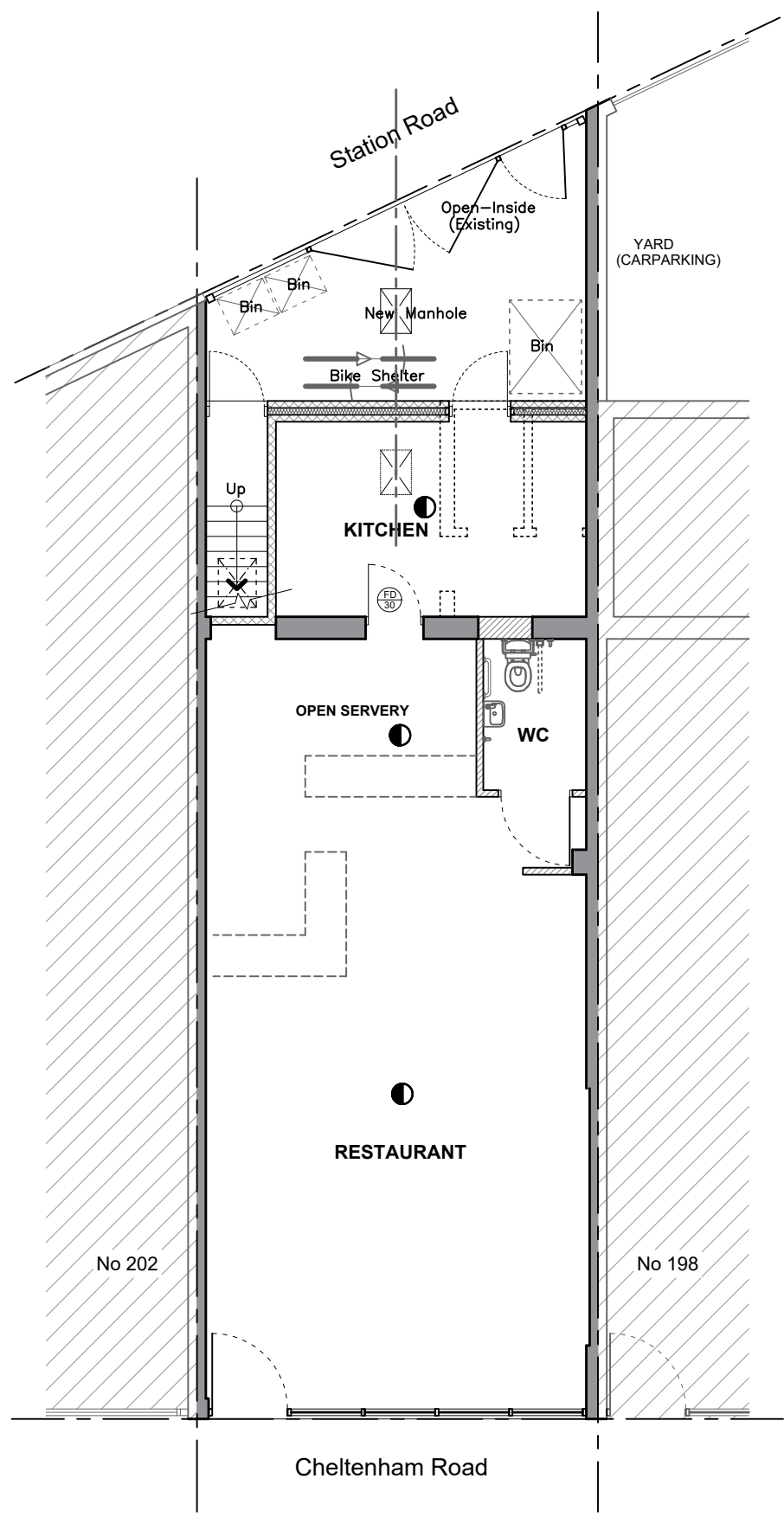

PROPOSED GROUND FLOOR PLAN

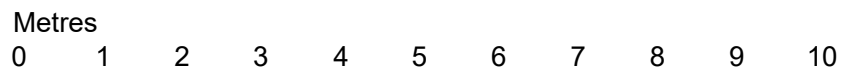
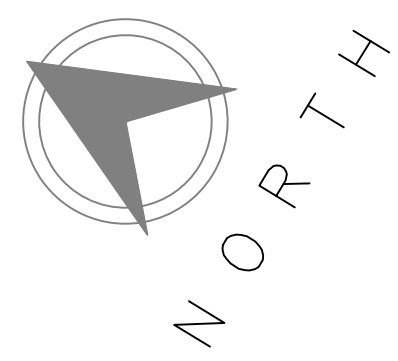

Scale ALL DIMENSIONS AND LEVELS MUST BE VERIFIED ON SITE

Rev	Amendments	Date

PROJECT	200 Cheltenham Road, Bristol BS6 5QZ		
DRAWING TITLE	Existing / Proposed Ground Floor Plan		
Date	June, 2023	Scale	1/100 @ A3
Drawn. No.	23PP28/001		
FORSPLACE		ARCHITECTURAL / CIVIL / STRUCTURAL / CONSULTANTS	
ASSOCIATES • DESIGN & BUILD		190 Blagdon Road, New Malden, Surrey KT3 4AL	
		Email: info@forspace.co.uk Tel: 0208 949 7404	