

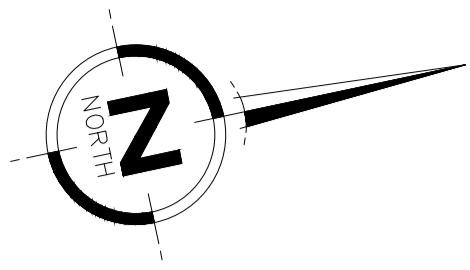





Do not scale dimensions from this drawing.



-  Light fitting to clients specification
-  Porcelain Slab Gard Piet Viv Beige 800x800x20mm
-  Footpath Resin Bound Rubber Mulch Surfacing
-  Resin Bonded Drive "Britney Bronze"/Footpath
-  Marshall's Saxon Paving "Natural" with Marshall's Edging Keyblock 60 "Natural"
-  Wood Chip Footpath with weed suppression timber edged



Porcelain Slab Gard Piet Viv Beige 800x800x20mm



Footpath Resin Bound Rubber Mulch Surfacing

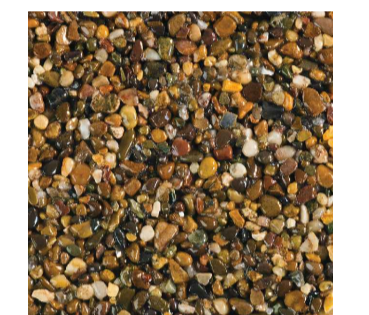

Resin Bonded Drive "Britney Bronze"

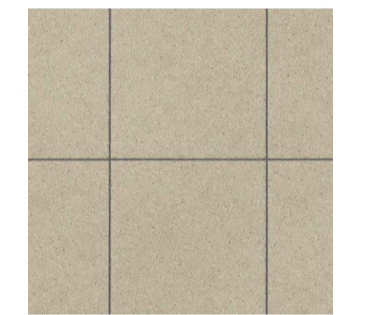

Marshall's Saxon Paving "Natural" with Marshall's Edging Keyblock 60 "Natural"

Refer to Dwg 0731/9014 for continuation of top part of site.

Refer to Dwg 0731/9014 for continuation of top part of site.

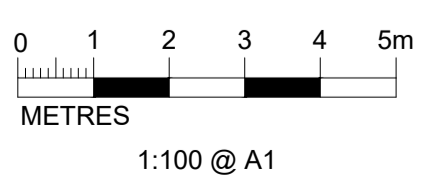
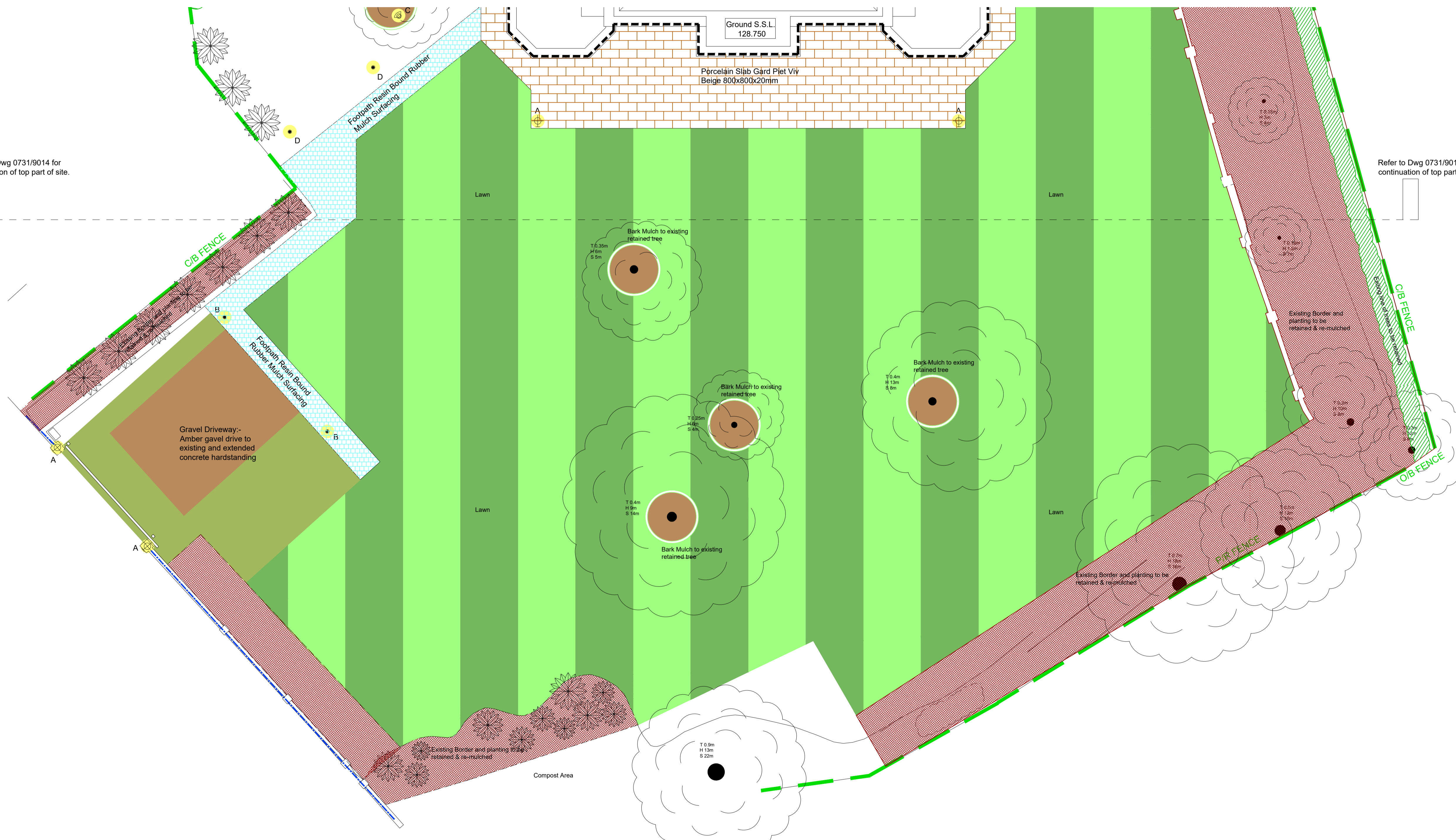

A	Planning Issue	30.01.24
Revision		Date



Octagon Developments Ltd
Weir House, Hurst Road, East Molesey, Surrey KT8 9AY
020 8481 7500 | octagon.co.uk

Project
Mill House, Mill Corner Hadley Highstone
Title
Site Plan
Landscape Plan Sheet 2

Status		
Construction		
Scale	Drawn	Date
1:100	NAK	Jan 24
Job number	Drawing number	Revision
0761	9015	A