

01 Existing Floor Plan
Scale 1:50

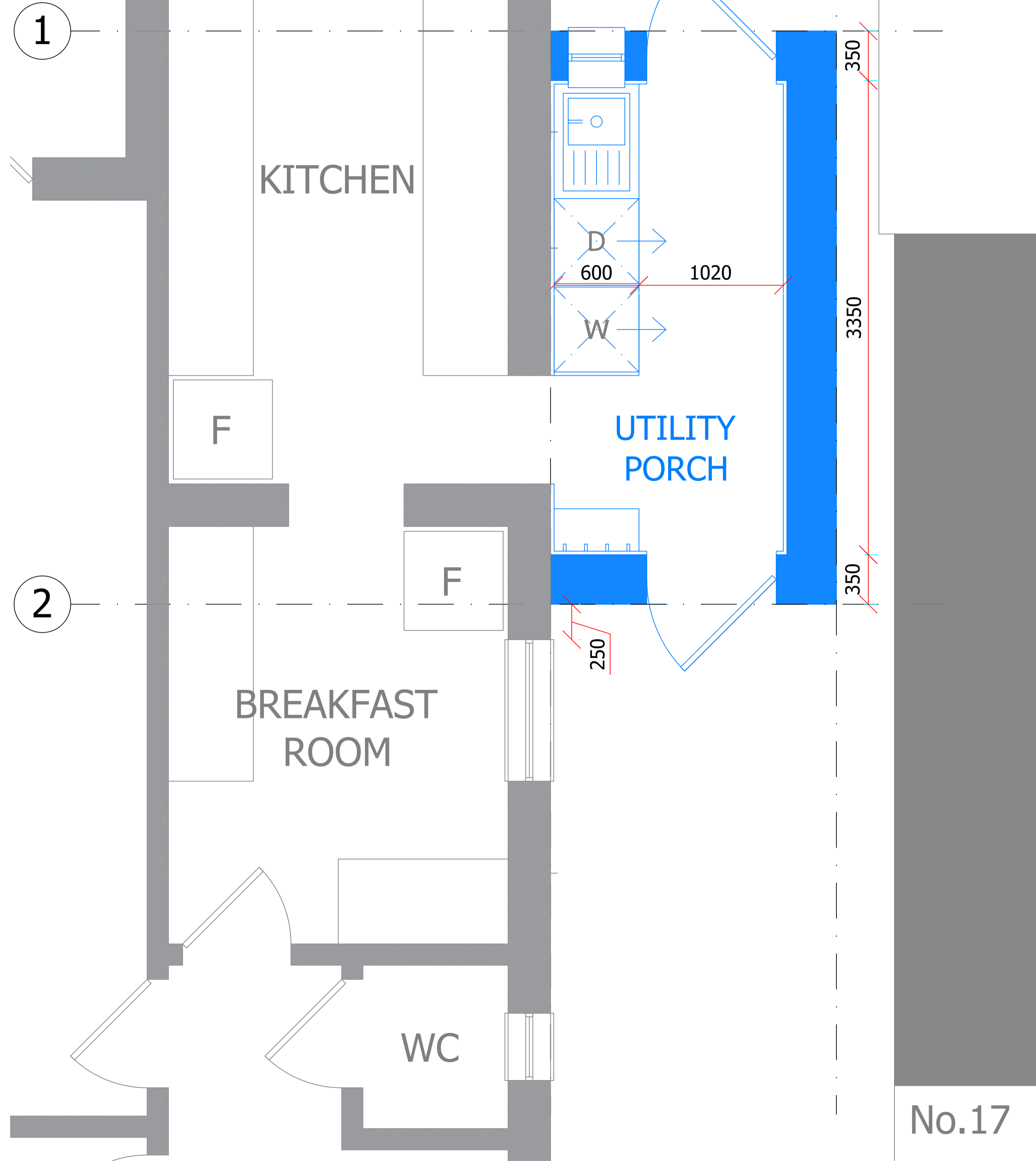

02 Proposed Floor Plan
Scale 1:100

GENERAL NOTES
 Drawing issued for the purpose of coordination.
 All boundaries, dimensions and levels are to be checked on site before construction and any discrepancies reported to 3RD BRIDGE ARCHITECTS LTD.
 Drawing shall not be scaled to ascertain any dimensions, work to figured dimensions only. Measurements for construction must be taken on site.
 Drawing shall not be reproduced without express written permission from 3RD BRIDGE ARCHITECTS LTD.
 When issued in CAD format, it is an uncontrolled version issued for information only, to enable recipients to prepare their own documents/drawings.
 All drawings to have Building Control sign off before commencement of works.
 All structural elements to be signed off by Structural Engineer and agreed with Building Control prior to commencement of works.
 Windows drawn as design intent, to be measured and designed by specialist in line with Building Regulations.
 Service strategy to be agreed on site with contractor prior to commencement of works.

PROJECT NOTES
 Project to be described as a 'Single story side extension'.
 All proposed materials to match existing design.

DRAWING REVISIONS

| Revision | Description | Date |
|----------|------------------------|----------|
| A | First Issue | 03.01.24 |
| B | Second Issue | 07.01.24 |
| C | Issue for Approval | 19.01.24 |
| D | Re-issued for Approval | 23.01.24 |

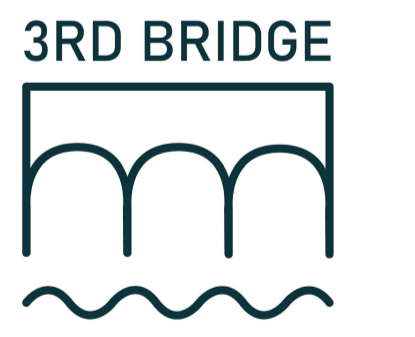

DRAWING INFORMATION

Client
 CHERYL PEARSON

Project Title
 15 CLAREMONT, MARPLE

Project Number
 23006

Drawing Title
 EXISTING & PROPOSED PLANS

Suitability
 APPROVAL

Date
 03.01.2024

Scale
 1:100@A1

Drawing Number
 23006-3BR-DR-A-20001

Revision
 D