

DO NOT SCALE : All dimensions are to be checked and confirmed on site. All discrepancies are to be reported to this Office.
 This drawing and design is protected under copyright, and it shall not be reproduced in whole or part without our prior consent.

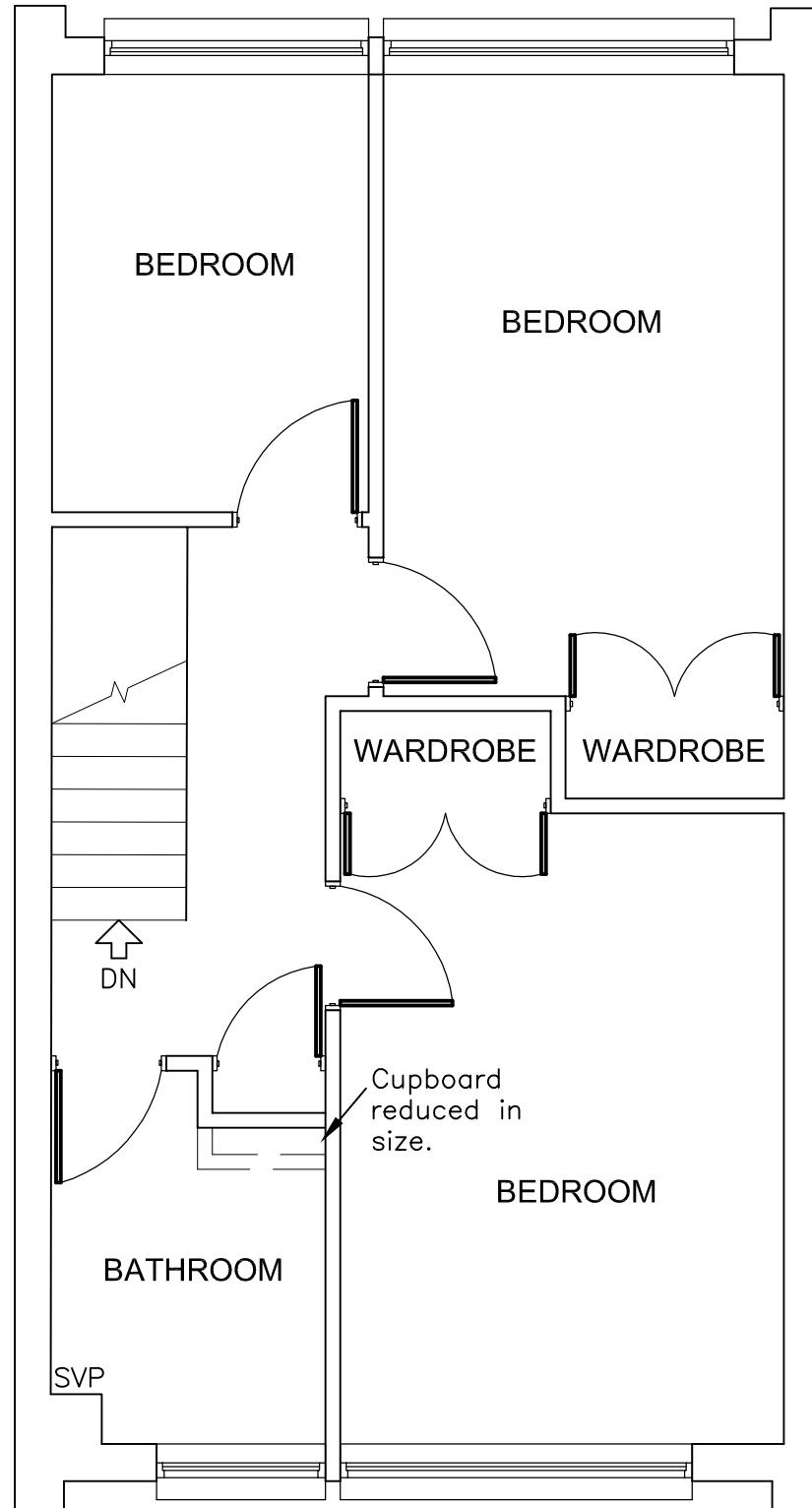

EXISTING SECOND FLOOR PLAN

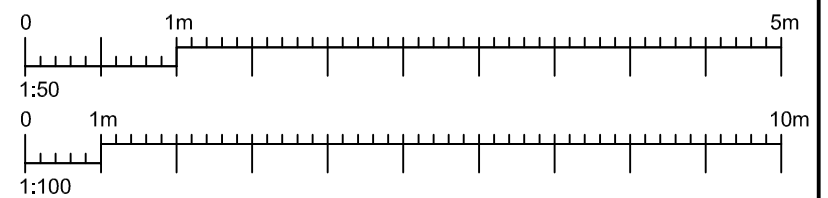

13 KINGSMEAD CLOSE,
 SIDCUP,
 KENT.
PROPOSED INTERNAL ALTERATIONS -
 EXISTING SECOND FLOOR PLAN.

Kelsham Ltd
 CONSULTING STRUCTURAL ENGINEERS
 WILSON HOUSE
 JOHN WILSON BUSINESS PARK, WHITSTABLE
 KENT. CT5 3QT
 Tel : 01227 276503 E-mail : Mail@Kelsham.co.uk

SCALE	1:50 @ A3		
DATE	NOVEMBER 2023	DRAWN BY	N.R.J.
CLIENT			
DRAWING NO.	KL4015/06	REV.	A