

23.30+

Planting Plan for sunken garden

Scale 1:50 @ A3

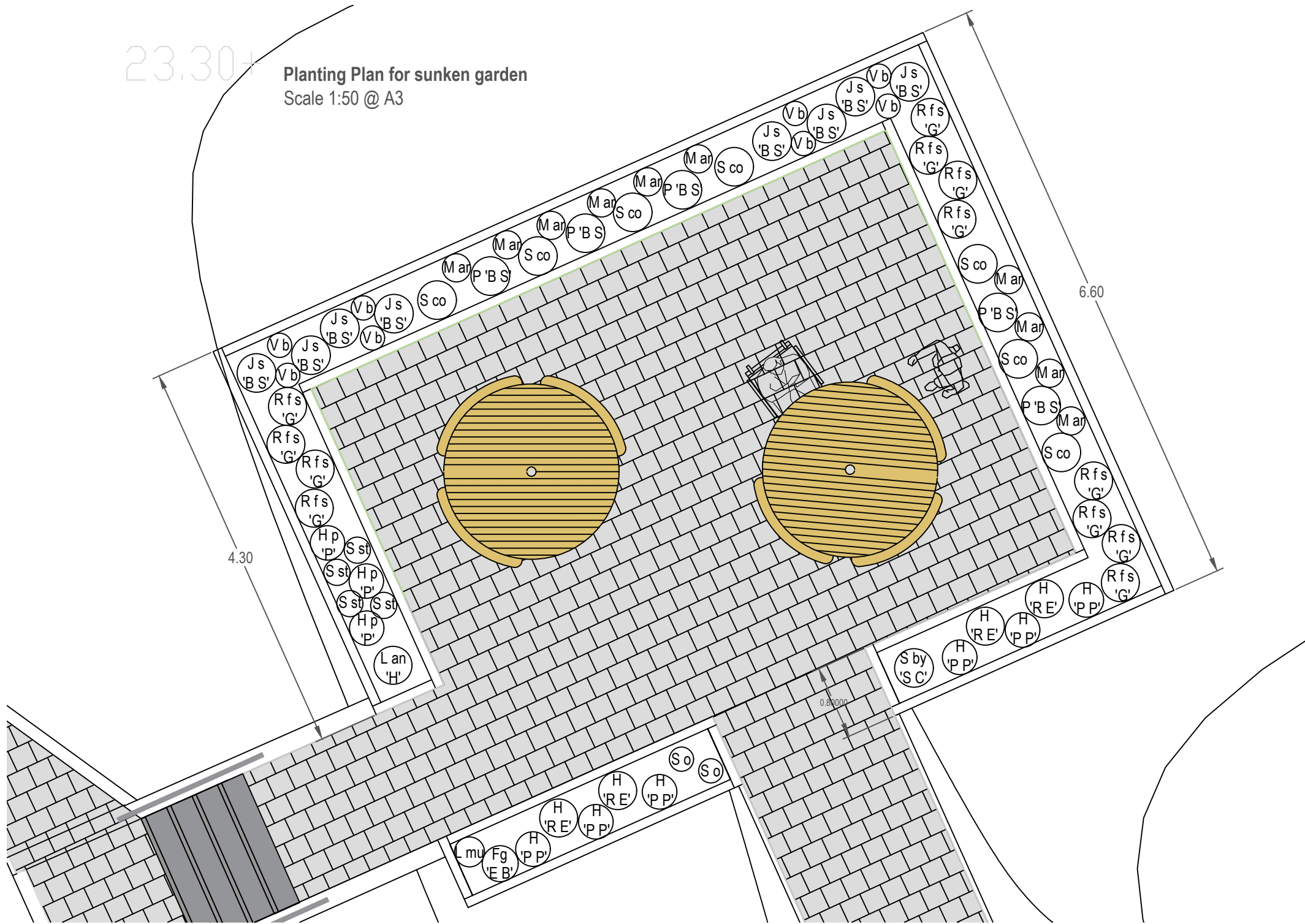

© 2024 Groundwork Greater Manchester

No part of this document may be reproduced by any means without prior written permission.
Groundwork Greater Manchester is a company limited by guarantee and registered in England
Company Registration No. 6543150
Charity Registration No. 1124508

Registered Practice of the Landscape Institute.

Do not scale from this drawing (Original drawing size A3)



Notes:

Project : **Maghull Health HC Sunken Garden**

Title : **Planting Plan**

Date : 01/2024 Drawn by : NL

Scale : 1:50 @ A3 Checked by :

Issue : Dwg status :

Revision No : D

Drawing No : **GGM 2608 12**

Conifer; stated species and size.

- 8nr. J s 'B S' Juniperus squamata 'Blue Star' : 25-30cm spread; container 5L; bushy.

Shrubs; stated species and size.

- 3nr. H p 'P' Hebe pinguifolia 'Pagei' : 20-30cm spread; container 3L; bushy; 5 breaks
- 4nr. H 'R E' Hebe 'Red Edge' : 30-40cm spread; container 5-7.5L; bushy; 7 breaks
- 1nr. L an 'H' Lavandula angustifolia 'Hidcote' : 20-30cm high; container 5L; bushy; 7 breaks
- 5nr. P 'B S' Perovskia 'Blue Spire' : 30-40cm high; container 3L; bushy; 3 breaks
- 6nr. S co Sarcococca confusa : 30-40cm high; container 5L; bushy; 6 breaks

Herbaceous; stated species and size

- 6nr. H 'P P' Heuchera 'Plum Pudding' : container 2L; full pot
- 12nr. R f s 'G' Rudbeckia fulgida sullivantii 'Goldsturm' : container 2L; full pot
- 2nr. S o. Salvia officinalis : container 1L; full pot
- 4nr. S st. Sisyrinchium striatum : container 0.5L; full pot
- 1nr. S by 'S C' Stachys byzantina 'Silver Carpet' : container 2L; full pot
- 8nr. V b. Verbena bonariensis : container 2L; full pot

Bulbous; stated species and size

- 10nr. M ar Muscari armeniacum : container 0.5L; full pot

Grasses; stated species and size.

- 2nr. F g 'E B' Festuca glauca 'Elijah Blue' : container 2L; full pot
- 2nr. L mu. Liriope muscari : container 3L; full pot

**GROUNDWORK
GREATER MANCHESTER**

Trafford Ecology Park
Lake Road
Trafford Park
Manchester M17 1TU
Tel: 0161 220 1000

