

LEGEND	
A/C	Air conditioning unit
AV	Air valve
BB	Bellisho beacon
BL	Bollard
BS	Bus stop
BT	British telecom
CATV	Cable TV
CCTV	Close circuit TV
CL	Cover level
CB	Control box
DC	Drainage channel
DP	Down pipe
ELP	Electricity lamp post
EP	Electricity pole
ER	Earth rod
FH	Fire hydrant
FP	Fender post
FWS	Foul water sewer
G	Gully
GV	Gas valve
IC	Inspection cover
IL	Invert level
LB	Letter box
LP	Lamp post
KO	Kerb outlet
MH	Manhole
MP	Marker post
RE	Rodding eye
RNB	Road name board
RP	Reflector post
RS	Road sign
RWP	Rain water pipe
SC	Sign post
SP	Stop cock
SV	Sign post
SWS	Surface water sewer
SY	Stay
TCB	Telephone call box
TP	Telephone pole
U/C	Unknown cover
UTL	Unable to lift
VP	Vent pipe
WB	Waste bin
WC	Water cover
WM	Water meter
WO	Wash out

**NOTES:**  
 This drawing is copyright and may not be reproduced without the permission of A & B Surveys.  
 Drainage pipe sizes (where shown) have been determined from the surface and should be regarded as approximate only.  
 Drainage runs between inspection covers have not been investigated or proven and should be confirmed prior to any design or construction.  
 Tree species (where shown) should be treated with caution and expert identification is advised.  
 Tree Dimensions are approximate and expert measurement is advised.  
 g = girth      sp = spread  
 c/l = crown level

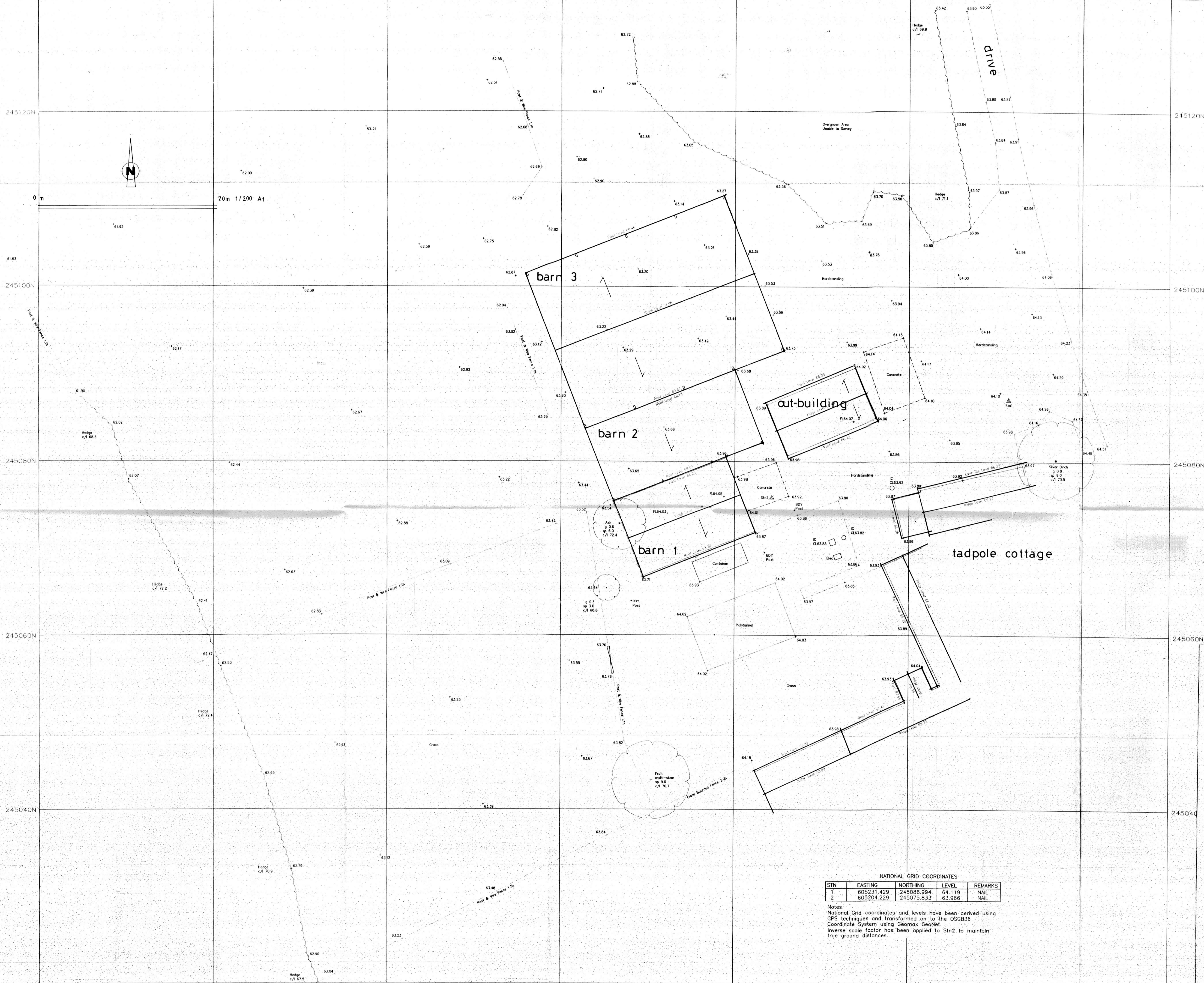

NATIONAL GRID COORDINATES

STN	EASTING	NORTHING	LEVEL	REMARKS
1	605231.429	245086.994	64.119	NAIL
2	605204.229	245075.833	63.966	NAIL

Notes  
 National Grid coordinates and levels have been derived using GPS techniques and transformed on to the OSGB36 Coordinate System using Geomax GeoNet.  
 Inverse scale factor has been applied to Stn2 to maintain true ground distances.

**dean jay pearce**  
 architectural design & planning ltd  
 2 / 3 Milestone, Hall Street, Long Melford  
 Sudbury, Suffolk, CO10 9HZ  
 T: 01787-378797 E: dean.pearce@live.co.uk

**Project:**  
 Proposed erection of 1no. self-build dwelling and ancillary outbuilding, change of use of land and associated works (following demolition of 3no. existing barns) utilising existing vehicular access (following approvals under re: DC/23/04294/FUL & DC/22/03636).

**Site Address:**  
 Land and Barns at Frog Hall Farm, The Street, Aldham, Suffolk, IP7 6NH

**Applicant:**  
 Mr H C Brown

**Drawing title:**  
 EXISTING (TOPOGRAPHICAL) SITE PLAN

**scales:** 1:200 (A1)      **drg no:**      **rev:**

**date:** 01 / 2024      **drawn:**      **checked:**      **23/91/01**

Do not scale this drawing. Use figured dimensions only. Contractor to set out all of the works prior to commencement and report any omissions / discrepancies immediately. Scales shown on this drawing are at A1 sheet size.

This drawing & information are Copyright. ©