

NOTES

AREA CALCULATIONS

The rooms aligns with the Technical housing standards – nationally described space standard.

A double (or twin bedroom) has a floor area of at least 11.5m², one double (or twin bedroom) is at least 2.75m wide and every other double (or twin) bedroom is at least 2.55m wide

NATURAL LIGHT

All habitable rooms receive natural light (sunlight). The minimum size of the window area is 10% of the floor area of the room...

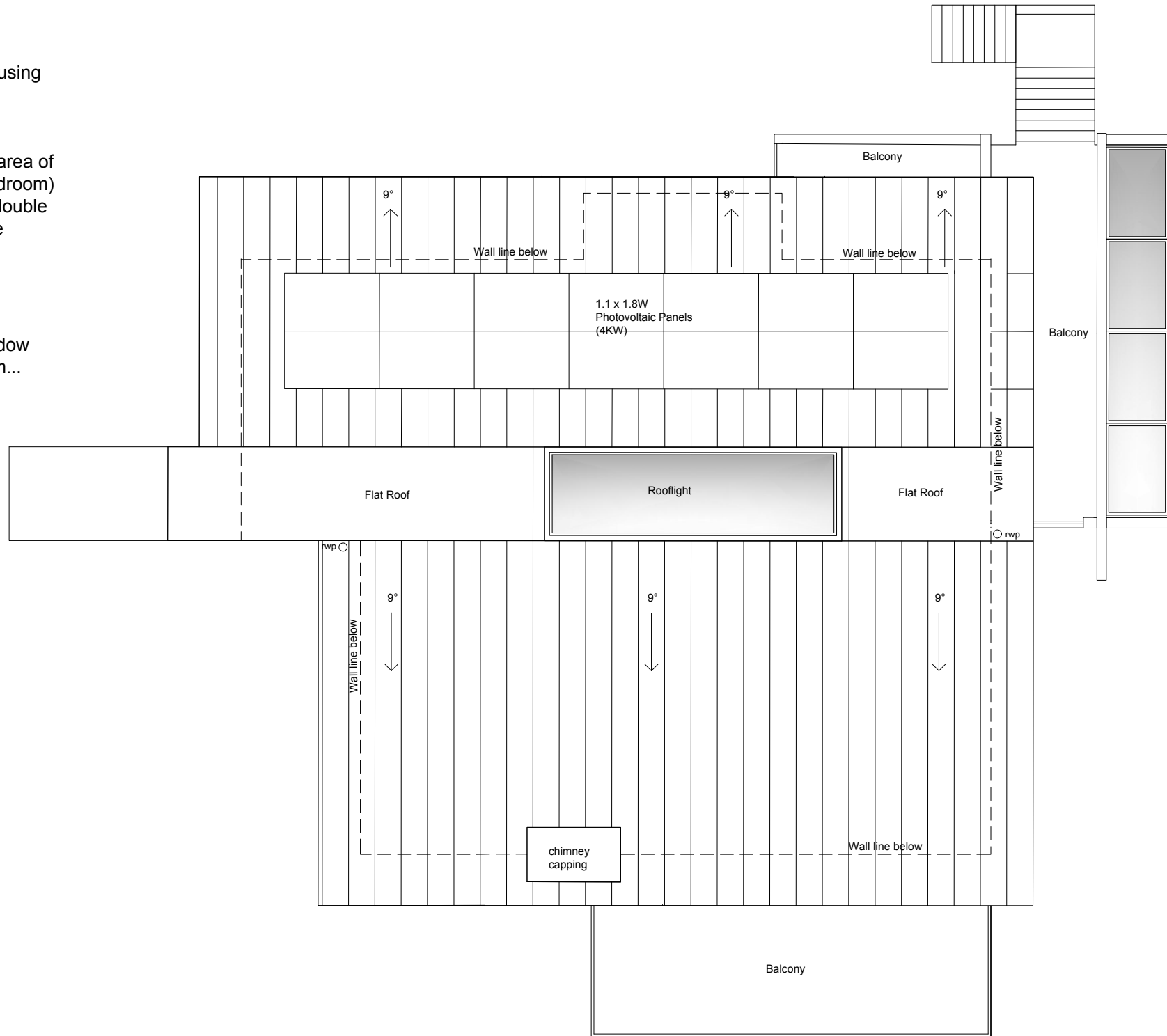

NOTES

It is considered important to the client that the design and construction of the proposed building incorporates sustainable measures

The new development not only provides a high standard of design, but also incorporates the client’s vision of building a low carbon house integrating sustainable construction measures. Consideration is given to the implementation of renewable energy opportunities. Such measures are to include

- Natural lighting and ventilation.
- Incorporation or utilisation of recycled building materials from the existing house.
- Low carbon materials such as zinc and timber frame, of which have already reduced CO₂ emission from the environment. The materials can also later be recycled if necessary.
- solar PV (photovoltaic) panels incorporating a Hybrid System with Battery
- an air source heat pump

HIGH QUALITY DESIGN

The development represents design excellence that will deliver a high-quality dwelling, which responds to its context, surrounding built form, and landscape qualities of the area.

The proposal will provide a modernized and improved family home for our clients, which celebrates the local views.

The proposed development is consistent with the thrust of national and local planning policy, whilst meeting the needs of the applicant.

1. PROPOSED ROOF PLAN (1:100 SCALE)

PLANNING DRAWINGS ONLY
This status indicates that the drawings are design intentions for planning approvals only.

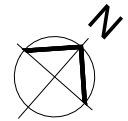
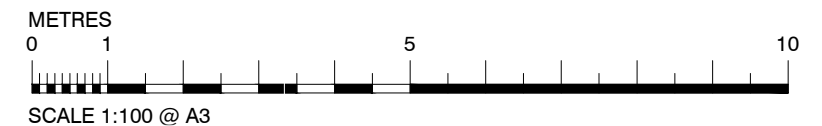

Rev.	By	Description	Date