

READ ONLY WITH NOTES OF COMPLIANCE  
SCALING OF THIS DRAWING CAN BE DONE ONLY ON FIRST CERTIFICATION COPIES SUPPLIED WITH THE PLANNING OR BUILDING REGULATIONS APPLICATIONS  
OTHERWISE USE WRITTEN DIMENSIONS ONLY  
**THIS DRAWING IS COPYRIGHT ownership remains with Simon Spencer MCIAT**  
It has been prepared specifically for this client and is not transferable

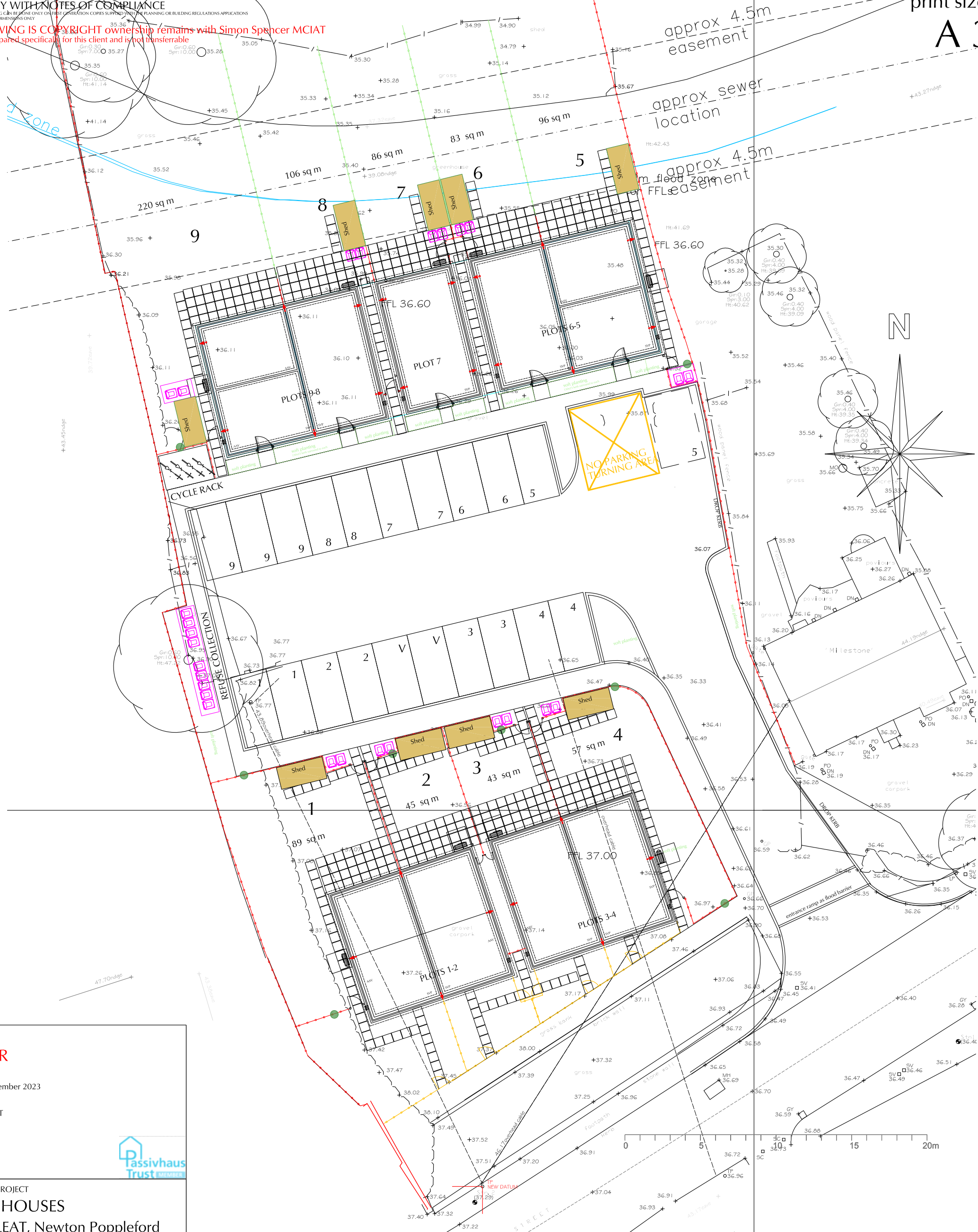

ISSUE STATE  
**TENDER**  
SCALE 1:250  
DATE December 2023  
DRAWN S  
AMENDMENT



CLIENT AND PROJECT  
**9 NEW HOUSES**  
WATERLEAT, Newton Poppleford  
OFAH Properties Ltd  
DRWG TITLE  
**ENCLOSURES TREATMENTS**  
DRWG NUMBER  
**22.45 SP 08**

**Simon Spencer mciat**  
Chartered Architectural Technologist



Moor Lane House, Talaton Exeter EX5 2RG  
mob 07973 653 758  
E mail Simon@Spencer.co.uk  
http://www.sspencer.co.uk

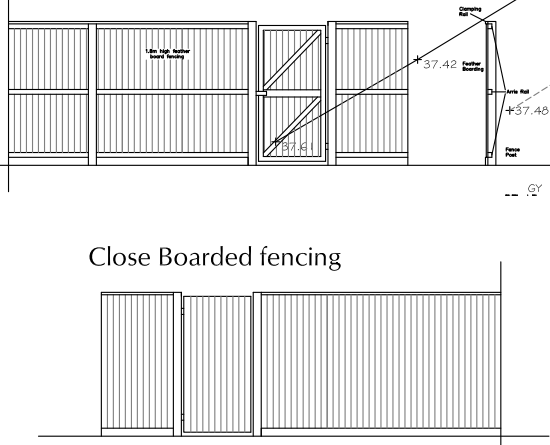

- 600 PICKET FENCE
- 1200 POST AND RAIL FENCE
- 1800 CLOSE BOARDED FENCE AS DETAILED AND INTERGARDEN PRIVACY PANEL EV CHARGEPOINT WIRING ONLY
- ROOF MOUNTED SOLAR PANELS
- hedgehog hole in fencing