

GREEN ROAD

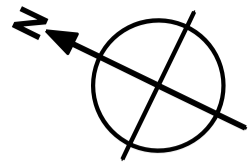

SCALE



TOOT HILL BUTTS

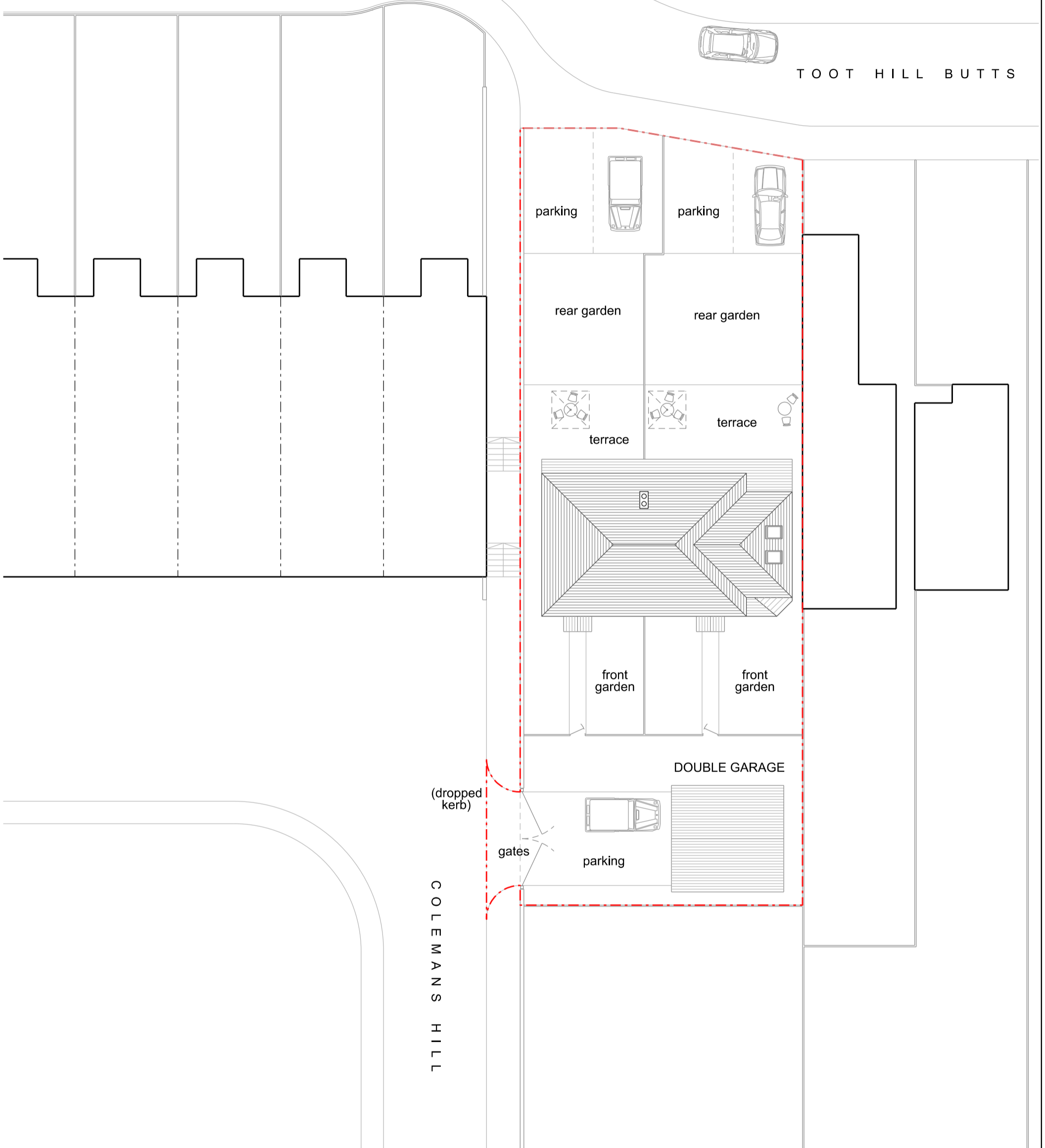

Revision	Notes	Date
A	Draft drawings issued to clients	14.04.22
B	Amendments (in response to recent planning dept feedback)	01.08.22
C	Client-requested amendments	04.12.23

CHRIS DAVIES - ARCHITECT			
Southbank House, Wood End Lane, Newmarket, Nailsworth. Glos GL6 0RH Tel: 01453 834520 Mob: 07825 702625 email: chris@chrisdaviesarchitect.co.uk			
Drawing Title:	Proposed Site Plan (incorporating Roof Plan)		
Project Name:	No.3 Toot Hill Butts, Headington, Oxford	Scale:	1-200@A3
Drawing No:	THBO-LAY-02-C	Date:	April 2022
Revision:	C		