

KEY	
GOOD TREES A	
MODERATE TREES B	
POOR TREES C	
DEAD/ WEAK TREES TO REMOVE U	
TREE ROOT PROTECTION AREA (RPA)	
OFF SITE TREES (not surveyed)	
INDICATIVE TREE PROTECTION - HERAS 2.1m on stabilised strut BS5837:2012 p21 fig3 (see indicative diagram)	
APPLICATION SITE	

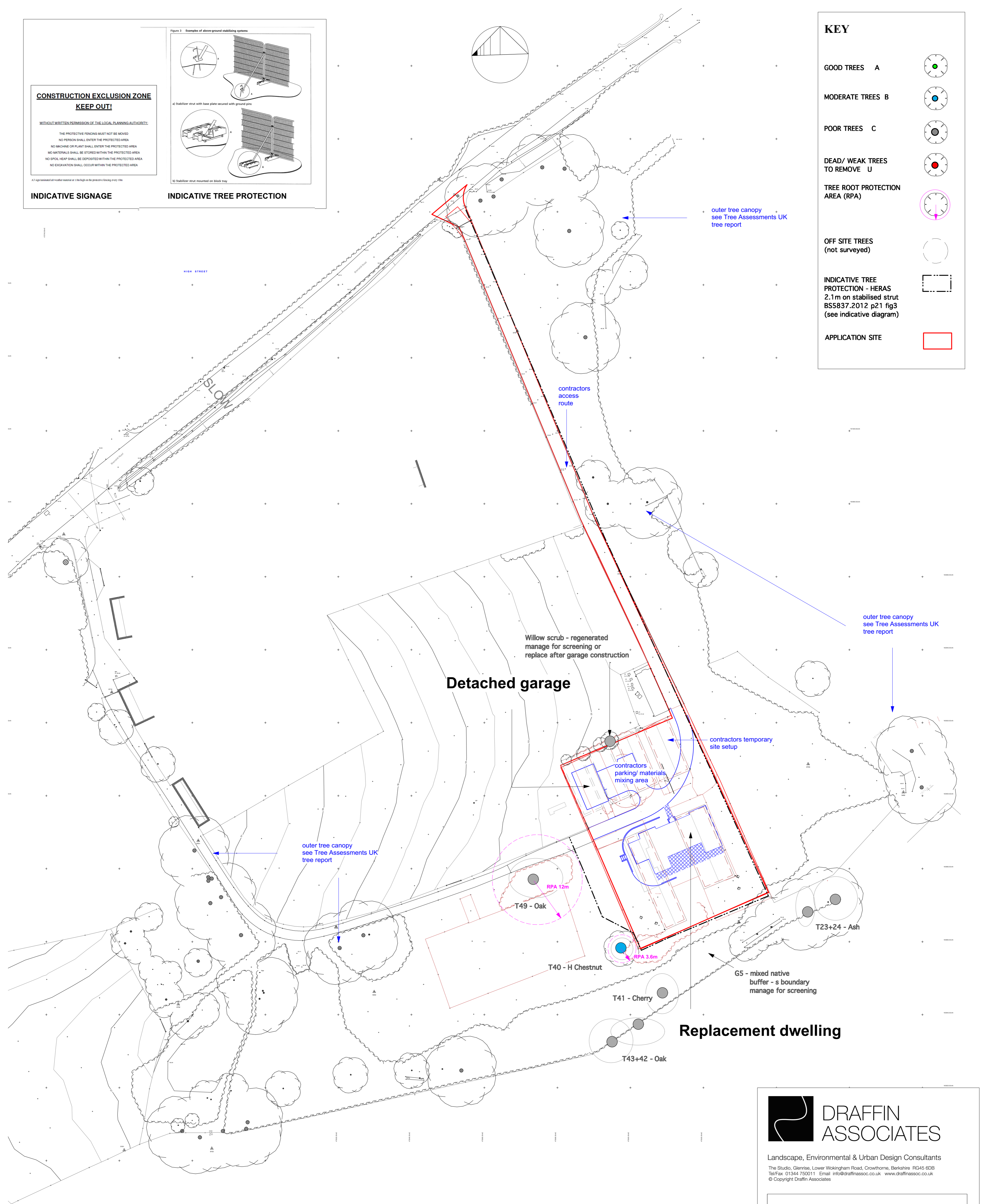

**GENERAL**

All landscape works subject to  
 BS.3882:2015 - Recommendations for topsoil  
 BS.3998:2010 - Recommendations for treework  
 BS.4043:1989 - Recommendations for transplanting rootballed trees  
 BS.4428:1989 - Recommendations for general landscape operations  
 BS.5837:2012 - Trees in relation to demolition, design & construction  
 BS.8545:2014 - Recommendations for trees  
 BS.8601:2013 - Recommendations for subsoil  
 BRE 2007 - Code of sustainable homes technical guide

**DRAFFIN ASSOCIATES**  
 Landscape, Environmental & Urban Design Consultants  
 The Studio, Glenrise, Lower Wokingham Road, Crowthorne, Berkshire, RG45 6DB  
 Tel/Fax: 01344 750011 Email: info@draffinassociates.co.uk www.draffinassociates.co.uk  
 © Copyright Draffin Associates

**Mr & Mrs Barney**

**addendum TREE PROTECTION PLAN**  
 (inner construction zone only - see DA AMS rpt - as overlay on D&J Arthur site layout 12/23-ref TREE ASSESSMENTS UK full site tree rpt 10/21)

**Proposed replacement dwelling**  
 Whitewater Stables  
 Bramshill Rd  
 Heckfield RG27 0LA

Scale: 1:500 @A1-1:1000@A3 Date: 1/24 Drawing no: 808/1 Revision: 808/1/02  
 Status: **PLANNING**

**SITE PLAN**