

SPD Statement

The existing property is a detached Bungalow c.1950 with a later Extension & Conservatories. The proposal is to remove the side conservatory and replace it with a Porch and to the rear a Shower Room.

The Side Conservatory is located on the South East Side of the property and potentially could overheat during the summer and be quite cold during winter. The replacement Porch is of more substantial construction with a solid roof so will not be subject to such issues resulting in a more balanced internal environment resulting in a reduced need for heating or cooling.

The proposed works have no impact on the existing rooves which could be used for installation of solar panels at a later date if required.

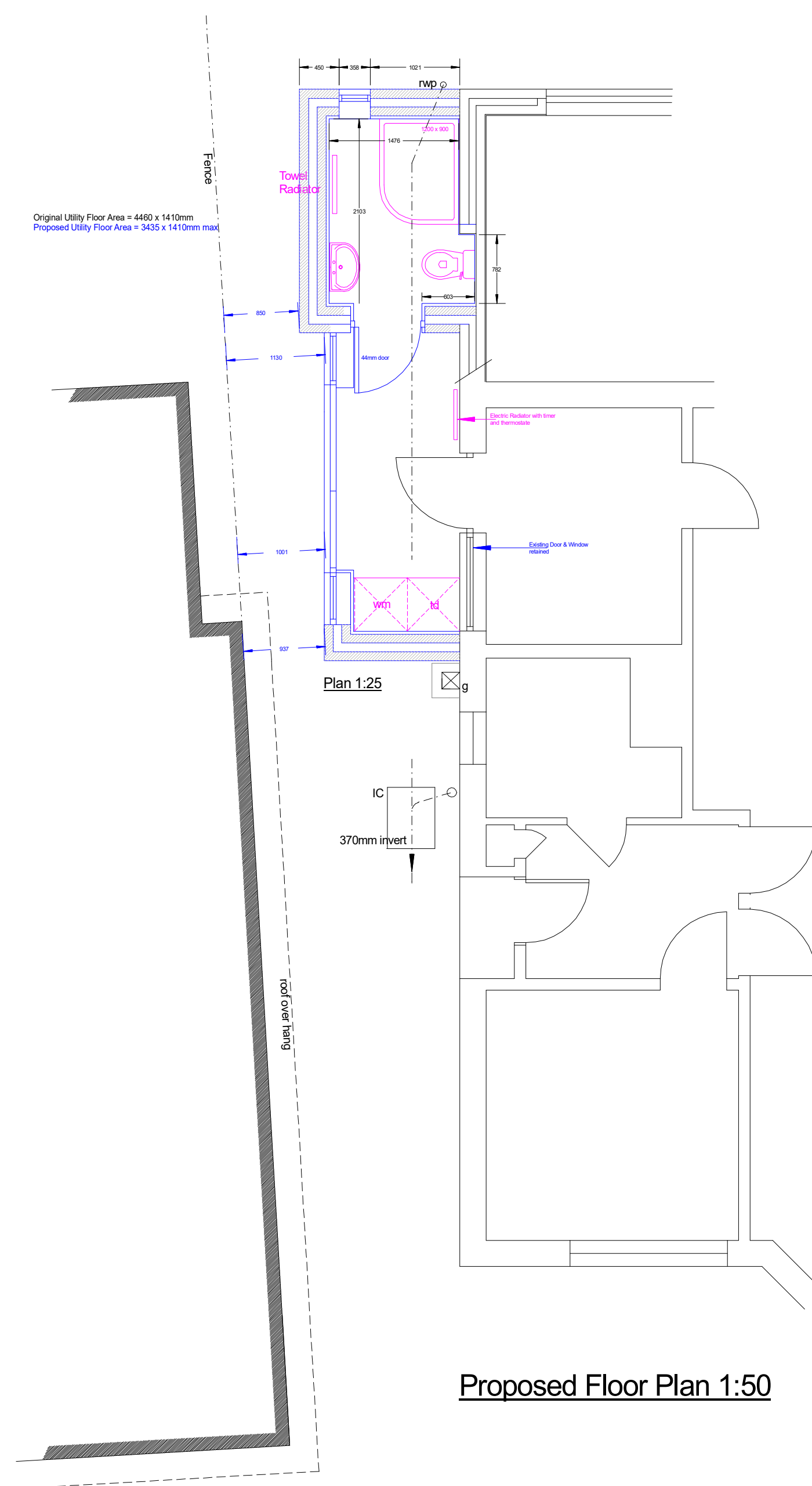
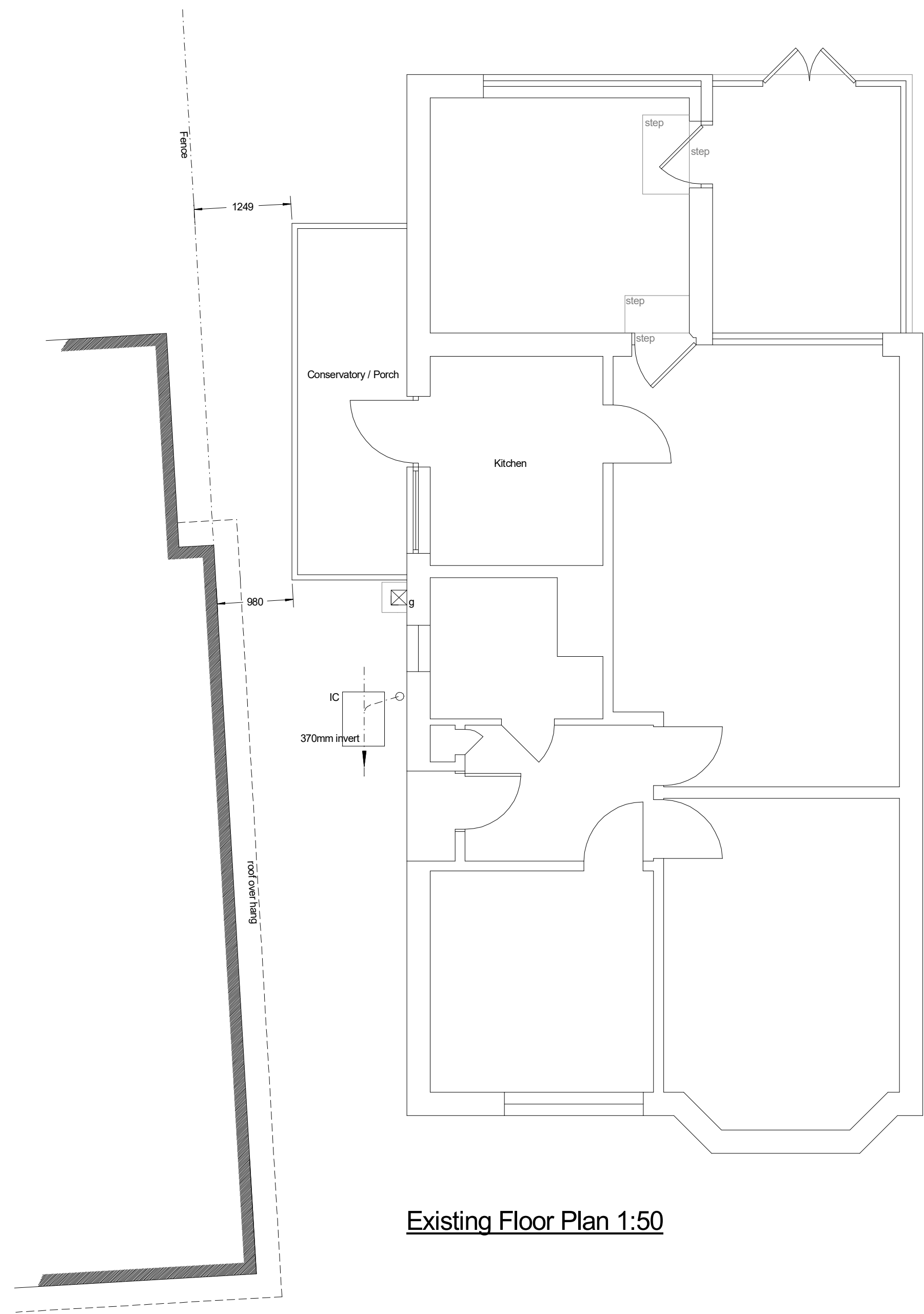

REVISION	DATE	DESCRIPTION
		<p>ARCHITECTURE for EVERYDAY LIFE</p> <p>VJM DESIGN HOUSE</p> <p>26 Whaddon Road, Cheltenham, Glos. GL52 5NA T: 01242 227197 E: enquiries@vjmdesignhouse.co.uk</p>
CLIENT		Barbara Lover
PROJECT		37 Winchester Way GL51 3EZ
DRAWING TITLE		Proposed Side Extension
SCALE	DATE	DRAWN BY
1:50, 1:25	29.01.24	VJM
DRAWING NUMBER		REV
2023.046.Planning		