

Proposed First Floor Plan

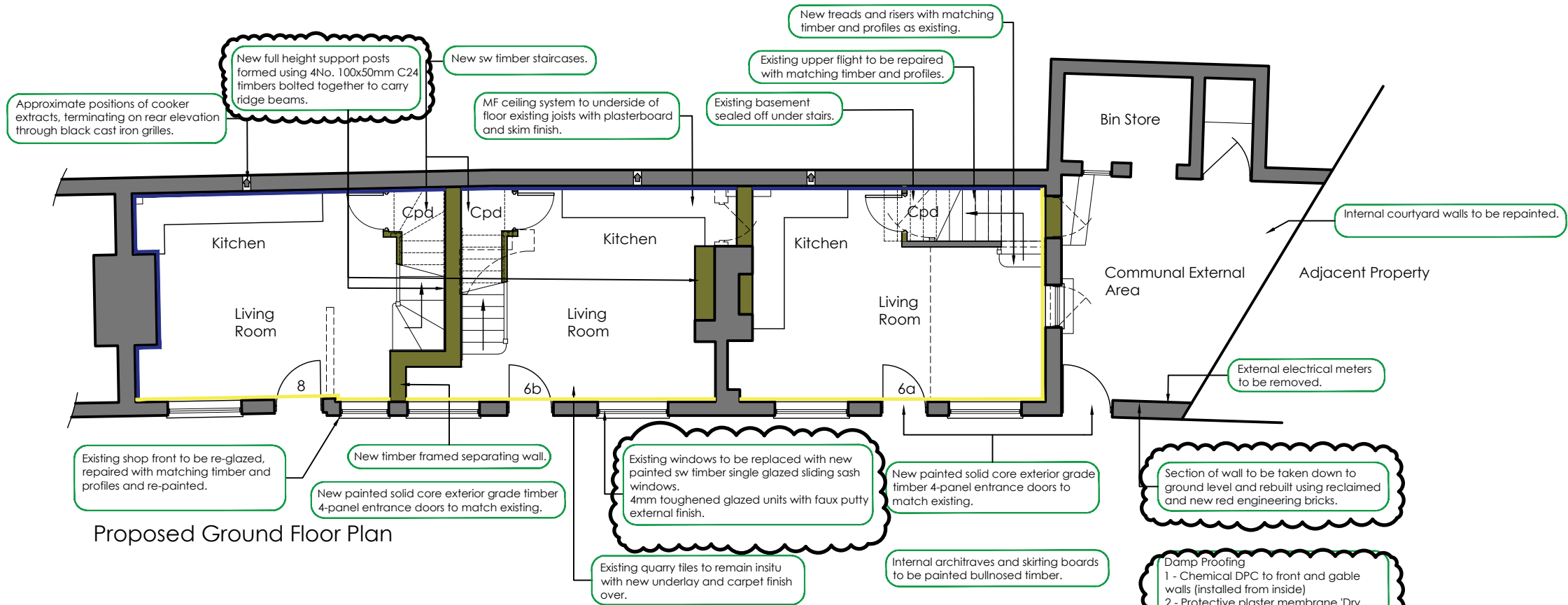

Proposed Ground Floor Plan

- Key:**
- Existing to be retained
 - New construction
 - Demolition
 - 20mm insulated lime plaster with solo finish plaster.
 - Independent Timber stud with 75mm insulation.



Rev	Date	By	Description	Chkd
3	12.07.2023	JEB	Additional notation added for discharge of planning.	-
2	12.03.2021	JEB	Issued for discharge of planning conditions.	-
1	08.02.2021	JEB	Notation revised.	-

MEIN Henry Mein Partnership Ltd
Architects & Interior Designers
3 Russell Place | Nottingham | NG1 5HJ
0115 947 6065 | info@henrymein.co.uk | henrymein.co.uk

Project:
6 to 8 Portland Street,
Newark, Nottinghamshire, NG24 4XG.
Drawing Title:
Proposed Floor Plans

Date:	27.01.2021	Scale:	1:100	Drawn By:	JEB
Revision:	P3	Media:	A3	Checked By:	-

Drawing Status:
PLANNING

Drawing No.
7526 MEIN-XX-XX-DR-A-20-006

No part of this publication may be reproduced, stored in any retrieval system or transmitted in any form or by any means without prior permission of Henry Mein Partnership Ltd.