

Site Address:  
10 Aberdare Road  
Enfield  
EN3 4JB

Project:  
Proposed Rear Extension  
Site Plan 1:200  
Location Plan 1:1250

Client:

Date:  
Jul. 20

Drawn:  
BS

Drawing Number:  
2427 - 05a

Scale:

Revisions:

Paul Samson  
Chartered Surveyors

Glasgow Stud  
Burnt Farm Ride  
Enfield  
Crews Hill  
EN2 9DY



T: 0208 350 6070  
E: plansam@plansam.co.uk

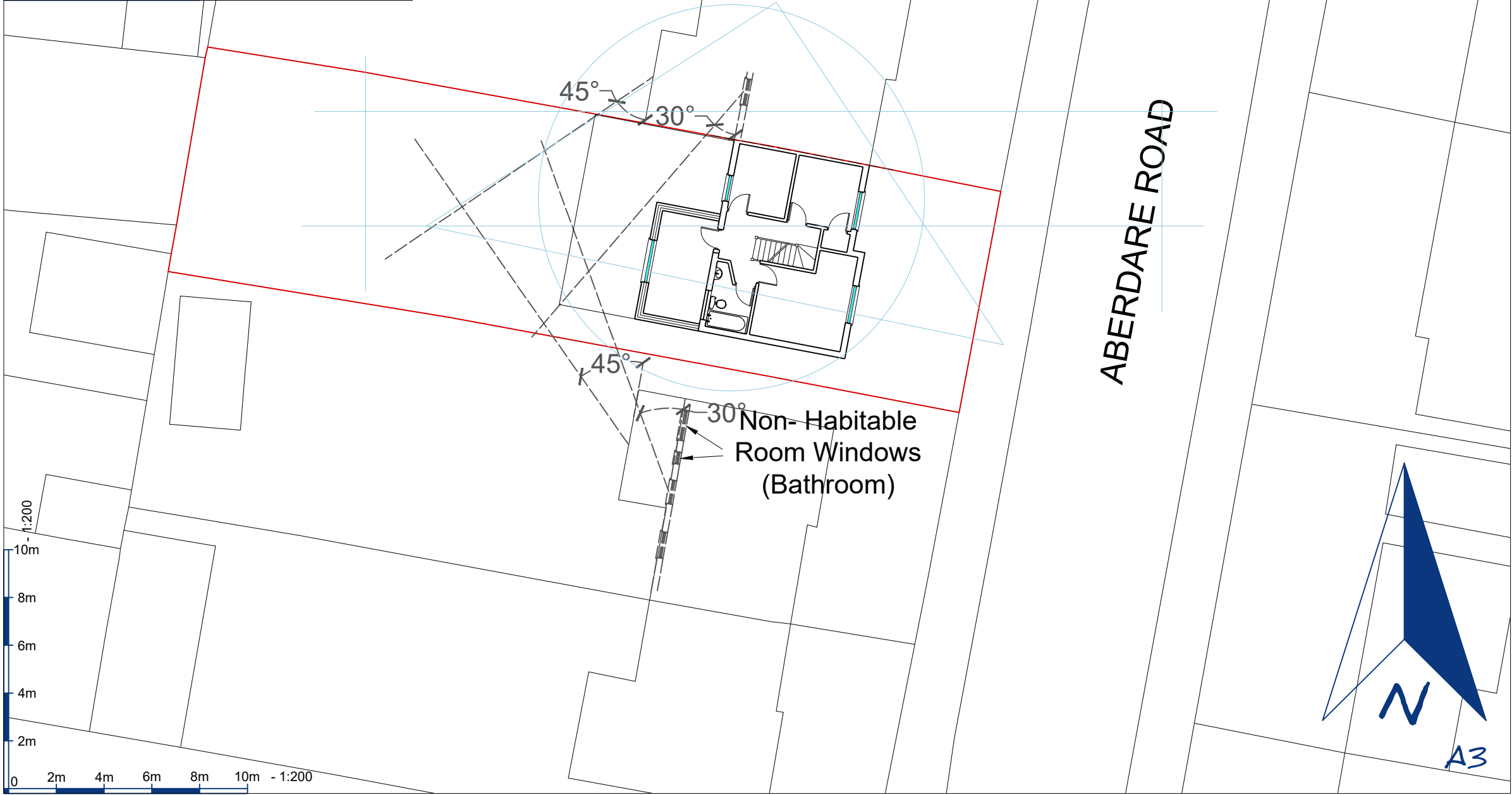
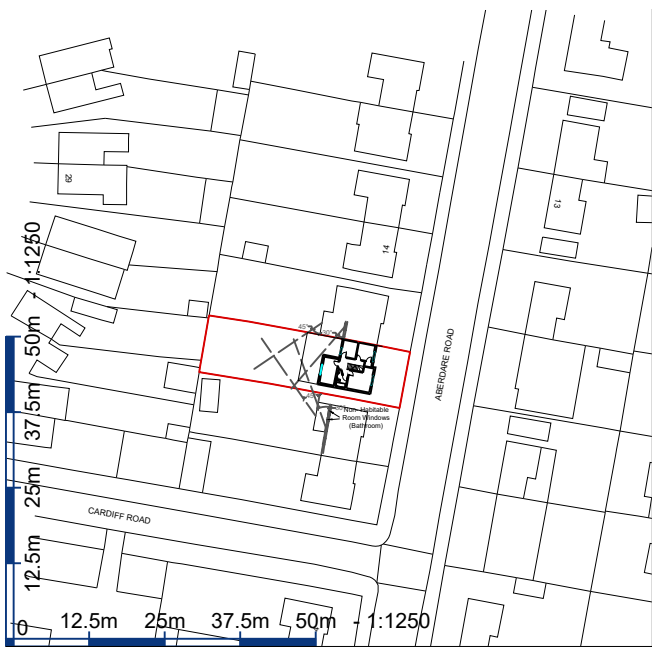

NOTES

All dimensions must be checked on site. This drawings can be scaled for Town & Country Planning Act purposes only and is not to be scaled by contractors or others working on site. Use only figured dimensions. The contractor is responsible for taking and checking all dimensions and levels.

© Copyright Reserved