

Existing Ground Floor Plan

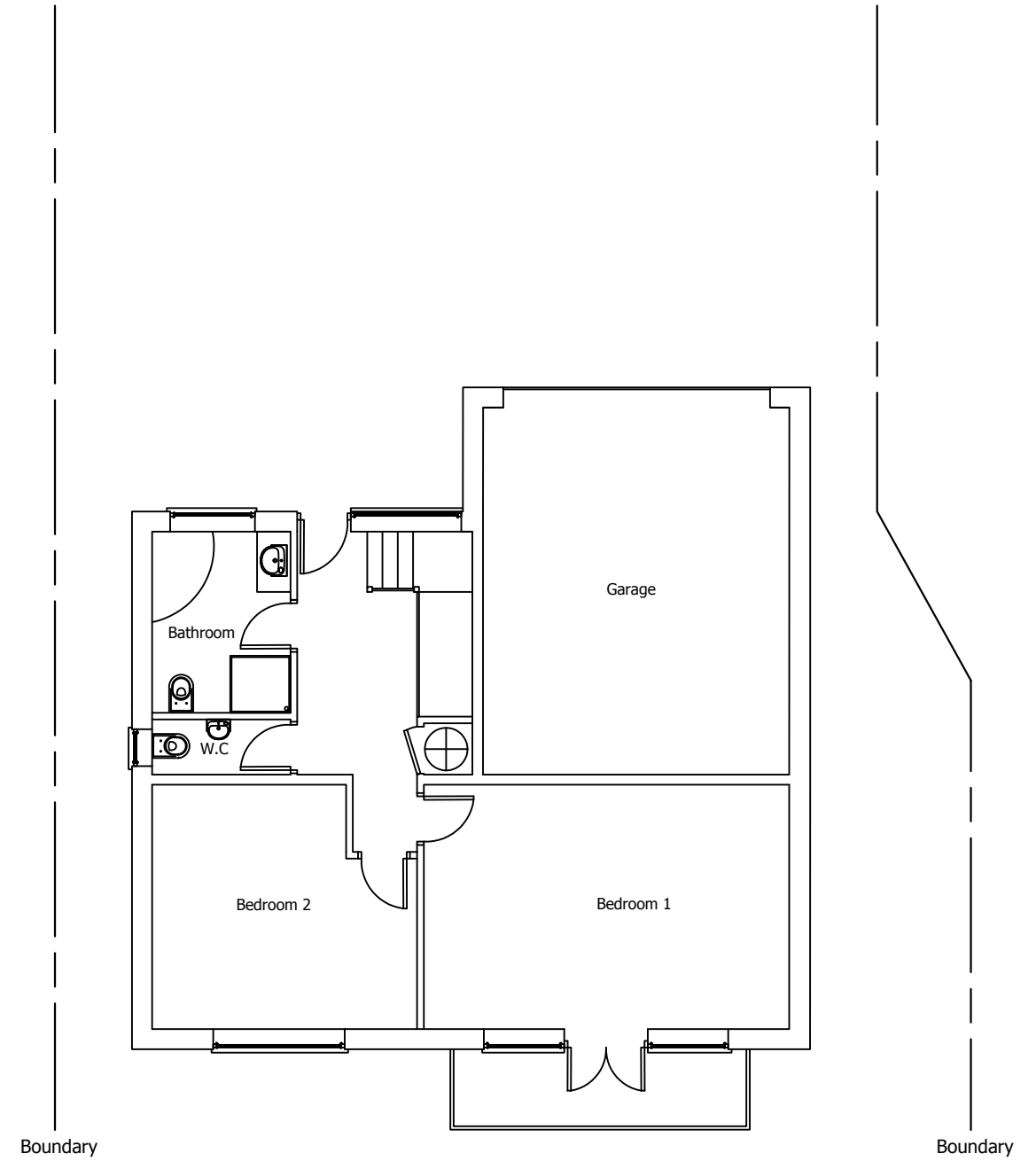

Existing 1st Floor Plan

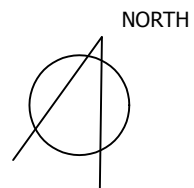
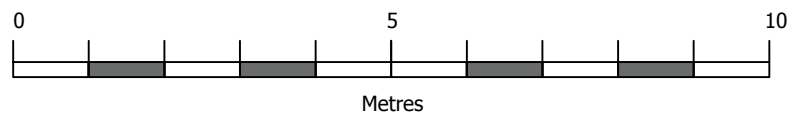

Existing Plans

These drawings should be approved by Local Authority Building Control or other appropriate checking Authority prior to commencement of the work. No dimensions to be scaled from this drawing. All dimensions to be checked on site. This drawing is copyright.

PLANS PREPARED <small>Architectural drawings for planning permission</small>	
<small>8 Greenbank Avenue, Saltdean, Brighton, BN2 8QS Tel: 07930150001 email plansprepared.uk@gmail.com</small>	
<small>Dwg No: TR-001</small>	<small>REV:</small>
<small>Drawn by: JP McCarthy Date: 14/11/23 Scale: 1:100@A3</small>	
<small>Client: David and Helen Collins Project Name: 10 Tumulus Road, Saltdean, Brighton, BN2 8FS Drawing title: Existing Plans</small>	