

SITE LAYOUT

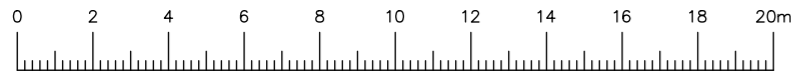

LINEAR SCALE 1:200
A2 @ 1:200

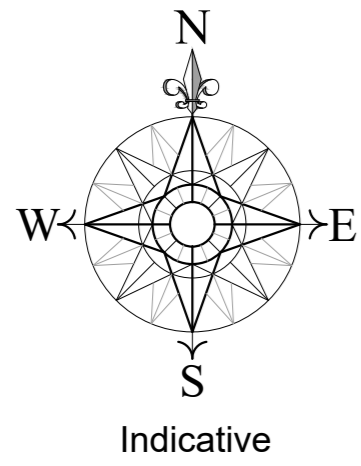

The site is based on a topographical survey undertaken by Paul Stubbington Land Surveys (ref: 5381/01a) Surrounding information copied from Ordnance Surveys Promap. Crown Copyright. Licence Number 100022432

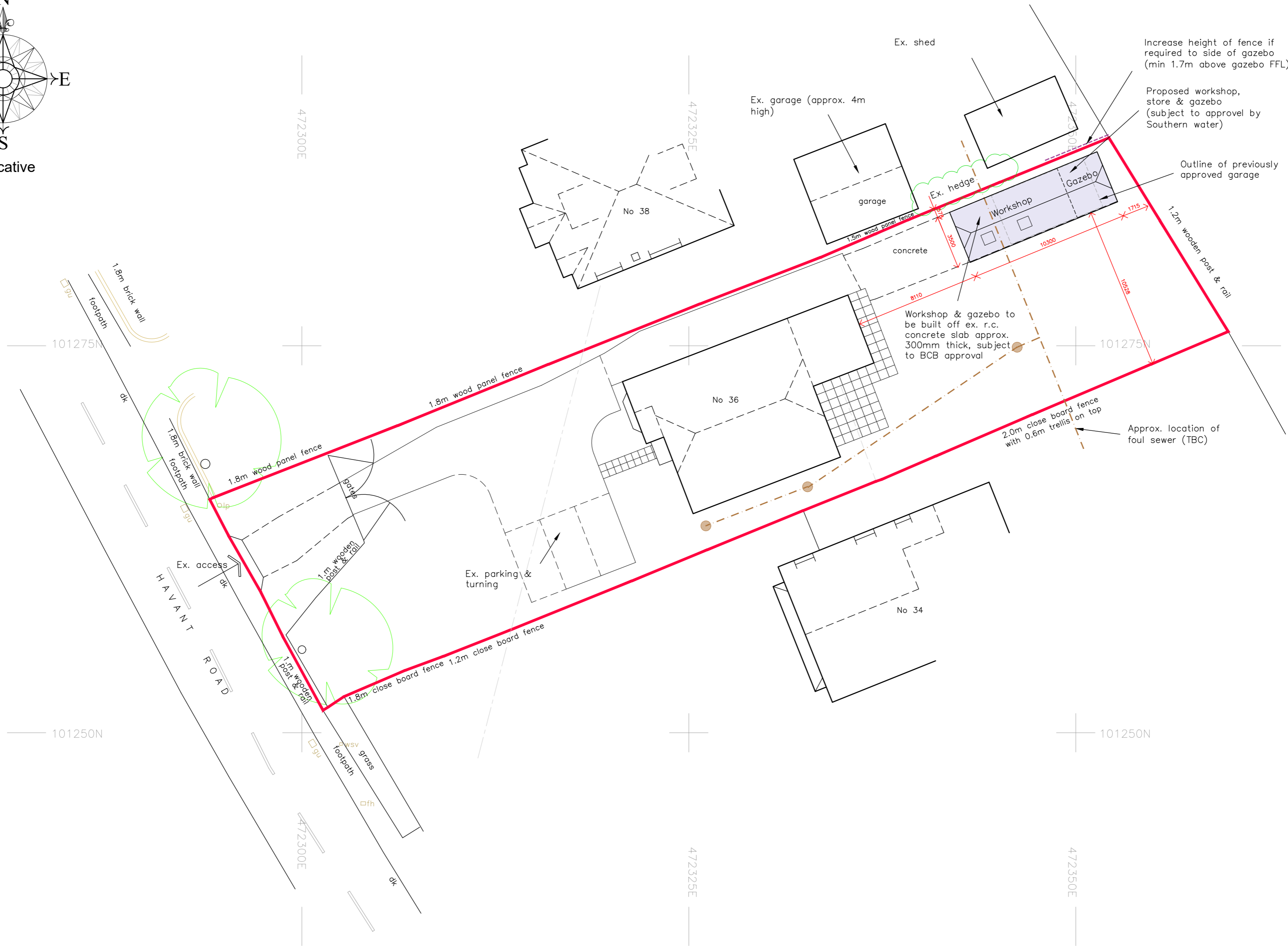

Existing foul drainage

Foul & sw drains where shown are for guidance purposes only & may vary due to site conditions, local water authority & building control approval, etc.

Local water authority approval will be required when building over or close to a sewer. Previously shared private drains are now likely to be considered public sewers.

adp architects & urban designers
Tel: 0845 365 1475
Email: mail@adp-td.co.uk
www.adparchitects.co.uk
Richmond Court, 94 Bolley Road, Park Gate, Southampton, SO31 1BA

project name/address:
Proposed Workshop & Gazebo
36 Havant Road
Hayling Island
PO11 0PX

client:
E Foster
drawing title:
Site Layout

job number:	drawing number:	revision:
2049	01	
drawing scale/site:	date:	drawn:
1:200 (A2)	Jan 24	