

NOTE:
Do not scale (apart from when issued for Planning Application purposes). Figured dimensions only to be taken from this drawing. Dimensions are shown in millimeters unless noted otherwise. Check dimensions on site and report discrepancies to the Architect or Contract Administrator. Not to be used for Construction purposes unless stated.

This drawing is protected by copyright and may not be reproduced without the Architect's written permission. The design is site specific and may not be reproduced on any other site without the Architect's written permission.

All areas have been measured from current drawings. They may vary because of (eg) survey, design development, construction tolerances, statutory requirements or re-definition of the areas to be measured.

This drawing is to be read in conjunction with all relevant details and other consultants information for the project

NOTES:
Existing building demolished - - - - -
To be read in conjunction with:
ARBORICULTURAL IMPACT ASSESSMENT / EAS-079v2

DAGMAR ROAD

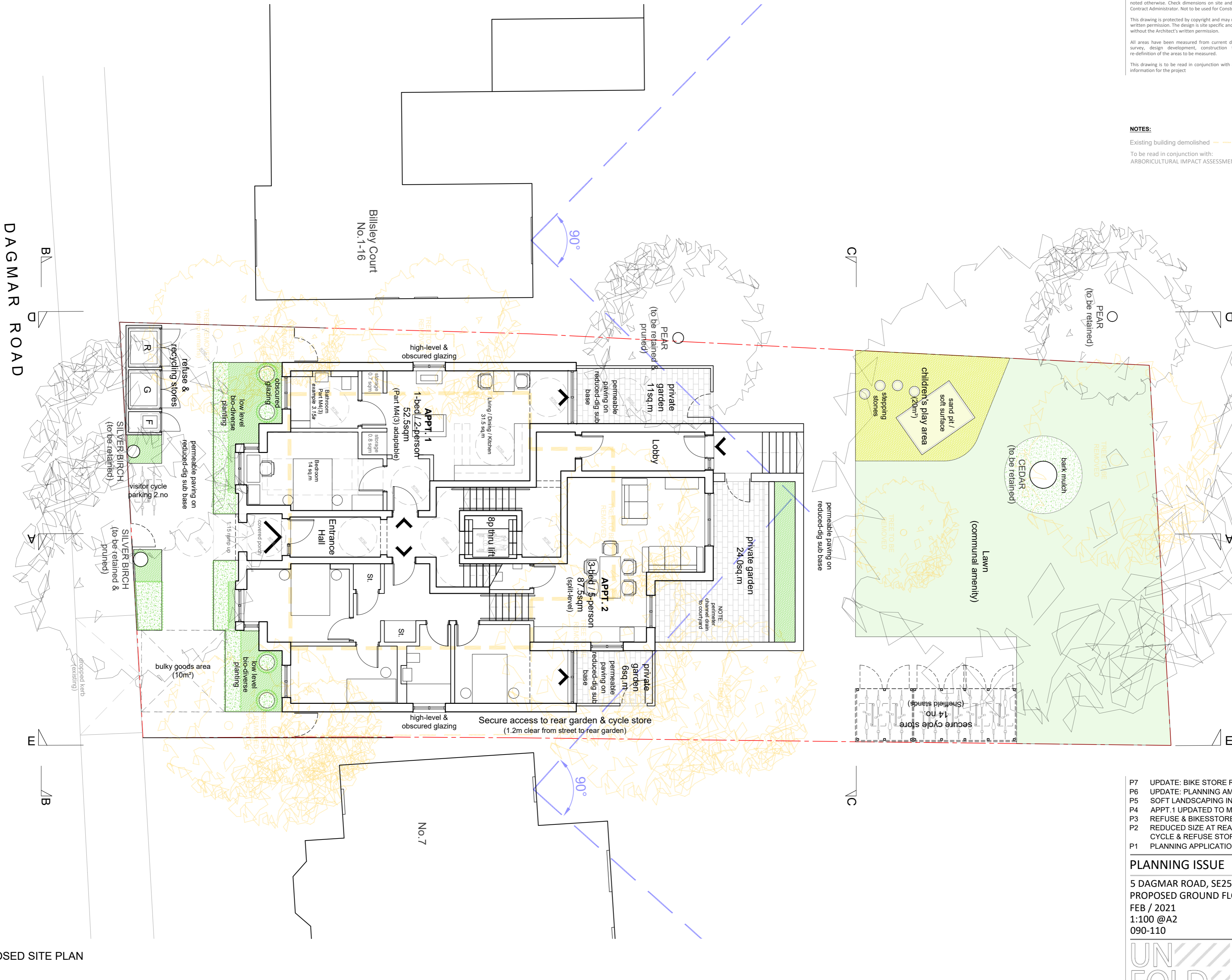

| | | |
|----|-----------------------------------|----------|
| P7 | UPDATE: BIKE STORE RELOCATED | 21/12/23 |
| P6 | UPDATE: PLANNING AMENDMENT | 23/08/23 |
| P5 | SOFT LANDSCAPING INFO ADDED | 03/12/21 |
| P4 | APPT. 1 UPDATED TO M4(3) | 21/06/21 |
| P3 | REFUSE & BIKESSTORE UPDATED | 06/05/21 |
| P2 | REDUCED SIZE AT REAR & LIFT ADDED | 29/04/21 |
| P1 | CYCLE & REFUSE STORES UPDATED | |
| | PLANNING APPLICATION | 26/02/21 |

PLANNING ISSUE
5 DAGMAR ROAD, SE25
PROPOSED GROUND FLOOR / SITE PLAN
FEB / 2021
1:100 @A2
090-110

