

a) Stabilizer strut with base plate secured with ground pins

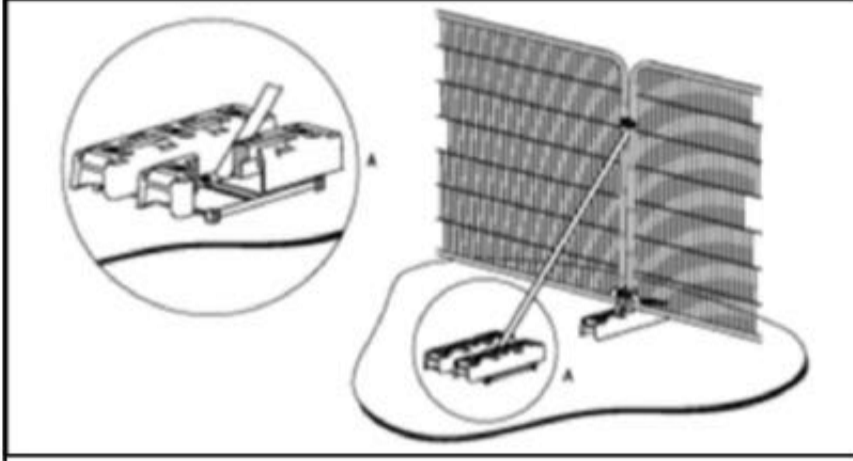

b) Stabilizer strut mounted on block tray

Images taken from British Standard 5837:2012 - Trees in relation to design, demolition and construction - Recommendations

TREE PROTECTION AREA

TREES ENCLOSED BY THIS FENCE ARE PROTECTED BY PLANNING CONDITIONS AND ARE SUBJECTS OF A TREE PRESERVATION ORDER (TOWN & COUNTRY PLANNING ACT 1990)

CONTRAVENTION OF TREE PRESERVATION ORDERS MAY LEAD TO CRIMINAL PROSECUTION

THE FOLLOWING MUST BE OBSERVED BY ALL PERSONS:-

- THE PROTECTIVE FENCING MUST NOT BE REMOVED
- NO PERSON SHALL ENTER THE PROTECTED AREA
- NO MACHINE OR PLANT SHALL ENTER THE PROTECTED AREA
- NO MATERIALS SHALL BE STORED IN THE PROTECTED AREA
- NO SPOIL SHALL BE DEPOSITED IN THE PROTECTED AREA
- NO EXCAVATION SHALL OCCUR IN THE PROTECTED AREA

ANY INCURSION INTO THE PROTECTED AREA MUST BE WITH THE WRITTEN PERMISSION OF THE LOCAL PLANNING AUTHORITY

KEEP OUT!

Root Protection Area and Construction Exclusion Zones

- All tree protection measures will be erected as agreed within the BS5837:2012 Arboricultural Survey, Implications Assessment and Arboricultural Method Statement;
- There will be access to foot or vehicular traffic within fenced off areas once development (including demolition) has commenced;
- Once development (including demolition) has commenced the tree protection must not be moved for any reason without the written consent of the local planning authority;
- There will be no excavations, storage of materials, mixing of materials or dumping of spoil within construction exclusion zones (CEZ) unless agreed in writing with the local planning authority;
- All caustic substances e.g. oil, diesel, cement etc will not be stored within 2m of CEZs;
- No fires will be lit within 10m of CEZs or tree canopies;
- Protection area signage will be displayed on protective barriers for the duration of development;

PLEASE BE AWARE - The tree protection specified on this tree protection plan and within the Arboricultural Survey, Implications Assessment and Arboricultural Method Statement document are conditioned to be erected. Failure to protect trees in full accordance with the approved scheme is likely to result in local planning authority taking enforcement action, including prosecution.

Ground Protection

Specification for ply board ground protection

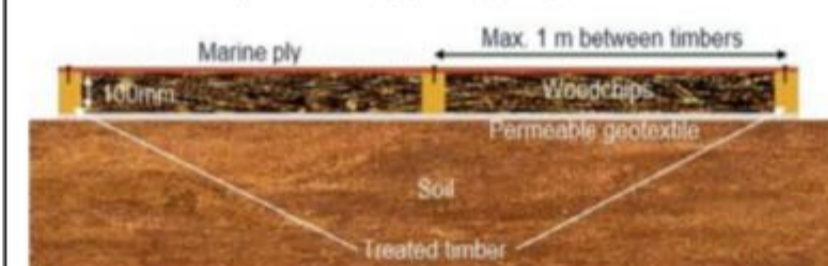

Plywood sheeting used as ground protection



Specification for scaffold ground protection.

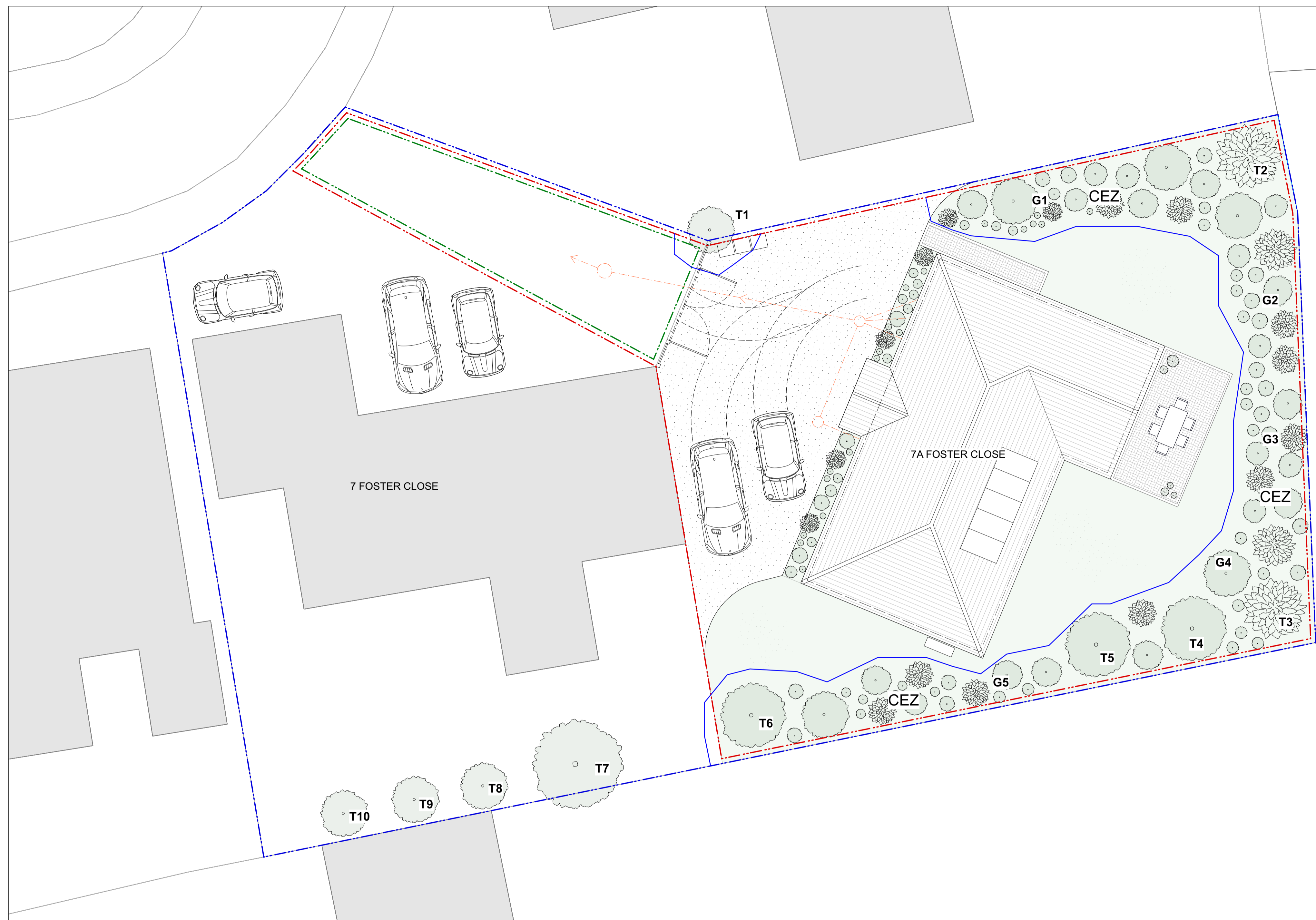

1 TREE PROTECTION PLAN

Scale: 1:100



- TREE KEY:
- T1: Sycamore
 - T2: Common Ash
 - T3: Maple (Acer)
 - T4: Maple (Acer)
 - T5: Fruit Tree (Apple)
 - T6: Fruit Tree (Apple)
 - T7: Hawthorn
 - T8: Fruit Tree (Plum)
 - T9: Fruit Tree (Plum)
 - T10: Fruit Tree (Plum)
- Tree Protection Fencing
 - Construction Exclusion Zone
 - ▨ Ground Protection

- G1: Mixed Ornamental Planting
- G2: Mixed Ornamental Planting
- G3: Mixed Ornamental Planting
- G4: Mixed Ornamental Planting
- G5: Mixed Ornamental Planting

- All dimensions to be checked on site.
- All drawings to be read in conjunction with Structural Engineer's or other consultants drawings. Any discrepancies between consultants drawings to be reported to the Architect before any work commences.
- All drawings for building regulations approval only. The Contractor's attention is drawn to the Health & Safety matters identified in the Health & Safety plan and on drawings as being potentially hazardous.
- These items should not be considered as a full and final list.
- The Work Package Contractor's normal Health & Safety obligations still apply when undertaking constructional operations both on and off site.

cad file:

Key

- ▭ SITE OWNERSHIP
- ▭ SITE BOUNDARY
- ▭ SHARED ACCESS
- ▭ EXISTING BUILDING

rev	date	initials	description
P1	31.01.24	CL	PLANNING
C	16.01.24	CL	DRAFT PLANNING
B	18.10.23	CL	Pre-Application Advice
A	11.10.23	CL	For Comment

drawing:
TREE PROTECTION PLAN

project:
LAND ADJACENT TO FOSTER CLOSE

drawing no: **0023-160** revision: **P1**

status:
PLANNING

scale @ A1/A3: **1:250 / 1:500** date: **OCTOBER 2023**

