

Proposed Site Plan (Condition 8)

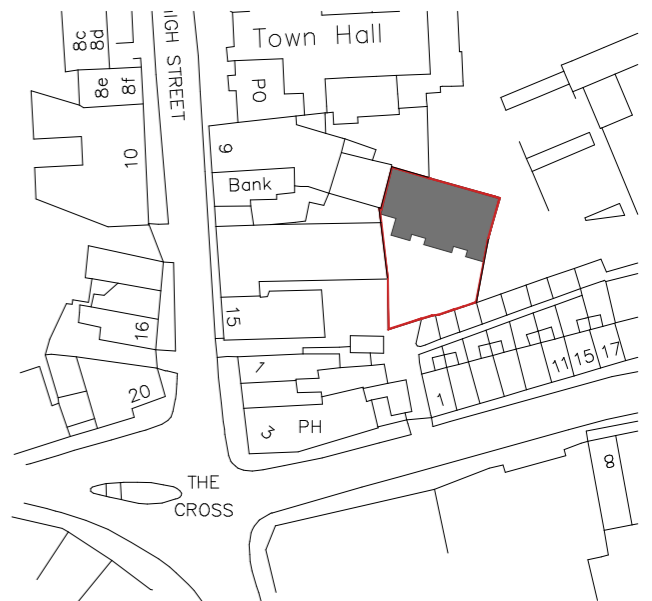

Location plan 1:1250

The original design copyright for the architectural design referenced herein belongs exclusively to EMC ARCHITECTS LIMITED. Evoke Architecture has solely provided technical design support and does not claim ownership of the original design.

REV	DATE	NOTES

PLANNING

CLIENT	
Mr Gareth Jones	
PROJECT	
Gittins Warehouse, Brook Street, Neston, CH64 9TY	
TITLE	SIZE
Proposed Site Plan (Condition 8)	A3
PROJECT No	DRAWING No
22-45	PL.005
DRAWN by	CHECKED
SM	PD
DATE	SCALE (u.n.o)
05/22	1:100

EVOKE ARCHITECTURE

35-37 High St
 Cheshire CH64 9TZ
 +44 (0)151 315 1112
 info@evokearchitecture.com
 evokearchitecture.com

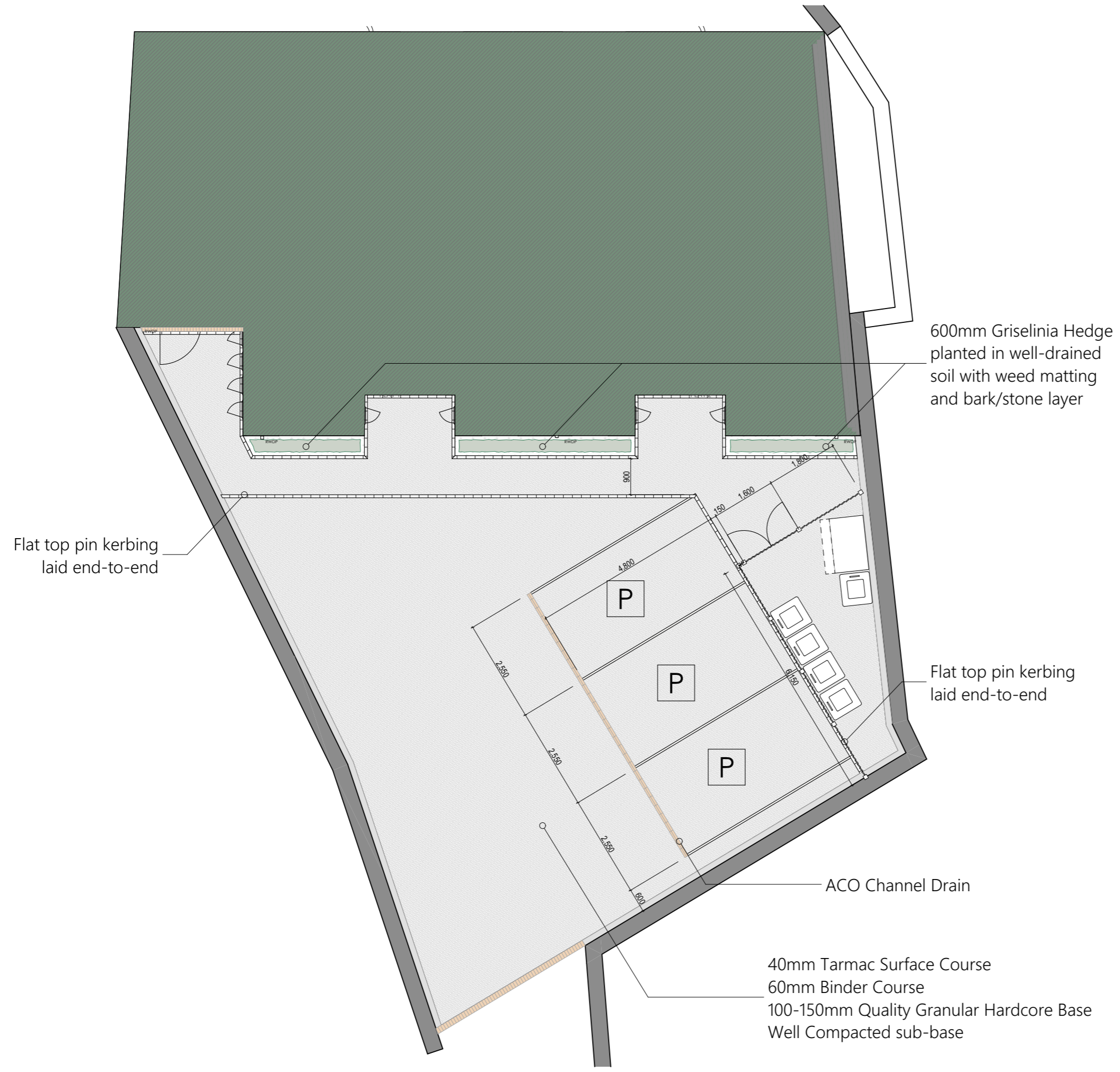

600mm Griselinia Hedge planted in well-drained soil with weed matting and bark/stone layer

Flat top pin kerbing laid end-to-end

Flat top pin kerbing laid end-to-end

ACO Channel Drain

40mm Tarmac Surface Course
 60mm Binder Course
 100-150mm Quality Granular Hardcore Base
 Well Compacted sub-base