

Existing site section

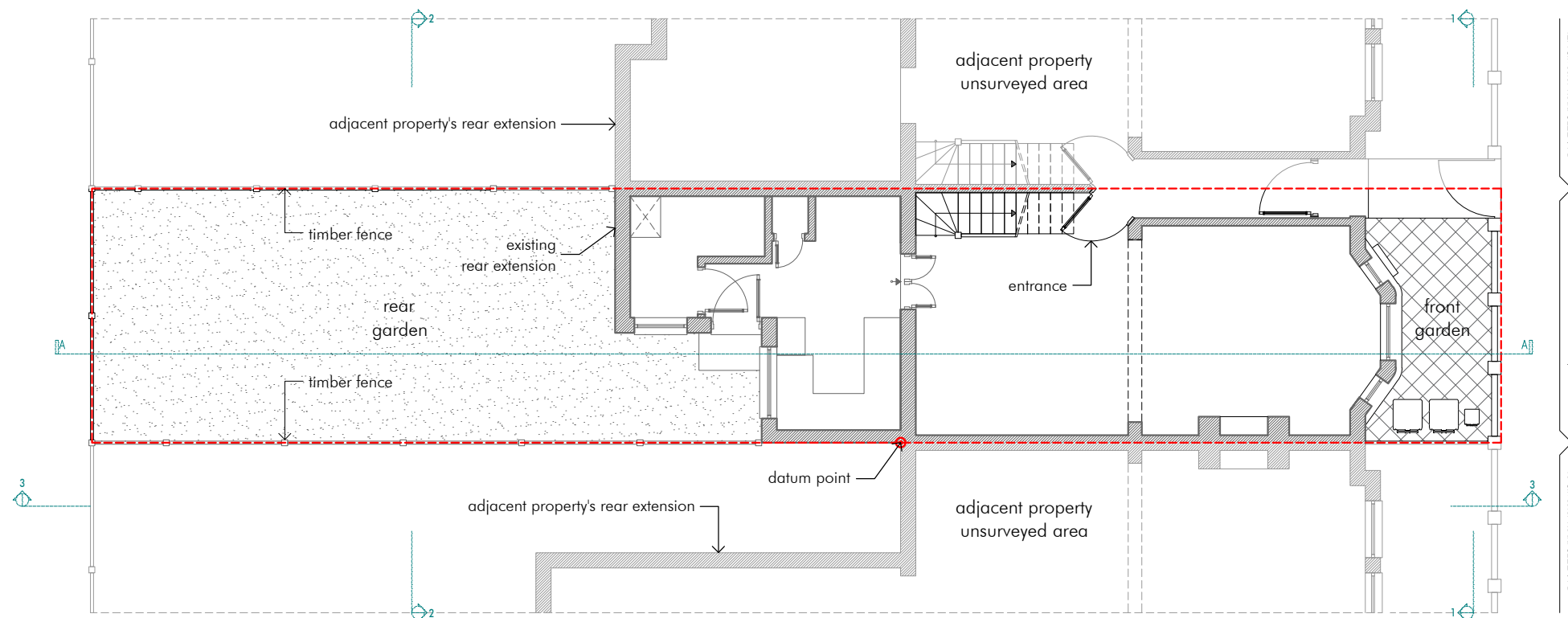

Existing site plan



## SIA Design Build

Studio 536, Salisbury House, London Wall  
 London, EC2M 5SQ  
 telephone: 07917206767  
 email: antonio@siadesignbuild.com  
 www.siadesignbuild.com

Client  
 Mrs Christie Hunter

Project address:  
 42 Silvester Road,  
 SE22 9PB, London, UK  
 Design commencement  
 October, 2023

Scale: 1:100@A3  
 Drawn: AK  
 Date: 24/12/23

Drawing name  
 GAEX-100-00

Drawing description  
 Existing site plan

### Issued for

client approval  
 planning  
 building regulation approval  
 tender  
 construction

### NOTES:

- SIA DESIGN BUILD RETAIN COPYRIGHT OF DESIGN, SCHEME & OWNERSHIP OF DRAWINGS.
- DRAWING SHOULD BE READ IN CONJUNCTION WITH STRUCTURAL ENG.'S DRAWINGS.
- ANY OMISSION TO BE REPORTED TO AND CLARIFIED WITH CLIENT PRIOR TO COMMENCEMENT.
- VERIFY DIMENSIONS, LEVELS AND EXISTING STRUCTURE, ETC ON SITE PRIOR TO COMMENCEMENT.
- ALL WORKS TO COMPLY WITH CURRENT REGULATIONS, BRITISH STANDARDS ETC.
- PLEASE NOTE THAT BEFORE BUILDING WORKS COMMENCES IT IS THE RESPONSIBILITY OF THE BUILDER OR OWNER TO SERVE PARTY WALL NOTICES TO ALL NEIGHBORS.
- INITIAL DRAWINGS SUBMITTED TO BUILDING CONTROL ARE SUBJECT TO ADDITIONAL INFORMATION REQUIRED BY BUILDING CONTROL /NHBC, WHICH COULD HAVE SIGNIFICANT COST/ OR ADDITIONAL WORKS TO BE DONE ON SITE.
- ALL WORKS COMMENCED ON SITE PRIOR TO OBTAINING FULL BUILDING CONTROL APPROVAL WILL BE CARRIED OUT AT YOUR OWN RISK.